

W.M. A. Sumner (From 1883 Plat)

W.M. A. Sumner

A-Copy This copy is reduced 6% from original

FILED  
NEWBERRY COUNTY  
CLERK OF COURT  
BURKE M. WISE  
Dec 22 3 58 PM '64

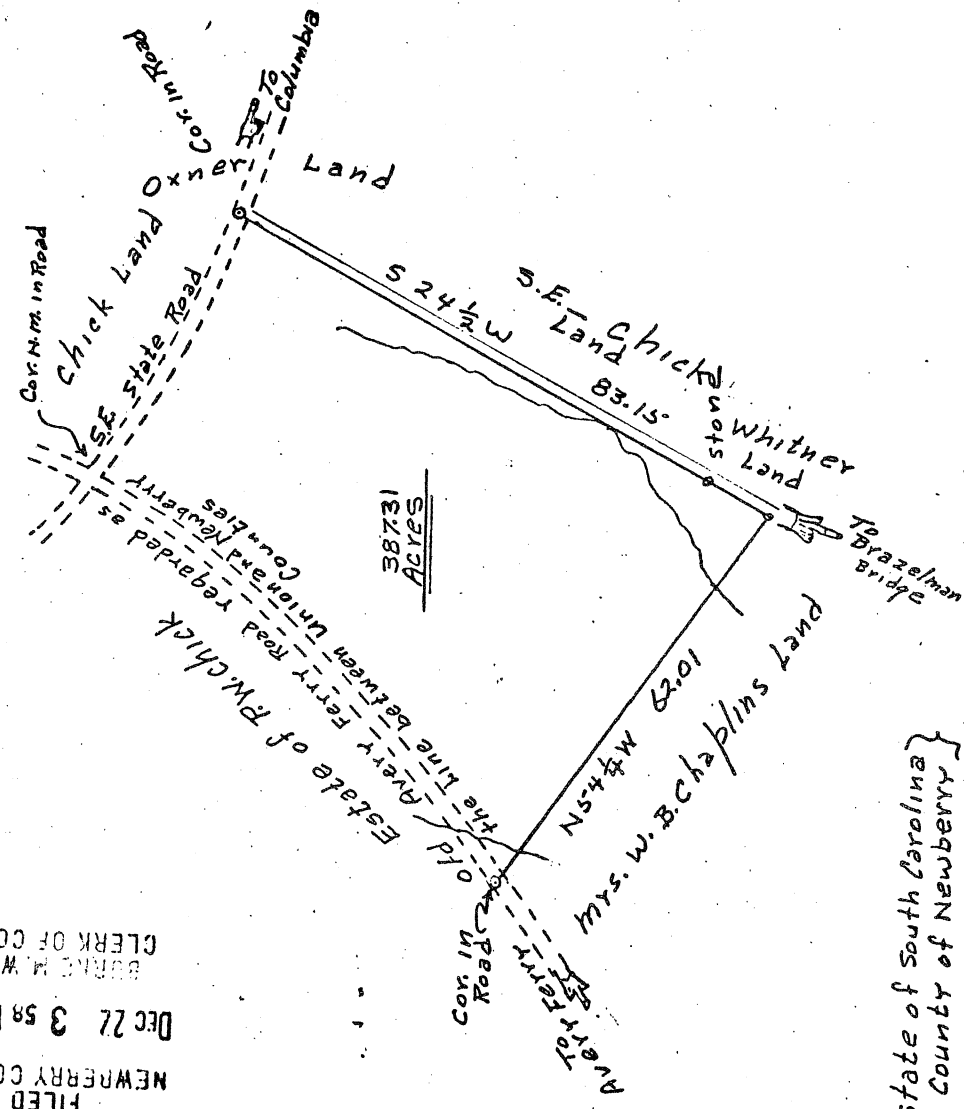

State of South Carolina }  
County of Newberry }

At the request of Joseph Caldwell, J.C.S. Brown, Thomas B. Chalmers, Thos. B. Kennerly and Albert Gibson Compu ne. 15(?) appointed by the court to set apart dower to Mrs. Sarah E. F. Chick, in the lands of which her late husband Pettus W. Chick died possessed and to divide the remaining lands into tracts or parcels for sale, I have surveyed that part of Pettus W. Chicks Home Place lying on the south west side of the State Road between Tyger and Enoree rivers in Marlinton Township in the county and state aforesaid and find it to contain three hundred eighty seven and thirty one hundredths acres and to have such form marks and boundaries as the above plat represents.

Surveyed Nov. 29th 1883

I certify that I have  
copied the above plat and  
information to the best  
of my ability from a  
dim photostatic copy

*Walter B. Hefner*  
Newberry SC  
Dec. 22, 1964

J. R. Renwick  
DEC 22 1964

Filed this \_\_\_\_\_  
Book U Page 75  
BY *Burke M. Wise*  
BURKE M. WISE  
Clerk of Court, Newberry Co., S. C.  
Deputy Clerk

