

PRELIMINARY

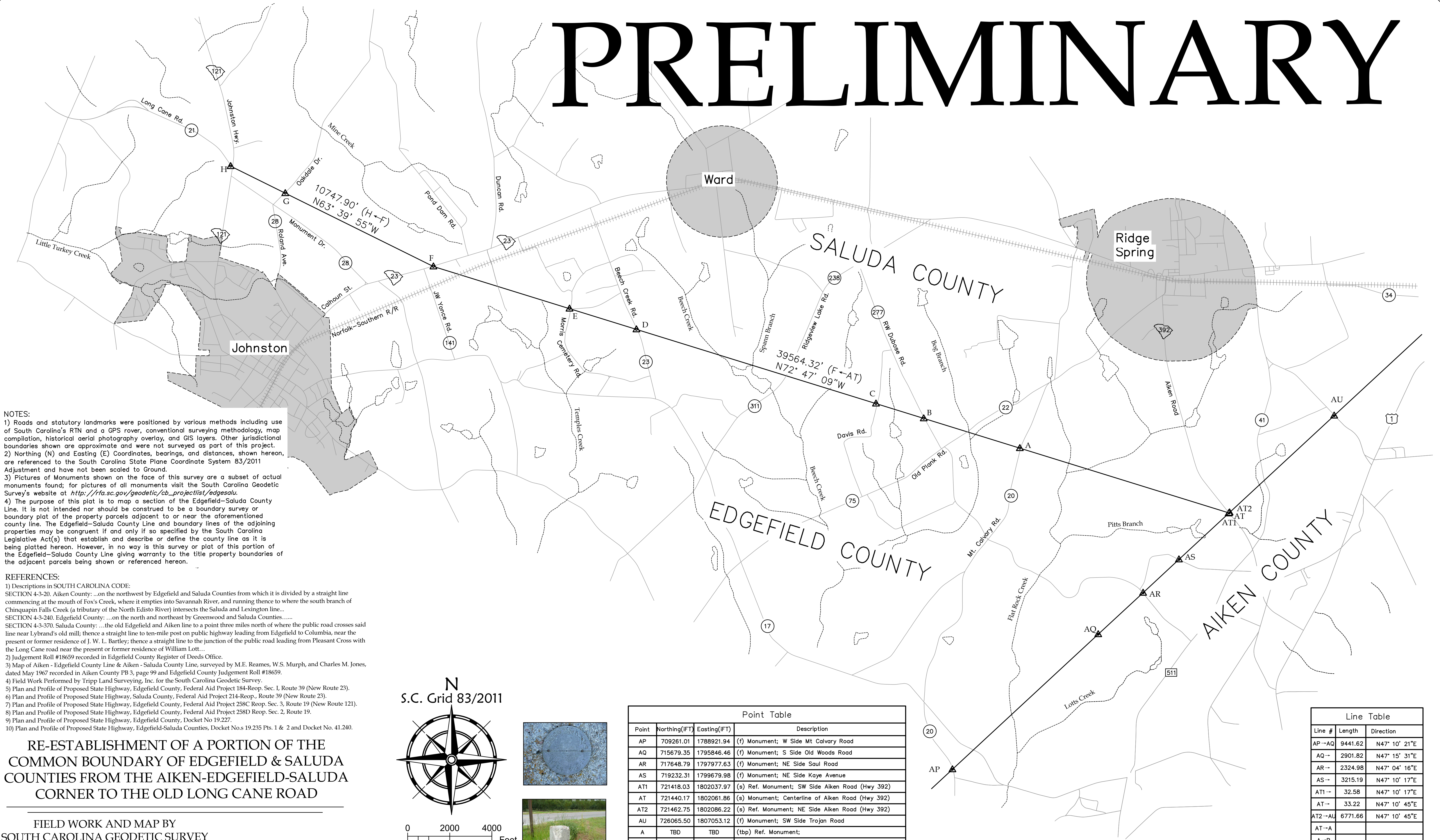

NOTES:
 1) Roads and statutory landmarks were positioned by various methods including use of South Carolina's RTN and a GPS rover, conventional surveying methodology, map compilation, historical aerial photography overlay, and GIS layers. Other jurisdictional boundaries shown are approximate and were not surveyed as part of this project.
 2) Northing (N) and Easting (E) Coordinates, bearings, and distances, shown hereon, are referenced to the South Carolina State Plane Coordinate System 83/2011 Adjustment and have not been scaled to Ground.
 3) Pictures of Monuments shown on the face of this survey are a subset of actual monuments found; for pictures of all monuments visit the South Carolina Geodetic Survey's website at http://rfa.sc.gov/geodetic/cb_projectlist/edgesalu.
 4) The purpose of this plat is to map a section of the Edgefield-Saluda County Line. It is not intended nor should be construed to be a boundary survey or boundary plat of the property parcels adjacent to or near the aforementioned county line. The Edgefield-Saluda County Line and boundary lines of the adjoining properties may be congruent if and only if so specified by the South Carolina Legislative Act(s) that establish and describe or define the county line as it is being platted hereon. However, in no way is this survey or plat of this portion of the Edgefield-Saluda County Line giving warranty to the title property boundaries of the adjacent parcels being shown or referenced hereon.

REFERENCES:
 1) Descriptions in SOUTH CAROLINA CODE:
 SECTION 4-3-20. Aiken County: ...on the northwest by Edgefield and Saluda Counties from which it is divided by a straight line commencing at the mouth of Fox's Creek, where it empties into Savannah River, and running thence to where the south branch of Chinquapin Falls Creek (a tributary of the North Edisto River) intersects the Saluda and Lexington line...
 SECTION 4-3-240. Edgefield County: ...on the north and northeast by Greenwood and Saluda Counties...
 SECTION 4-3-370. Saluda County: ...the old Edgefield and Aiken line to a point three miles north of where the public road crosses said line near Lybrand's old mill; thence a straight line to ten-mile post on public highway leading from Edgefield to Columbia, near the present or former residence of J. W. L. Bartley; thence a straight line to the junction of the public road leading from Pleasant Cross with the Long Cane road near the present or former residence of William Lott...
 2) Judgement Roll #18659 recorded in Edgefield County Register of Deeds Office.
 3) Map of Aiken - Edgefield County Line & Aiken - Saluda County Line, surveyed by M.E. Reames, W.S. Murph, and Charles M. Jones, dated May 1967 recorded in Aiken County PB 3, page 99 and Edgefield County Judgement Roll #18659.
 4) Field Work Performed by Tripp Land Surveying, Inc. for the South Carolina Geodetic Survey.
 5) Plan and Profile of Proposed State Highway, Edgefield County, Federal Aid Project 184-Reop, Sec. 1, Route 39 (New Route 23).
 6) Plan and Profile of Proposed State Highway, Saluda County, Federal Aid Project 214-Reop, Route 39 (New Route 23).
 7) Plan and Profile of Proposed State Highway, Edgefield County, Federal Aid Project 258C Reop, Sec. 3, Route 19 (New Route 121).
 8) Plan and Profile of Proposed State Highway, Edgefield County, Federal Aid Project 258D Reop, Sec. 2, Route 19.
 9) Plan and Profile of Proposed State Highway, Edgefield County, Docket No 19.227.
 10) Plan and Profile of Proposed State Highway, Edgefield-Saluda Counties, Docket Nos 19.235 Pts. 1 & 2 and Docket No. 41.240.

RE-ESTABLISHMENT OF A PORTION OF THE COMMON BOUNDARY OF EDGEFIELD & SALUDA COUNTIES FROM THE AIKEN-EDGEFIELD-SALUDA CORNER TO THE OLD LONG CANE ROAD

FIELD WORK AND MAP BY
 SOUTH CAROLINA GEODETIC SURVEY
 5 GEOLOGY ROAD
 COLUMBIA, SC 29212
 803.896.7700
<http://rfa.sc.gov/geodetic>

I hereby state that to the best of my professional knowledge, information, and belief, the survey shown hereon was made in accordance with the requirements of the Standards of Practice Manual for Surveying in South Carolina, and meets or exceeds the requirements for a Class B survey as specified therein.

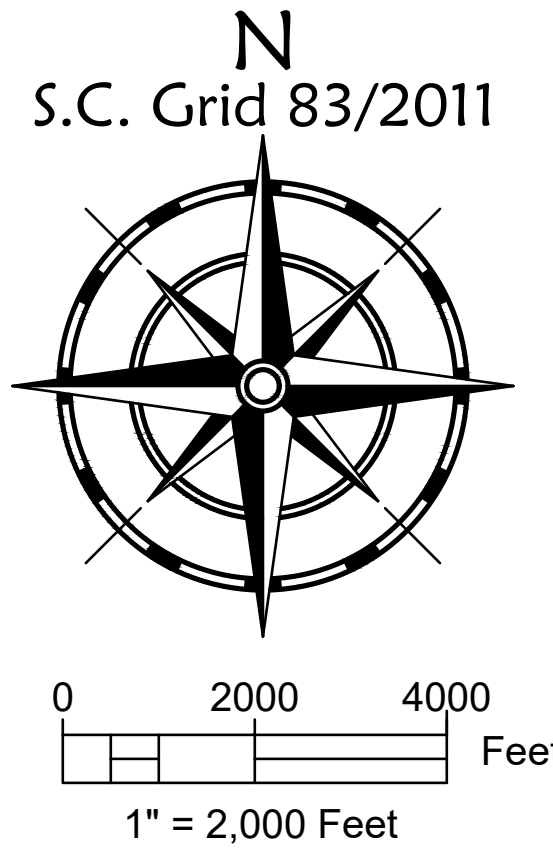

LEGEND

(f)	Found
(c)	Calculated
(s)	Set
▲	Monument
●	Point



Point Table			
Point	Northing(FT)	Easting(FT)	Description
AP	709261.01	1788921.94	(f) Monument; W Side Mt Calvary Road
AQ	715679.35	1795846.46	(f) Monument; S Side Old Woods Road
AR	717648.79	1797977.63	(f) Monument; NE Side Saul Road
AS	719232.31	1799679.98	(f) Monument; NE Side Kaye Avenue
AT1	721418.03	1802037.97	(s) Ref. Monument; SW Side Aiken Road (Hwy 392)
AT	721440.17	1802061.86	(s) Monument; Centerline of Aiken Road (Hwy 392)
AT2	721462.75	1802086.22	(s) Ref. Monument; NE Side Aiken Road (Hwy 392)
AU	726065.50	1807053.12	(f) Monument; SW Side Trojan Road
A	TBD	TBD	(tbp) Ref. Monument;
B	TBD	TBD	(tbp) Ref. Monument;
C	TBD	TBD	(tbp) Ref. Monument;
D	TBD	TBD	(tbp) Ref. Monument;
E	TBD	TBD	(tbp) Ref. Monument;
F	733149.00	1764269.81	(tbp) Monument; (10 Mile Post)
G	TBD	TBD	(tbp) Ref. Monument;
H	737916.92	1754637.36	(tbp) Monument; (Long Cane Road)

Line Table		
Line #	Length	Direction
AP-AQ	9441.62	N47° 10' 21"E
AQ--	2901.82	N47° 15' 31"E
AR--	2324.98	N47° 04' 16"E
AS--	3215.19	N47° 10' 17"E
AT1--	32.58	N47° 10' 17"E
AT--	33.22	N47° 10' 45"E
AT2-AU	6771.66	N47° 10' 45"E
AT-A		
A-B		
B-C		
C-D		
D-E		
E-F		
F-G		
G-H		

Date: TO BE DETERMINED
*Date Reflects Final Day of Field Work

PROF. LAND SURVEYOR NO. 26946
 DAVID K. BALLARD