

Scale, 3000 ft. per inch

Map of Troy School

District, containing $13\frac{1}{2}$ sq. miles. Survey completed for Co. Supt. of Education, T.E. Dorn, Oct. 12th, 1922, by J. F. Harling.

Bradley School Dist.

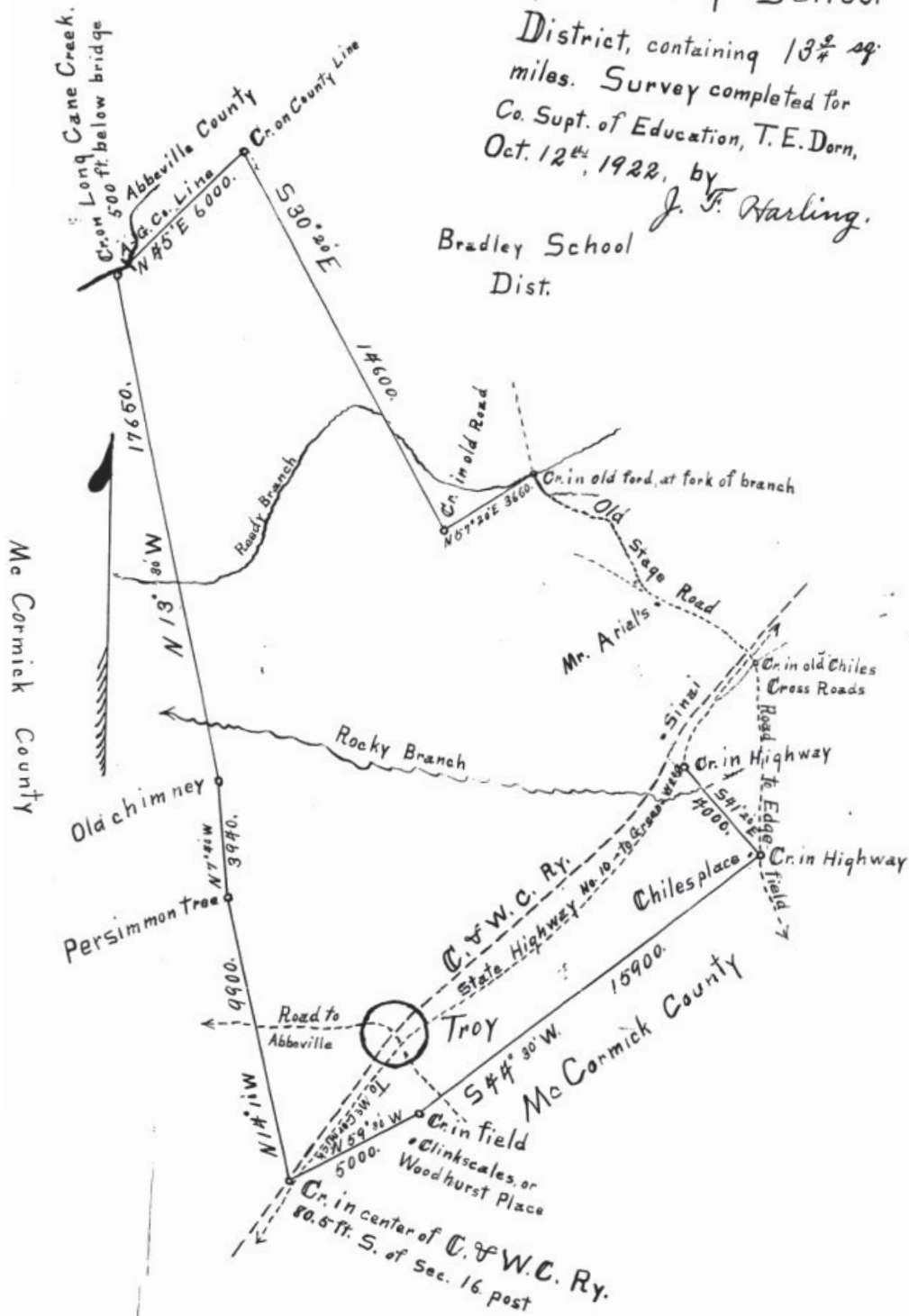

S. B. RAMBO
GREENWOOD, S. C.

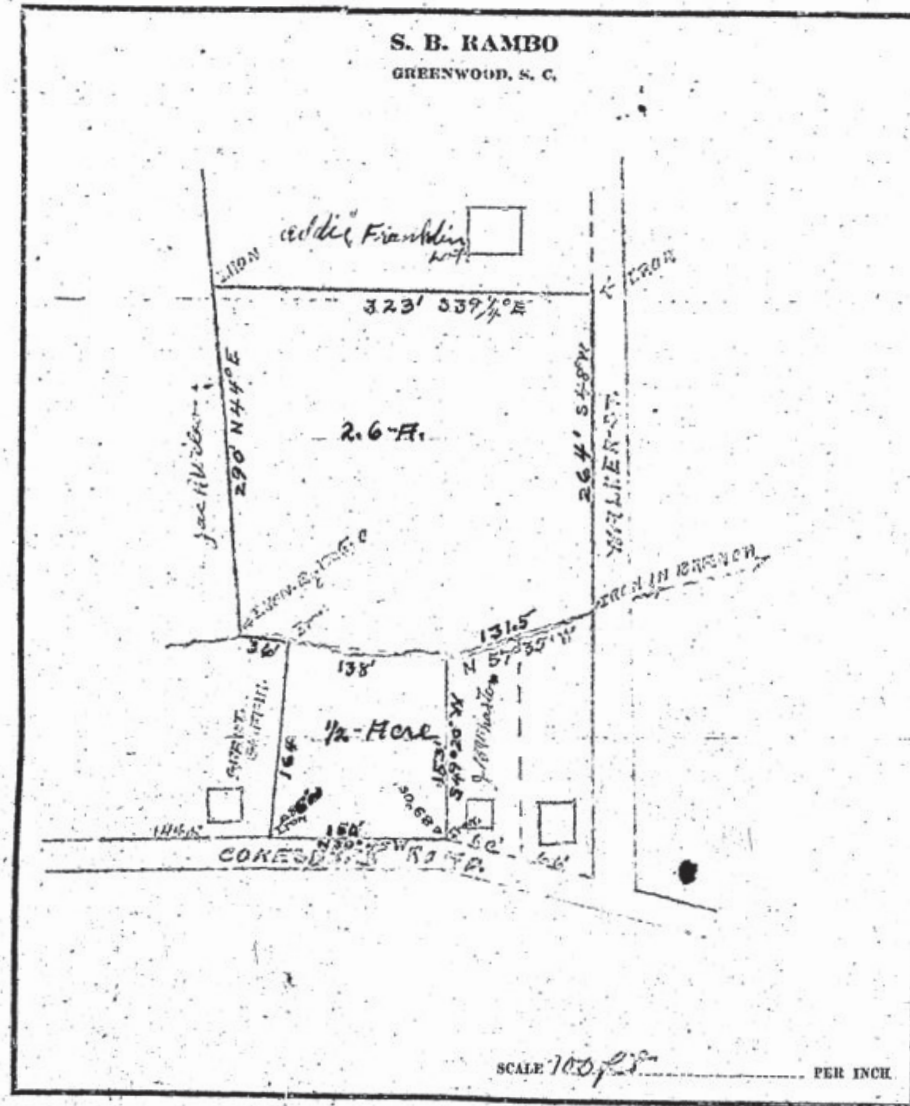

South Carolina

By request of James B. Rambo I have this day surveyed and subdivided a tract of land situated within the City limits of Greenwood known as the 2.6 acre tract

In the County and State above mentioned, and find it to contain (2.6) Troy subdivided into 4 lots Acres, and has such shape and boundaries as shown by the above plat.

Chain Surveyors
Carriers Surveyors

File No. _____

S. B. Rambo C. E.