

COUNTY CORNER TABLE
SC GRID NAD 83 (2011) EPOCH 2010.00
INTERNATIONAL FEET

CORNER	NORTH	EAST	LAT (N)	LONG (W)	DESCRIPTION
1	1121287.41	1786170.23	34°54'46.77017"	81°42'47.45531"	POINT IN PACOLET RIVER (SEE DETAIL 1)
2	1093782.46	1765182.70	34°50'13.23052"	81°46'56.94308"	POINT IN FAIRFOREST CREEK (SEE DETAIL 3)
3	1073477.83	1760337.03	34°46'52.03482"	81°47'53.18987"	SET #8 REBAR WITH DISK ON SOUTH SIDE OF SC HIGHWAY 215 (SEE DETAIL 5)
4	1035919.85	1753180.05	34°40'39.98740"	81°49'15.41090"	POINT IN HACKERS CREEK (SEE DETAIL 8)
5	1024541.05	1748234.61	34°38'47.04164"	81°50'13.52130"	SET MAG NAIL WITH WASHER IN SC HIGHWAY 49 (SEE DETAIL 9)
6	1005710.49	1742717.65	34°35'40.32932"	81°51'17.68945"	POINT ON THE NORTH BANK OF THE ENOREE RIVER (SEE DETAIL 10)
7	1005576.28	1742812.35	34°35'39.00954"	81°51'16.54332"	POINT IN ENOREE RIVER (SEE DETAIL 10)

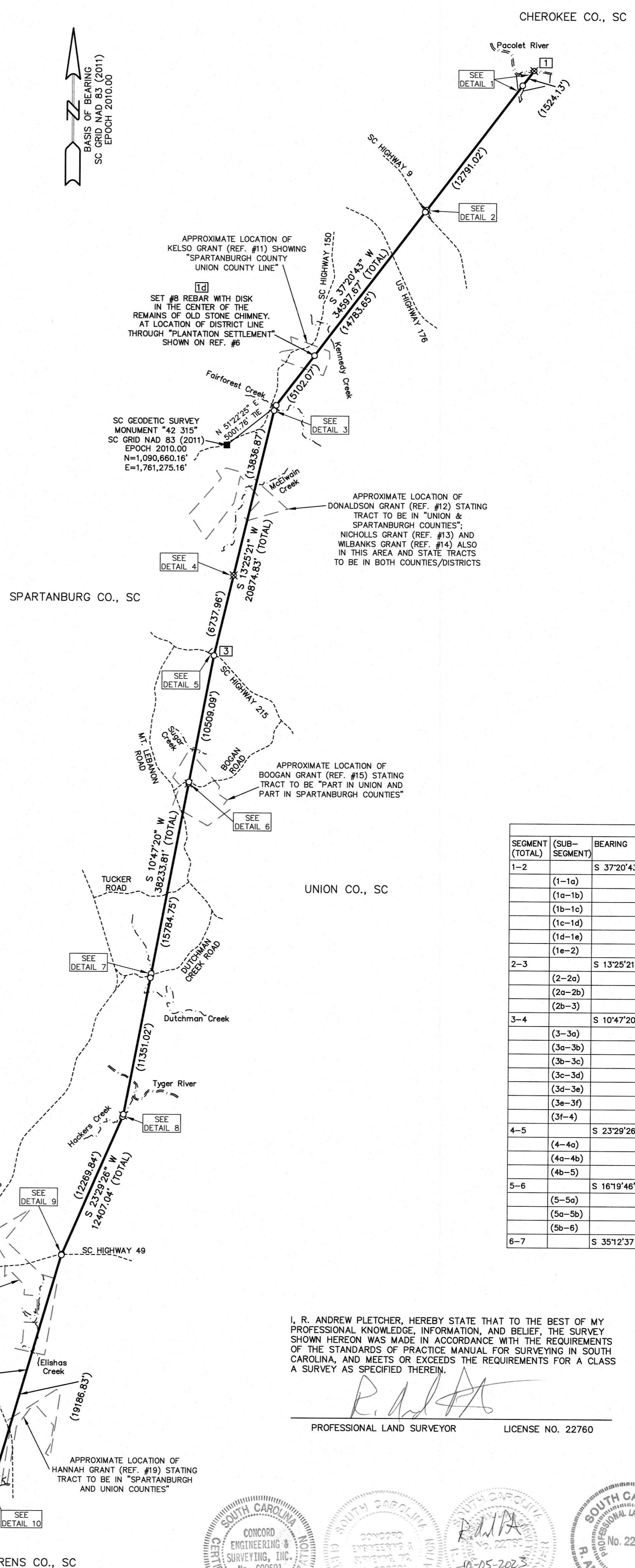

- NOTES:
- TRAVELERS ADJUSTED BY THE LEAST SQUARES ADJUSTMENT METHOD.
 - ALL DISTANCES ARE HORIZONTAL. GRID DISTANCES.
 - SC GRID NAD 83 (2011) EPOCH 2010.00 BASIS OF BEARING DERIVED FROM SCGS NETWORK RTK (HORIZONTAL POSITIONAL ACCURACY = 0.07") USING GEOID MODEL GEOID18. UNITS ARE INTERNATIONAL FEET.
 - THE FIELD SURVEY WAS COMPLETED ON 06-30-2022.

- REFERENCES:
- CODE OF LAWS OF SOUTH CAROLINA 1976; VOLUME 1A; CHAPTER 3 BOUNDARIES OF EXISTING COUNTIES; SEC. 4-3-480 SPARTANBURG COUNTY; SEC. 4-3-500 UNION COUNTY; SEC. 4-3-510 UNION COUNTY; BOUNDARIES OF TOWNSHIPS.
 - U.S. GEOLOGICAL SURVEY QUADRANGLE MAPS USED: SPARTANBURG, S. C.; N. C. 1953; SPARTANBURG, S. C. 1947; SPARTANBURG 1983; UNION WEST 1988; MOORE 1977; GLEN SPRINGS 1983; ENOREE 1983; CROSS ANCHOR 1983; ORA 1983; PHILSON CROSSROADS 1983; PACOLET 1983; PACOLET MILLS 1983; JONESVILLE 1983; SEDALIA 1983.
 - SOUTH CAROLINA DEPARTMENT OF NATURAL RESOURCES LIDAR DATA; SPARTANBURG COUNTY, 2013; UNION COUNTY, 2008.
 - MAP TITLED "UNION DISTRICT, SOUTH CAROLINA"; SURVEYED BY R. THOMPSON, 1820; IMPROVED FOR MILLS' ATLAS 1825.
 - MAP TITLED "SPARTANBURGH DISTRICT, SOUTH CAROLINA"; SURVEYED BY J. WHITTEN, 1820; IMPROVED FOR MILLS' ATLAS 1825.
 - MAP TITLED "MAP OF UNION DISTRICT"; (THE 1820 SURVEY REFERENCED ON 1825 MILLS ATLAS OF UNION DISTRICT; REFERENCE #4).
 - MAP TITLED "MAP OF SPARTANBURGH DISTRICT BY J. WHITTEN"; (THE 1820 SURVEY REFERENCED ON 1825 MILLS ATLAS OF SPARTANBURGH DISTRICT; REFERENCE #5).
 - MAP TITLED "MAP OF PROPOSED NEW COUNTY OUT OF PORTIONS OF SPARTANBURG AND LAURENS" BY THEOD. C. HAMBLY AND WILLIAM MARTIN; SURVEYED MAY 1913.
 - MAP OF THE COUNTY OF SPARTANBURG BY JOHN EPTON AND J. SLOAN; DATED FEBRUARY 22, 1869.
 - MAP TITLED "MAP OF CROSS ANCHOR SCHOOL DISTRICT NO. 15" BY CURTIS S. ANDERSON; SURVEYS MADE 1910-11.
 - MAP OF 150 ACRES FOR JOSEPH KELSO SURVEYED MAY 27, 1797.
 - MAP OF 403 ACRES FOR HUGH DONALDSON SURVEYED AUGUST 13, 1793.
 - MAP OF 427 ACRES FOR MARIA NICHOLLS SURVEYED JULY 12, 1793.
 - MAP OF 536 ACRES FOR DANIEL WILBANKS SURVEYED JANUARY 6, 1813.
 - MAP OF 361 ACRES FOR ISAAC BOOGAN SURVEYED FEBRUARY 11, 1795.
 - MAP OF 463 ACRES FOR TILLMAN BOBO SURVEYED OCTOBER 1, 1801.
 - MAP OF 505 ACRES FOR SAMPSON BOBO JUNIOR SURVEYED DECEMBER 21, 1801.
 - MAP OF 545 ACRES FOR SPENCER BOBO SURVEYED APRIL 16, 1802.
 - MAP OF 165 ACRES FOR ROBERT HANNAH SURVEYED JANUARY 15, 1794.
 - MAP TITLED "PROPERTY OF MRS. ANNIE O'NEIL PRITCHARD" BY THE HARWOOD BEEBE COMPANY; DATED MAY 31, 1933; TRACED FROM PLAT MADE BY J.F. SLOAN DATED AUGUST 1, 1888.
 - MAP TITLED "SUBDIVISION SURVEY IN THE MASTERS CROFT OF THE S.S. WOOD PLANTATION" BY H. STRIBLING; DATED NOV. 24, 1931; SPARTANBURG COUNTY MB. 11 PG. 106; UNION COUNTY MB. 10 PG. 118.
 - SPARTANBURG COUNTY DB. 8-0 POS. 290 AND 291; DATED APRIL 26, 1933.
 - MAP TITLED "PROPERTY OF J. Q. BOUGHMAN" BY JAMES R. McNABB; DATED MAY 8, 1952; UNION COUNTY MB. 7 PG. 66.
 - MAP SHOWING TWO TRACTS OF LAND COMBINED. NO. 1 SURVEYED BY JOHN D. YOUNG JAN. 29 1878. NO. 2 SURVEYED BY GLENN D. PEAKE JULY 1875 AND RESURVEYED BY JOHN D. YOUNG FEB. 24 1878.
 - MAP TITLED "SUBDIVISION SURVEY OF ALFALAWSON PROPERTY" BY DAN E. COLLINS; DATED JAN. 28, 1978; SPARTANBURG COUNTY MB. 81 PG. 340.
 - MAP OF SPARTANBURG RECEIVED FROM THE CAROLINIANA LIBRARY IN COLUMBIA, SC, DATED TO SOMETIME IN THE 1780s; TITLED "A REPRESENTATION OF THE COUNTY OF SPARTANBURGH".
 - UNTITLED MAP OF SPARTANBURG COUNTY RECEIVED FROM THE CAROLINIANA LIBRARY IN COLUMBIA, SC WITH AN ASSIGNED DATE OF 1791.

- LEGEND
- EXISTING CORNER AS DESCRIBED
 - SET CORNER AS DESCRIBED
 - ⊗ NO POINT SET
 - MB MAP BOOK
 - DB DEED BOOK
 - COUNTY CORNER DESIGNATION
 - POINT ON COUNTY LINE
 - COUNTY LINE AS SURVEYED
 - TIE LINE
 - BOUNDARY BY DEED OR MAP
 - APPROXIMATE ROAD
 - APPROXIMATE RIVER, CREEK OR BRANCH
 - APPROXIMATE LAND GRANT

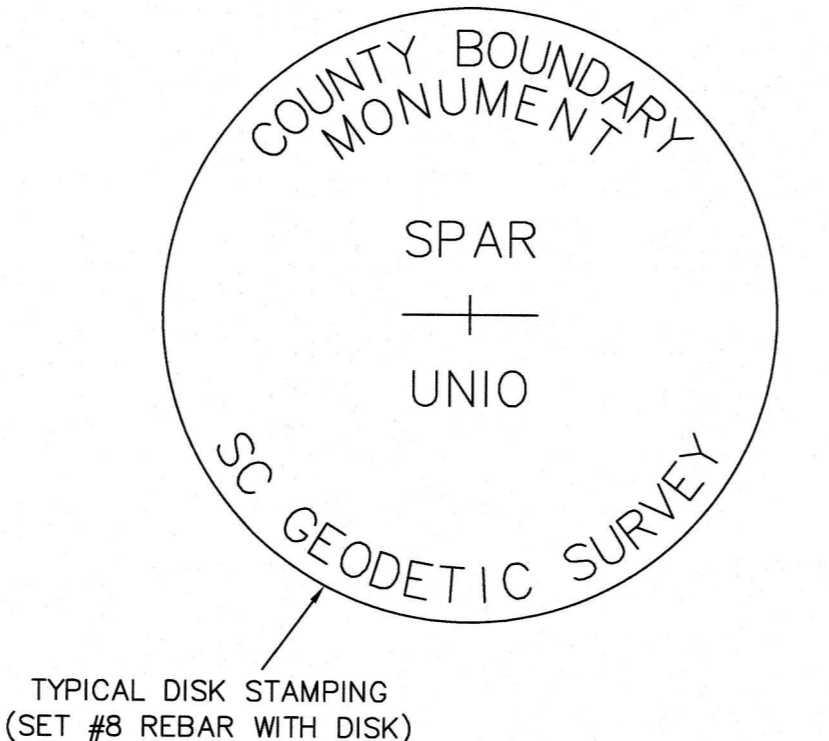
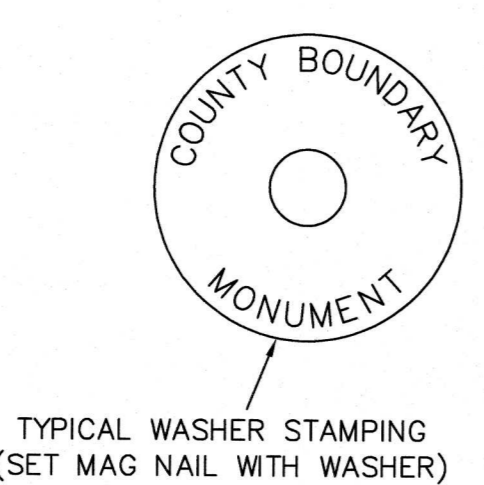

I, R. ANDREW PLETCHER, HEREBY STATE THAT TO THE BEST OF MY PROFESSIONAL KNOWLEDGE, INFORMATION, AND BELIEF, THE SURVEY SHOWN HEREON WAS MADE IN ACCORDANCE WITH THE REQUIREMENTS OF THE STANDARDS OF PRACTICE MANUAL FOR SURVEYING IN SOUTH CAROLINA, AND MEETS OR EXCEEDS THE REQUIREMENTS FOR A CLASS A SURVEY AS SPECIFIED THEREIN.

R. Andrew Pletcher
PROFESSIONAL LAND SURVEYOR LICENSE NO. 22760



Re-Establishment of the Spartanburg County and Union County Boundary from the Pacolet River South to the Enoree River
SPARTANBURG COUNTY, S.C.
UNION COUNTY, S.C.

SURVEY FOR:
SC GEODETIC SURVEY COUNTY BOUNDARY PROGRAM
1000 ASSEMBLY ST. REMBERT DENNIS BUILDING
COLUMBIA, SC 29201

DATE: 10-05-2023 COMPUTED BY: RAP
SCALE: 1" = 6000' DRAWN BY: RAP
JOB NO.: 210605.000 CHECKED BY: FAR
ACAD FILE: SCgrd2011.dwg

0 6000 12000 18000
SCALE IN FEET

CESI Civil - Geotechnical - Surveying
45 SPRING STREET SW CONCORD (704) 786-5404
CONCORD, NC 28025 FAX (704) 786-7454

S.C. CERTIFICATE OF AUTHORIZATION NO. C00591