

CORNER	NORTH	EAST	LAT (N)	LONG (W)	DESCRIPTION
1	1121287.41	1786170.23	34°54'46.77017"	81°42'47.45531"	POINT IN PACOLET RIVER (SEE DETAIL 1)
2	1093782.46	1765182.70	34°50'13.23052"	81°46'56.94308"	POINT IN FAIRFOREST CREEK (SEE DETAIL 3)
3	1073477.83	1760337.03	34°46'52.03482"	81°47'53.18987"	SET #8 REBAR WITH DISK ON SOUTH SIDE OF SC HIGHWAY 215 (SEE DETAIL 5)
4	1035919.85	1753180.05	34°40'39.98740"	81°49'15.41090"	POINT IN HACKERS CREEK (SEE DETAIL 8)
5	1024541.05	1748234.61	34°38'47.04164"	81°50'13.52130"	SET MAG NAIL WITH WASHER IN SC HIGHWAY 49 (SEE DETAIL 9)
6	1005710.49	1742117.65	34°35'40.32932"	81°51'17.68945"	POINT ON THE NORTH BANK OF THE ENOREE RIVER (SEE DETAIL 10)
7	1005576.28	1742812.35	34°35'39.00954"	81°51'16.54332"	POINT IN ENOREE RIVER (SEE DETAIL 10)

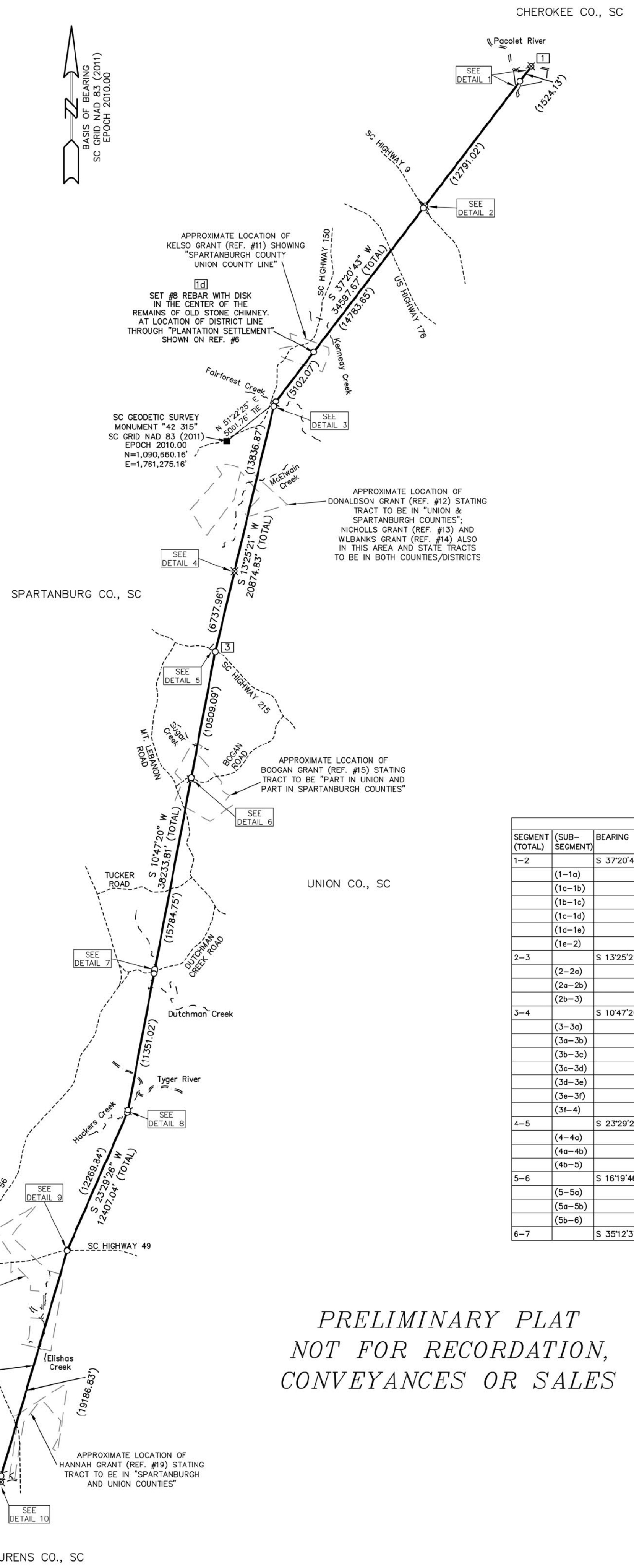

- NOTES:
1. TRAVERSES ADJUSTED BY THE LEAST SQUARES ADJUSTMENT METHOD.
 2. ALL DISTANCES ARE HORIZONTAL GRID DISTANCES.
 3. SC GRID NAD 83 (2011) EPOCH 2010.00 BASIS OF BEARING DERIVED FROM SCGS NETWORK RTK (HORIZONTAL POSITIONAL ACCURACY = 0.07') USING GEOID MODEL GEOID18. UNITS ARE INTERNATIONAL FEET.
 4. THE FIELD SURVEY WAS COMPLETED ON 04-26-2022.

- REFERENCES:
1. CODE OF LAWS OF SOUTH CAROLINA 1976; VOLUME 1A; CHAPTER 3 BOUNDARIES OF EXISTING COUNTIES; SEC. 4-3-480 SPARTANBURG COUNTY; SEC. 4-3-500 UNION COUNTY; SEC. 4-3-510 UNION COUNTY; BOUNDARIES OF TOWNSHIPS.
 2. U.S. GEOLOGICAL SURVEY QUADRANGLE MAPS USED: SPARTANBURG, S. C.; N. C. 1953; SPARTANBURG, S. C. 1947; SPARTANBURG 1983; UNION WEST 1969; MOORE 1977; GLENN SPRINGS 1983; ENOREE 1983; CROSS ANCHOR 1983; ORA 1983; PHILSON CROSSROADS 1983; PACOLET 1983; PACOLET MILLS 1983; JONESVILLE 1983; SEDALIA 1983.
 3. SOUTH CAROLINA DEPARTMENT OF NATURAL RESOURCES LIDAR DATA; SPARTANBURG COUNTY, 2013; UNION COUNTY, 2008.
 4. MAP TITLED "UNION DISTRICT, SOUTH CAROLINA"; SURVEYED BY R. THOMPSON, 1820; IMPROVED FOR MILLS' ATLAS 1825.
 5. MAP TITLED "SPARTANBURGH DISTRICT, SOUTH CAROLINA"; SURVEYED BY J. WHITTEN, 1820; IMPROVED FOR MILLS' ATLAS 1825.
 6. MAP TITLED "MAP OF UNION DISTRICT". (THE 1820 SURVEY REFERENCED ON 1825 MILLS ATLAS OF UNION DISTRICT; REFERENCE #4).
 7. MAP TITLED "MAP OF SPARTANBURGH DISTRICT BY J. WHITTEN". (THE 1820 SURVEY REFERENCED ON 1825 MILLS ATLAS OF SPARTANBURGH DISTRICT; REFERENCE #5).
 8. MAP TITLED "MAP OF PROPOSED NEW COUNTY OUT OF PORTIONS OF SPARTANBURG AND LAURENS" BY THEOD. C. HAMBY AND WILLIAM MARTIN; SURVEYED MAY 1913.
 9. MAP OF THE COUNTY OF SPARTANBURG BY JOHN EPTON AND J. SLOAN; DATED FEBRUARY 22, 1869.
 10. MAP TITLED "MAP OF CROSS ANCHOR SCHOOL DISTRICT NO. 15" BY CURTIS S. ANDERSON; SURVEY MADE 1910-11.
 11. MAP OF 150 ACRES FOR JOSEPH KELSO SURVEYED MAY 27, 1797.
 12. MAP OF 403 ACRES FOR HUGH DONALDSON SURVEYED AUGUST 13, 1793.
 13. MAP OF 427 ACRES FOR MARIA NICHOLLS SURVEYED JULY 12, 1793.
 14. MAP OF 536 ACRES FOR DANIEL MILBANKS SURVEYED JANUARY 6, 1813.
 15. MAP OF 361 ACRES FOR ISAAC BOOGAN SURVEYED FEBRUARY 11, 1795.
 16. MAP OF 463 ACRES FOR TILLMAN BOBO SURVEYED OCTOBER 1, 1801.
 17. MAP OF 505 ACRES FOR SAMPSON BOBO JUNIOR SURVEYED DECEMBER 21, 1801.
 18. MAP OF 545 ACRES FOR SPENCER BOBO SURVEYED APRIL 16, 1802.
 19. MAP OF 165 ACRES FOR ROBERT HANNAH SURVEYED JANUARY 15, 1794.
 20. MAP TITLED "PROPERTY OF MRS. ANNIE O'NEIL PRITCHARD" BY THE HARWOOD BEEBE COMPANY; DATED MAY 31, 1933; TRACED FROM PLAT MADE BY J.F. SLOAN DATED AUGUST 1, 1888.
 21. MAP TITLED "SUBDIVISION SURVEY OF THE MASTERS CORNER OF THE S.S. WOOD PLANTATION" BY H. STRIBLING; DATED NOV. 24, 1937; SPARTANBURG COUNTY MB. 11 PG. 106; UNION COUNTY MB. 10 PG. 118.
 22. SPARTANBURG COUNTY DB. 8-0 PGS. 290 AND 291; DATED APRIL 26, 1933.
 23. MAP TITLED "PROPERTY OF J. Q. BOUGHMAN" BY JAMES R. McNABB; DATED MAY 8, 1952; UNION COUNTY MB. 7 PG. 66.
 24. MAP SHOWING TWO TRACTS OF LAND COMBINED. NO. 1 SURVEYED BY JOHN D. YOUNG JAN. 29 1878. NO. 2 SURVEYED BY GLENN D. PEAKE JULY 1875 AND RESURVEYED BY JOHN D. YOUNG FEB. 24 1878.
 25. MAP TITLED "SUBDIVISION SURVEY OF ALFRED LAWSON PROPERTY" BY DAN E. COLLINS; DATED JAN. 28, 1978; SPARTANBURG COUNTY MB. 81 PG. 340.
 26. MAP OF SPARTANBURG RECEIVED FROM THE CAROLINIANA LIBRARY IN COLUMBIA, SC, DATED TO SOMETIME IN THE 1780s, TITLED "A REPRESENTATION OF THE COUNTY OF SPARTANBURGH".
 27. UNTITLED MAP OF SPARTANBURG COUNTY RECEIVED FROM THE CAROLINIANA LIBRARY IN COLUMBIA, SC WITH AN ASSIGNED DATE OF 1791.

SEGMENT (TOTAL)	(SUB-SEGMENT)	BEARING	DISTANCE (GRID)	CORNER OR POINT ON LINE
1-2	(1-1a)	S 37°20'43" W	34597.67' (TOTAL)	1 - POINT IN PACOLET RIVER (SEE DETAIL 1)
	(1a-1b)	(1524.13')		1a - SET #8 REBAR WITH DISK (SEE DETAIL 1)
	(1b-1c)	(12791.02')		1b - POINT (SEE DETAIL 2)
	(1c-1d)	(221.80')		1c - SET MAG NAIL WITH WASHER IN SC HIGHWAY 9 (SEE DETAIL 2)
	(1d-1e)	(14783.85')		1d - SET #8 REBAR WITH DISK (IN REMAINS OF OLD STONE CHIMNEY)
	(1e-1f)	(9102.07')		1e - SET #8 REBAR WITH DISK (SEE DETAIL 3)
	(1f-2)	(175.00')		2 - POINT IN FAIRFOREST CREEK (SEE DETAIL 3)
	2-3	(2-2a)	S 13°25'21" W	20874.83' (TOTAL)
(2a-2b)		(300.00')		2b - POINT (SEE DETAIL 4)
(2b-3)		(13836.87')		3 - SET #8 REBAR WITH DISK (SEE DETAIL 5)
3-4	(3-3a)	S 10°47'20" W	38233.81' (TOTAL)	3a - SET MAG NAIL WITH WASHER IN BOGAN ROAD (SEE DETAIL 6)
	(3a-3b)	(10509.09')		3b - POINT (SEE DETAIL 6)
	(3b-3c)	(138.95')		3c - SET #8 REBAR WITH DISK (SEE DETAIL 7)
	(3c-3d)	(15784.75')		3d - SET MAG NAIL WITH WASHER (SEE DETAIL 7)
	(3d-3e)	(225.00')		3e - SET #8 REBAR WITH DISK (SEE DETAIL 7)
	(3e-3f)	(11351.02')		3f - SET #8 REBAR WITH DISK (SEE DETAIL 8)
	(3f-4)	(100.00')		4 - POINT IN HACKERS CREEK (SEE DETAIL 8)
	4-5	(4-4a)	S 23°28'28" W	12407.04' (TOTAL)
(4a-4b)		(100.00')		4b - SET #8 REBAR WITH DISK (SEE DETAIL 9)
(4b-5)		(12289.84')		5 - SET MAG NAIL WITH WASHER IN SC HIGHWAY 49 (SEE DETAIL 9)
(4c-5)		(37.20')		
(4d-5)		(19186.83')		
5-6	(5-5a)	S 16°19'46" W	19822.10' (TOTAL)	5a - SET #8 REBAR WITH DISK (SEE DETAIL 9)
	(5a-5b)	(35.27')		5b - SET #8 REBAR WITH DISK (SEE DETAIL 10)
	(5b-6)	(400.00')		6 - POINT ON THE NORTH BANK OF THE ENOREE R. (SEE DETAIL 10)
6-7		S 35°12'37" E	164.26'	7 - POINT IN ENOREE RIVER (SEE DETAIL 10)

PRELIMINARY PLAT
NOT FOR RECORDATION,
CONVEYANCES OR SALES

Re-Establishment of the Spartanburg County and Union County Boundary from the Pacolet River South to the Enoree River
SPARTANBURG COUNTY, S.C.
UNION COUNTY, S.C.

SURVEY FOR:
SOUTH CAROLINA GEODETIC SURVEY
5 GEOLOGY ROAD
COLUMBIA, SC 29212
DATE: 07-05-2022
SCALE: 1" = 600'
JOB NO.: 210605.000
ACAD FILE: SGrid2011.dwg
COMPUTED BY: RAP
DRAWN BY: RAP
CHECKED BY: FAR

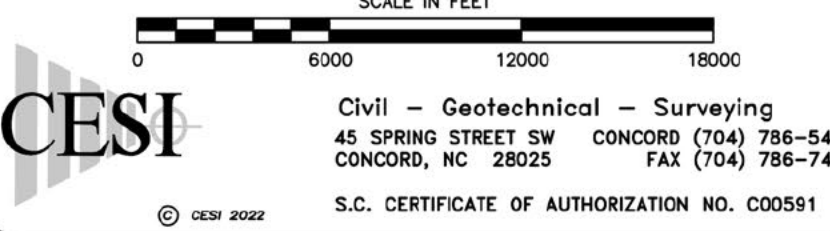

LEGEND

- EXISTING CORNER AS DESCRIBED
- SET CORNER AS DESCRIBED
- ⊗ NO POINT SET
- MB. MAP BOOK
- DB. DEED BOOK
- COUNTY CORNER DESIGNATION
- POINT ON COUNTY LINE
- COUNTY LINE AS SURVEYED
- - - TIE LINE
- - - BOUNDARY BY DEED OR MAP
- - - APPROXIMATE ROAD
- - - APPROXIMATE RIVER, CREEK OR BRANCH
- - - APPROXIMATE LAND GRANT

