

Point Table			
Point #	Northing(IFT)	Easting(IFT)	Description
A	881757.83	2440454.47	Point on Old Causeway
B	881782.80	2440528.33	Concrete Monument (f) Dillon/Marion
C	883150.85	2444574.45	Concrete Monument (f) Dillon/Marion
D	883302.01	2445021.51	Intersection of Gum Swamp and Cud Swamp
E	892662.49	2456316.05	Intersection Northern R/W and Cud Swamp
F	892650.56	2456354.76	Concrete Monument (f) Dillon/Marion
G	892613.87	2456763.09	1" Rebar w/ Cap (s)
H	892650.21	2456979.45	1" Rebar w/ Cap (s)
I	892727.46	2457412.85	Mag Nail with Washer (s)
J	892862.19	2458191.14	1" Rebar w/ Cap (s)
K	892935.10	2458591.09	1" Rebar w/ Cap (s)
L	892973.50	2458789.90	1" Rebar w/ Cap (s)
M	893067.59	2459332.63	1" Rebar w/ Cap (s)

Point Table			
Point #	Northing(IFT)	Easting(IFT)	Description
N	893105.07	2459605.17	1" Rebar w/ Cap (s)
O	896494.57	2458868.04	1" Rebar w/ Cap (s)
P	896680.15	2460964.85	1" Rebar w/ Cap (s)
Q	897524.76	2461998.71	1" Rebar w/ Cap (s)
R	896957.04	2462949.06	1" Rebar w/ Cap (s)
S	899096.71	2474725.57	Concrete Monument (f) Dillon/Marion
T	901210.54	2479777.33	3/4" Pipe (f)
U	901311.61	2482148.25	Concrete Monument (f) Dillon/Marion
V	901526.85	2489076.75	Concrete Monument (f) Dillon/Marion
W	899924.96	2493728.87	1" Rebar w/ Cap (s)
X	894507.18	2504115.96	Concrete Monument (f) Dillon/Marion
Y	890504.72	2511990.95	Concrete Monument (f) Dillon/Marion (Disturbed) 1" Rebar w/ Cap (s)
Z	891249.64	2512847.04	1" Rebar w/ Cap (s)

Point Table			
Point #	Northing(IFT)	Easting(IFT)	Description
AA	893045.32	2514914.20	Calculated Point
AB	893346.80	2515260.86	Intersection of Alt. Hwy 41 Eastern R/W and Buck Swamp
AC	885942.26	2539526.84	Intersection of Buck Swamp and Little Pee Dee River
AD	885904.48	2539623.03	<Reference Mark> Concrete Monument (f) Dillon/Marion
AE	897845.70	2551644.14	1" Rebar w/ Cap (s)
AF	885592.42	2565431.19	<Reference Mark> 2" Pipe (f) @ Original Conc. Mon Position
AG	885650.78	2565516.88	Intersection of Ashpole Swamp and Lumber River

Line Table		
Line	Length	Direction
E → F	40.50'	S72° 51' 25.5"E
G → H	219.40'	N80° 28' 02.2"E
H → I	440.22'	N79° 53' 37.3"E
I → J	789.87'	N80° 10' 43.9"E
J → K	406.54'	N79° 40' 03.9"E
K → L	202.48'	N79° 04' 09.5"E
L → M	550.83'	N80° 09' 51.6"E
M → N	275.11'	N82° 10' 11.0"E
P → Q	1335.00'	N50° 45' 11.0"E
Q → R	1107.00'	S59° 08' 49.0"E
T → U	2373.08'	N87° 33' 32.7"E
Y → Z	1134.80'	N48° 58' 20.1"E
Z → AA	2738.18'	N49° 01' 12.5"E
AA → AB	459.41'	N48° 59' 14.5"E

Curve Table				
Curve #	Length	Radius	Delta	Chord Direction
F → G	413.45'	918.76'	25.78'	S84° 52' 00"E

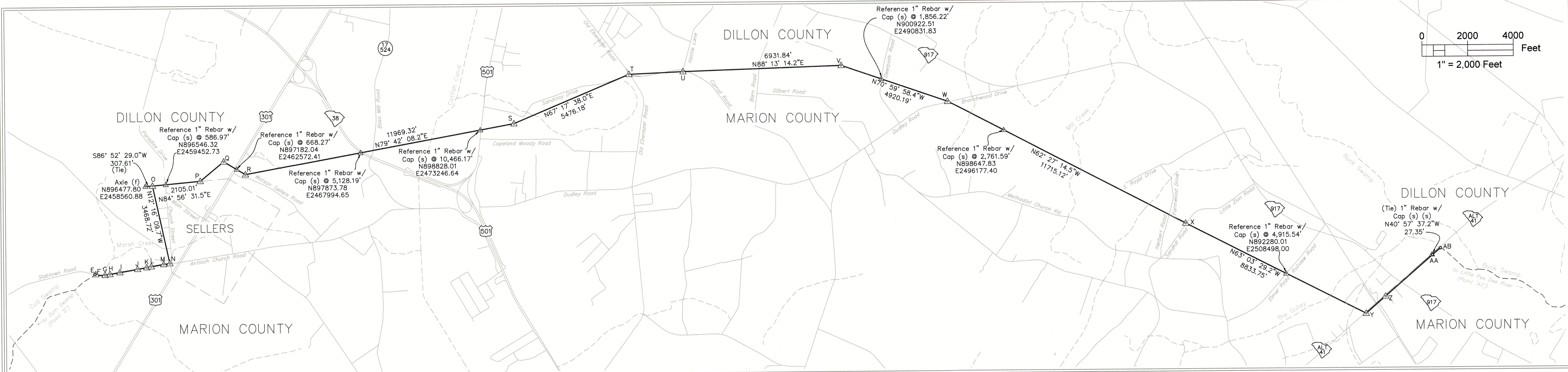

**NOTES:**

- 1) Roads and statutory landmarks were positioned by various methods including use of South Carolina's RTN and a GPS rover, conventional surveying methodology, map compilation, historical aerial photography overlay, and GIS layers. Other jurisdictional boundaries shown are approximate and were not surveyed as part of this project.
- 2) Northing (N) and Easting (E) Coordinates, bearings, and distances, shown hereon, are referenced to the South Carolina State Plane Coordinate System 83/2011 Realization and have not been scaled to Ground.
- 3) For more information visit the South Carolina Geodetic Survey's website at <https://rfa.sc.gov/programs-services/geodetic/county>
- 4) The purpose of this plat is to map a section of the Dillon-Marion County Line. It is not intended nor should it be construed to be a boundary survey or boundary plat of the property parcels adjacent to or near the aforementioned county line. The Dillon-Marion County Line and boundary lines of the adjoining properties may be congruent if and only if so specified by the South Carolina Legislative Act(s) that establish and describe or define the county line as it is being platted hereon. However, in no way is this survey or plat of this portion of the Dillon-Marion County Line giving warranty to the title property boundaries of the adjacent parcels being shown or referenced hereon.

**REFERENCES:**

- 1) Descriptions in SOUTH CAROLINA CODE: SECTION 4-3-180. Dillon County: ...beginning at the mouth of Mill Creek where it empties into Big Pee Dee River and in middle of said river at said point; thence up the run of said creek to the bridge on the river road to a stake X 111 N.; thence N. 75° 56' E. 4,395 feet to a stake X 111 N.; at the intersection of Gum Swamp and Cud Swamp; thence up the run of Cud Swamp to the public road leading from L. D. Haselden's to Sellers, to a stake near bridge; thence N. 82° 47' E. 3,061 feet along said road to the town limits of Seller's to a stake; thence N. 10° 26' W. 3,496.5 feet to a stake X; thence N. 87° 43' E. 2,100 feet to a stake X; thence N. 53° 22' E. 1,335 feet to a stake X; thence S. 56° 32' E. 1,107 feet to a stake X; thence N. 82° 30' E. 11,801 feet to a stake; thence N. 69° 40' E. 5,678 feet to an iron stake west side of the Marion and Latta public road near the property now formerly owned by David Watson; thence N. 88° 30' E. 2,305 feet to an iron stake of the public highway leading from Latta towards Marion, South Carolina, on the old Bryant place, the said roads being the ones heretofore referred to in the original petition setting forth the boundary lines of the proposed new county; thence S. 89° 10' E. 6,940 feet to a stake X; thence S. 68° 72' E. 4,920 feet to a stake X; thence S. 60° 10' E. 20,545 feet to a stake X at east side of railroad; thence N. 51° 37' E. 4,242 feet to its intersection with Buck Swamp; thence down the run of Buck Swamp with its various courses and distances to its junction with Little Pee Dee River; thence a straight line N. 48° 40' E. 17,300 feet to a stake X 111 N.; thence a straight line S. 44° 48' E. 18,924 feet to a cypress tree X 3 N. at the junction of Ash Pole Swamp and Lumber River...
- 2) MAP OF MARION COUNTY SHOWING PROPOSED NEW COUNTY, SURVEYED BY THEOD. C. HAMBY AND E.N. BEATY, DATED MARCH OF 1909; FILED WITH THE SOUTH CAROLINA DEPARTMENT OF ARCHIVES AND HISTORY (MAP CASE 01-07-01a)
- 3) MAP SHOWING THE LINES BOUNDING THE COUNTY OF PEE DEE, SURVEYED OCTOBER & NOVEMBER 1898 BY S. REDD STONEY; REVISED AUGUST 1901 BY R.L. FREEMAN; REVISED JULY AND AUGUST OF 1906 BY J.T. WARDLAW; BEING COPIED FROM THE ORIGINAL BY J.T. WARDLAW DECEMBER 27, 1906. FILED WITH THE SOUTH CAROLINA DEPARTMENT OF ARCHIVES AND HISTORY (MAP CASE 01-03-01a)
- 4) PLAT OF A TRACT OF LAND OWNED BY ANNIE GRACE SELLERS GADDY, BY C.O. EPPS, DATED FEBRUARY 17, 1956 AND RECORDED IN DILLON COUNTY IN PLAT BOOK 6, PAGE 145.
- 5) SURVEY OF BEN PAGE LAND, BY PHILLIP B. CULBRETH, DATED APRIL 1998 AND RECORDED IN DILLON COUNTY IN PLAT BOOK 27, PAGE 78.
- 6) SUBDIVISION SURVEY FOR ANDREW REWIS, BY WILLIAM E. HAYES, DATED AUGUST 14, 2014 AND RECORDED IN DILLON COUNTY PLAT BOOK 46, PAGE 52.
- 7) MAP OF PROPERTY SURVEYED FOR GILLIE WILSON, BY JOHNSON & ROBERTS, DATED AUGUST OF 1962.
- 8) MAP OF PROPERTY SURVEYED FOR JESSE FLOYD ESTATE, BY ROBERT BRYAN PITTMAN, DATED APRIL-AUGUST 2017 AND RECORDED IN MARION COUNTY PLAT BOOK 416, PAGE 3.
- 9) PLAT OF A LOT TO BE SOLD TO WILLIAM ALLEN, BY C.O. EPPS, DATED MAY 15, 1970 AND RECORDED IN DILLON COUNTY IN PLAT BOOK 11, PAGE 39.
- 10) PLAN AND PROFILE OF PROPOSED STATE HIGHWAY; DOCKET NO. 34.282; MARION COUNTY; ROAD S-83; APPROVED BY THE STATE HIGHWAY ENGINEER FEBRUARY 26, 1958.
- 11) USGS QUAD MAPS: 1959 "FORK", 1960 "LATTA", and 1962 "LAKE VIEW."

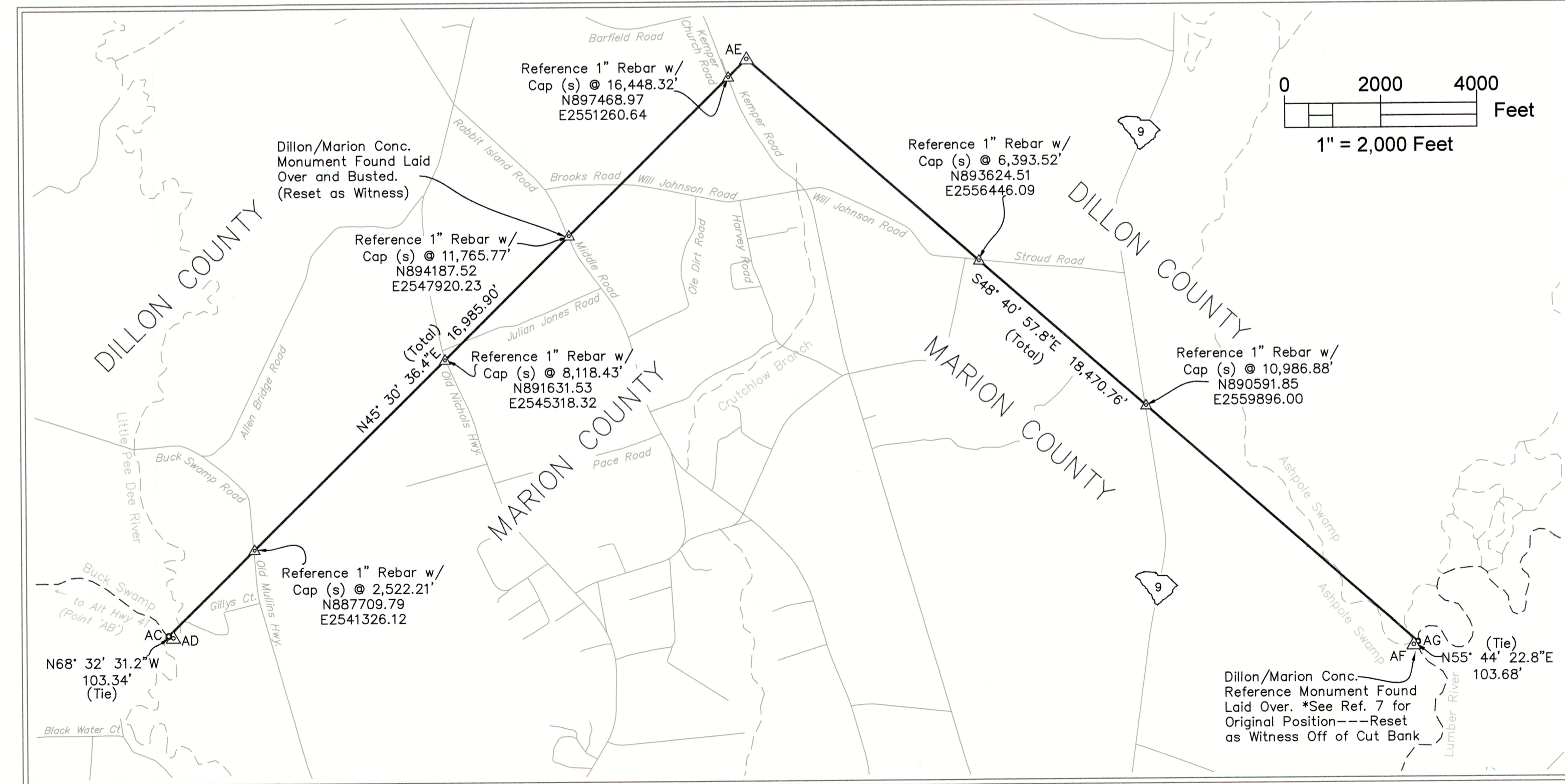

## RE-ESTABLISHMENT OF PORTIONS OF THE COMMON BOUNDARY OF DILLON AND MARION COUNTIES

FIELD WORK AND MAP BY  
**SOUTH CAROLINA GEODETIC SURVEY**  
 REVENUE AND FISCAL AFFAIRS OFFICE  
 1000 ASSEMBLY STREET, SUITE 421  
 COLUMBIA  
 SC 29201  
 803.734.3793

I hereby state that to the best of my professional knowledge, information, and belief, the survey shown hereon was made in accordance with the requirements of the Standards of Practice Manual for Surveying in South Carolina, and meets or exceeds the requirements for a Class B survey as specified therein.

*[Signature]* 11-4-2022  
 PROF. LAND SURVEYOR NO. 26946  
 DAVID K. BALLARD

Date: JUNE 30, 2021  
 \*Date Reflects Final Day of Field Work