

CURVE DATA													
CURVE	RADIUS	LENGTH	TANGENT	CHORD	BEARING	DELTA	CURVE	RADIUS	LENGTH	TANGENT	CHORD	BEARING	DELTA
C1	3475.66	598.52	300.00	597.78	N78°47'56"E	09°51'59"	C28	50.00	23.44	11.94	23.22	N56°25'31"W	26°51'17"
C2	634.75	55.40	27.72	55.39	N81°13'53"E	05°00'04"	C29	38.00	56.27	34.73	51.27	N00°34'34"W	84°50'35"
C3	634.75	351.87	180.48	347.19	N62°31'33"E	31°44'37"	C30	664.75	27.12	13.56	27.11	N40°40'37"E	02°20'14"
C4	634.75	82.65	41.48	82.39	N43°19'53"E	07°28'43"	C31	664.75	102.14	51.17	102.04	N35°08'23"E	08°49'14"
C5	78.00	60.78	32.17	59.13	S86°12'54"E	46°28'04"	C32	604.75	11.26	5.63	11.26	S38°58'34"W	01°04'00"
C6	146.66	117.33	62.01	114.23	N34°10'36"W	45°50'11"	C33	604.75	212.41	107.31	211.32	S49°34'17"W	20°07'26"
C7	634.75	431.88	224.87	423.60	N20°01'01"E	38°59'01"	C34	604.75	134.20	67.37	133.92	S65°58'26"W	12°42'51"
C8	3445.66	85.86	42.93	85.85	N74°34'46"E	01°25'40"	C35	38.00	63.93	42.50	56.85	N59°27'21"W	96°23'36"
C9	3445.66	112.42	56.22	112.42	N78°13'40"E	01°52'10"	C36	171.66	17.78	8.89	17.75	N14°13'22"W	05°55'37"
C10	3445.66	112.17	56.09	112.16	N78°06'43"E	01°51'54"	C37	171.66	102.78	52.71	102.77	N34°15'16"W	34°08'12"
C11	3445.66	112.03	56.02	112.02	N78°57'33"E	01°51'46"	C38	75.00	41.94	21.54	41.40	N35°18'06"W	32°02'33"
C12	3445.66	112.01	56.01	112.01	N81°49'19"E	01°51'45"	C39	60.00	55.53	31.02	52.72	N51°05'53"W	63°38'08"
C13	3445.66	58.86	29.43	58.86	N83°14'33"E	00°58'44"	C40	50.00	55.34	30.89	52.56	S65°22'31"W	63°25'04"
C14	664.75	16.79	8.40	16.79	N83°00'30"E	01°26'51"	C41	50.00	53.71	29.77	51.16	S02°53'40"W	61°32'38"
C15	664.75	112.37	56.32	112.24	N77°28'30"E	09°41'07"	C42	50.00	55.16	30.77	52.41	S39°29'01"E	63°12'45"
C16	664.75	107.78	54.01	107.66	N97°57'15"E	09°17'24"	C43	75.00	74.30	40.52	71.30	S22°42'30"E	58°45'49"
C17	664.75	129.68	65.05	129.47	N57°43'14"E	11°10'37"	C44	121.66	6.86	3.43	6.86	S32°42'37"E	03°13'56"
C18	38.00	56.29	34.74	51.28	S85°25'58"E	64°52'12"	C45	121.66	42.12	21.27	41.91	S21°10'36"E	19°50'06"
C19	100.00	5.08	2.54	5.08	S44°27'07"E	02°54'30"	C46	38.00	63.00	41.48	56.03	N08°50'19"W	94°59'28"
C20	100.00	73.87	36.92	74.15	S67°40'09"E	43°51'34"	C47	3505.66	39.39	19.69	39.38	S83°43'37"W	00°38'57"
C21	25.00	21.03	11.18	20.41	S65°20'14"E	48°11'23"	C48	3505.66	112.02	56.02	112.02	S27°10'22"W	01°49'51"
C22	50.00	50.63	27.72	48.49	S70°14'56"E	58°00'47"	C49	3505.66	112.02	56.01	112.01	S80°20'31"W	01°49'51"
C23	50.00	55.10	30.73	52.36	N49°10'21"E	63°08'39"	C50	3505.66	112.12	56.07	112.12	S78°30'37"W	01°49'57"
C24	50.00	55.54	31.03	52.73	N14°13'25"W	63°38'54"	C51	3505.66	112.35	56.18	112.34	S76°40'34"W	01°50'10"
C25	50.00	79.91	51.39	71.88	S89°09'55"W	91°34'28"	C52	3505.66	112.69	56.35	112.69	S74°50'13"W	01°50'30"
C26	25.00	21.03	11.18	20.41	S65°20'14"E	48°11'23"	C53	3505.66	3.09	1.55	3.09	N73°53'27"E	00°03'02"
C27	50.00	17.09	8.63	17.00	N79°38'32"W	19°34'46"	C54	664.75	129.26	64.83	129.06	N36°16'50"E	11°08'28"

REFERENCE INFORMATION:
 1. PLAT SHOWING PARCEL XII, 792.486 ACRES, PROPERTY OF WESTVACO DEVELOPMENT CORPORATION ABOUT TO BE CONVEYED TO WESTVACO DEVELOPMENT CORPORATION, DATED DECEMBER 8, 1986, SURVEYED BY CHARLES W. SHAVER S.C.R.L.S. NO. 8076, AND RECORDED AT THE BERKELEY COUNTY R.M.C. OFFICE IN CABINET "H", PAGE "154", AND AT THE CHARLESTON COUNTY R.M.C. OFFICE IN BOOK "BW", PAGE "5".
 2. PLAT SHOWING CROWFIELD GOLF & COUNTRY CLUB, PARCELS "A" THRU "T", A PORTION OF PARCEL XII, PROPERTY OF WESTVACO DEVELOPMENT CORPORATION, DATED JANUARY 20, 1994, SURVEYED BY CHARLES W. SHAVER S.C.R.L.S. NO. 8076, AND RECORDED IN CABINET "H", PAGE "213".
 3. THIS SITE IS COVERED UNDER DEPARTMENT OF THE ARMY DELINEATION PERMIT NO. SAC-81-99-0464(V), EXPIRES JUNE 23, 2004, AND MITIGATION PERMIT NO. 98-1X-267, EXPIRES MARCH 31, 2010.
 4. PLAT SHOWING THE HAMLETS OF CROWFIELD, SECTION "C13-C", DATED FEBRUARY 2, 1999, SURVEYED BY K.A. MAHONEY, S.C.R.L.S. NO. 6271, AND RECORDED IN CABINET "O", PAGE "6-A".
 5. PLAT SHOWING THE HAMLETS OF CROWFIELD, SECTION "C14", PARCEL 7-C, 17.784 ACRES, A PORTION OF PARCEL XII, DATED SEPTEMBER 29, 1998, SURVEYED BY K.A. MAHONEY, S.C.R.L.S. NO. 6271, AND RECORDED IN CABINET "N", PAGE "283-A".

LINE DATA		
LINE	DIRECTION	DISTANCE
L1	N16°08'04"W	30.00'
L2	S16°08'04"E	30.00'
L3	N08°41'41"W	79.18'
L4	N24°28'06"W	59.77'
L5	N64°36'38"W	88.38'
L6	N24°08'35"W	37.56'
L7	N29°58'03"E	39.68'
L8	N80°03'57"W	138.20'
L9	N76°08'52"E	52.77'
L10	N76°08'52"E	50.58'
L11	N13°51'08"W	43.09'
L12	N08°50'19"W	52.08'
L13	N50°30'17"W	30.00'
L14	S50°30'17"E	30.00'
L15	S86°18'59"E	45.65'
L16	S41°37'48"E	261.10'

Doc# 0012727
 PLAT CABINET O PAGE 048-B
 Filed and Recorded
 06/27/2000 09:56:57AM
 Cynthia E. Fort
 Register of Deeds Berkeley Co.
 SC

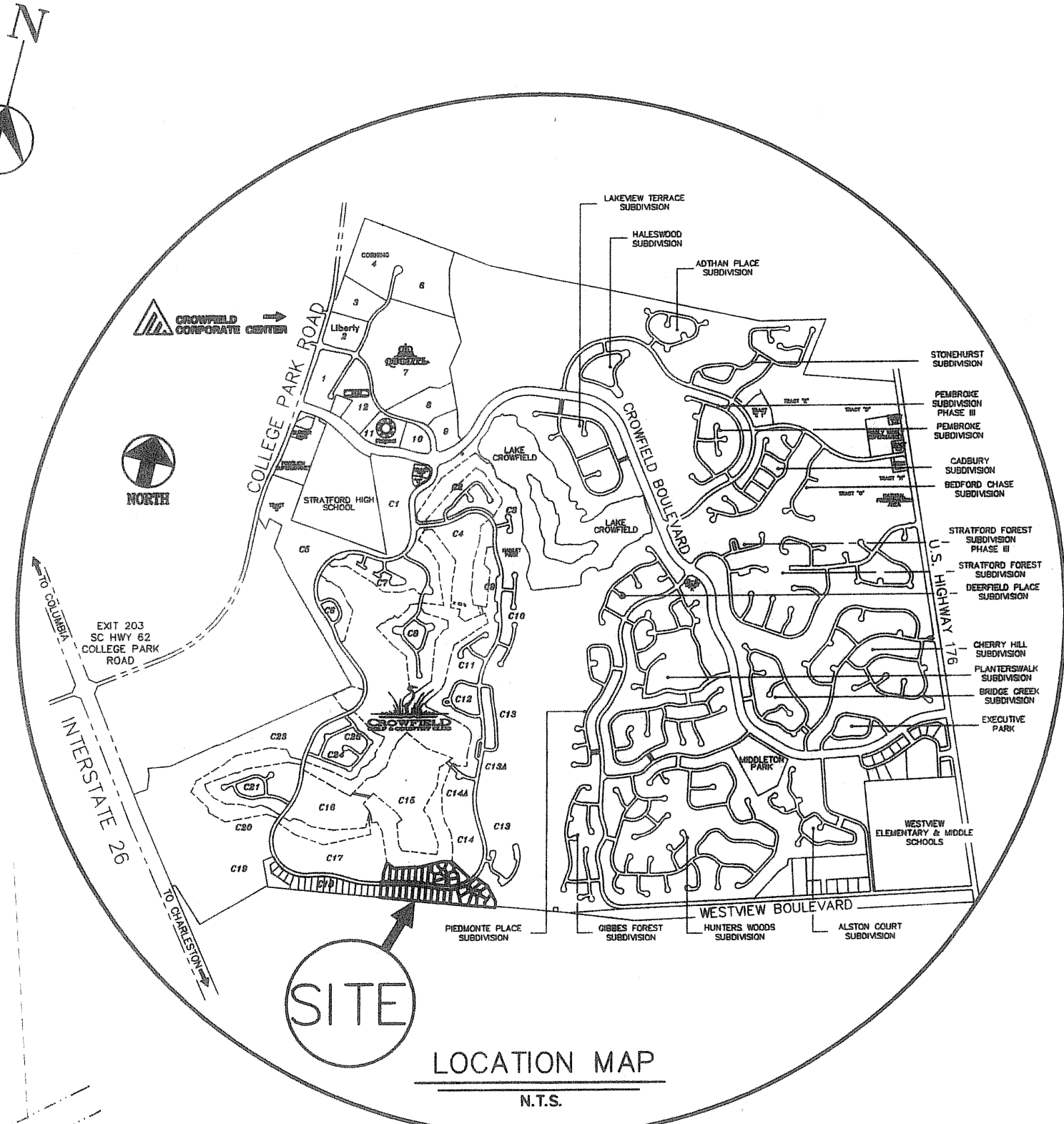

THOSE AREAS OF LAND DESIGNATED AS "NATURAL BUFFER" ARE INTENDED AS GENERAL COMMON AREAS FOR USE BY OWNERS OF PROPERTY WITHIN CROWFIELD PLANTATION FOR RECREATION AND RELATED ACTIVITIES. THESE AREAS ARE NOT DEDICATED HEREBY FOR USE BY THE GENERAL PUBLIC BUT ARE DEDICATED TO THE COMMON USE AND ENJOYMENT OF THE RESIDENTS AND HOMEOWNERS OF CROWFIELD PLANTATION AS GENERAL COMMON AREA AS MORE FULLY PROVIDED IN THE DECLARATION OF COVENANTS, CONDITIONS, RESTRICTIONS, CHARGES AND LIENS FOR CROWFIELD PLANTATION COMMUNITY SERVICES ASSOCIATION, INC., AS RECORDED IN THE OFFICE OF THE REGISTER OF MESSE CONVEYANCES FOR BERKELEY COUNTY, SOUTH CAROLINA, IN BOOK C 137, PAGE 209, AND HEREBY INCORPORATED AND MADE A PART OF THIS PLAT BY REFERENCE.

BY THE RECORDING OF THIS PLAT WE HEREBY DEDICATE THE DRAINAGE EASEMENTS AND ROAD RIGHT-OF-WAY SHOWN HEREON TO THE USE OF THE PUBLIC FOREVER, NOTHING IN THIS DEDICATION SHALL BE CONSTRUED TO IMPLY AN ACCEPTANCE BY BERKELEY COUNTY OF ANY ROADWAYS OR DRAINAGE FACILITIES, OR AS CREATING ANY DUTY BY BERKELEY COUNTY TO MAINTAIN ANY ROADWAY OR RIGHT-OF-WAY SHOWN HEREON.

WESTVACO DEVELOPMENT CORPORATION
 D.J. COLLINS
 PRESIDENT
 6/30/00
 DATE

LEGEND	
---	PROPERTY LINE W/IRON PIN
---	RIGHT-OF-WAY
▲	CENTERLINE W/POINT OF INTERSECTION
---	ADJACENT PROPERTY LINE
---	GENERAL UTILITY EASEMENT
---	B.E.C. POWER EASEMENT
---	S.C.P.S.A. POWER EASEMENT
---	DRAINAGE EASEMENT
---	BELLSOUTH UTILITY EASEMENT

I HEREBY CERTIFY THAT THE PROPERTY SHOWN ABOVE DOES LIE WITHIN SPECIAL FLOOD ZONE "X" PER H.U.D. F.E.M.A. FLOOD HAZARD MAP PANEL NO. 450029 0355 C, DATED MAY 6, 1996.
 K.A. Mahoney
 KENDRICK (ANTHONY) MAHONEY
 S.C. REG. P.L.S. NO. 6271



APPROVED:
 CITY OF GOOSE CREEK
 OFFICIAL: [Signature]
 DATE: 6/27/00

THE HAMLETS OF CROWFIELD, SECTION "C18"
 LOTS "19" THRU "52"
 ZONING CLASSIFICATION: PLANNED DISTRICT
 TAX MAP REFERENCE NO.: 234-00-00-054
 MINIMUM LOT SIZE: 16,744 sq.ft.(lot 41)
 NO. OF LOTS: 34
 TOTAL LOT ACREAGE: 20.644 acres
 TOTAL R/W ACREAGE: 3.081 acres
 TOTAL NATURAL BUFFER ACREAGE: 1.730 acres
 TOTAL ACREAGE: 25.455 acres

THE HAMLETS of Crowfield

PLAT SHOWING THE HAMLETS OF CROWFIELD, SECTION "C18", LOTS 19 THRU 52, PROPERTY OF WESTVACO DEVELOPMENT CORPORATION, LOCATED ON CROWFIELD PLANTATION, IN THE CITY OF GOOSE CREEK, BERKELEY COUNTY, SOUTH CAROLINA
 DATE: JUNE 20, 2000
 SCALE: 1" = 100'

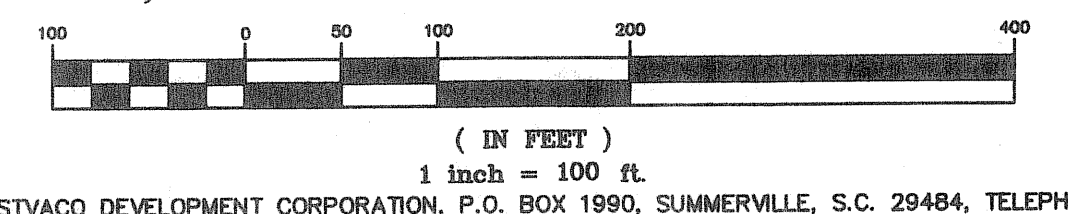

PREPARED BY: WESTVACO DEVELOPMENT CORPORATION, P.O. BOX 1990, SUMMERVILLE, S.C. 29484, TELEPHONE (843) 871-6710