

PB 6  
145

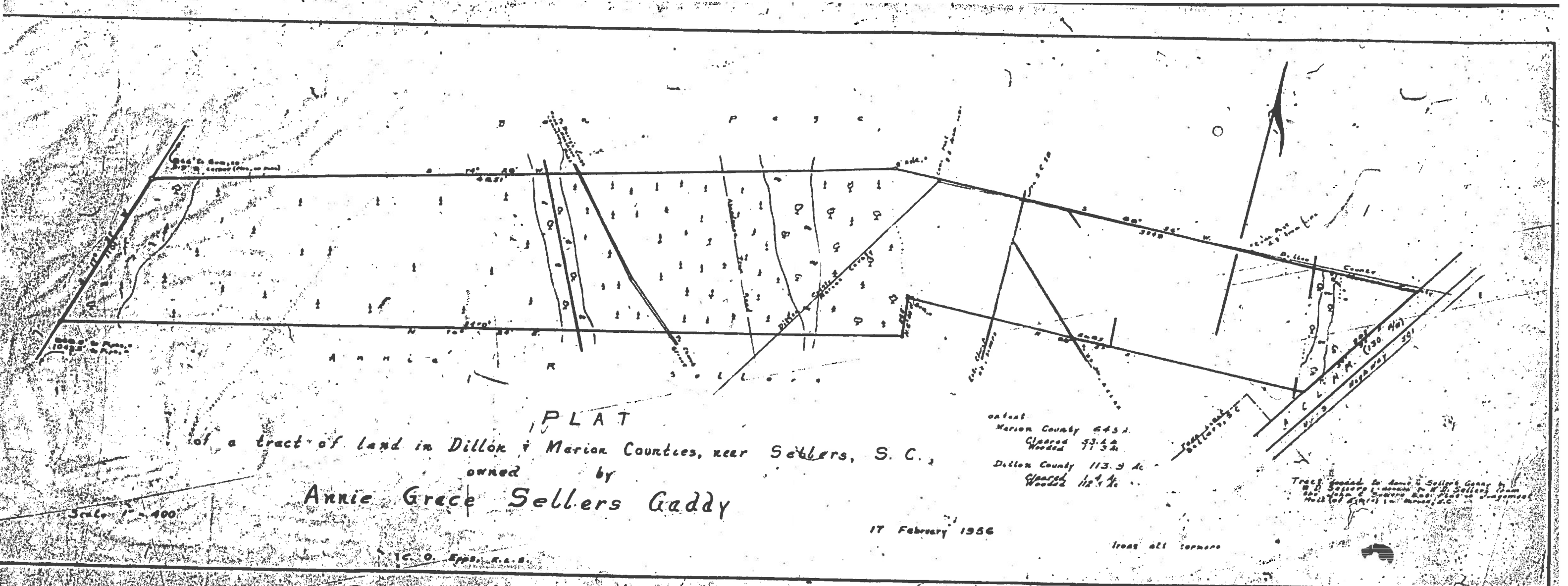

PLAT  
 of a tract of land in Dillon & Marion Counties, near Sellers, S. C.,  
 owned by  
**Annie Grace Sellers Gaddy**

total  
 Marion County 645 A.  
 Cleared 57.4 A.  
 Wooded 57.5 A.  
 Dillon County 113.3 A.  
 Cleared 112.4 A.  
 Wooded 112.4 A.

Tract owned by Annie G. Sellers Gaddy to  
 W. D. Sellers & Annie G. Sellers from  
 the John C. Sellers Est. Plat of Management  
 Map of 1911 in Marion Co. S.C.

17 February 1956

Iron all corners

Scale 1" = 400'

J. C. O. Epps, R.L.S.