

- Sheet
 1 Title Sheet
 2-2A Typical Section of Improvement
 3 Intersection Standard
 4 Superelevation Standard
 5 Traffic Control Device
 6-7 Plans & Profile Rd. 5-83
 8 Plan & Profile Rds. 5-195 & 5-196

SOUTH CAROLINA
 STATE HIGHWAY DEPARTMENT
 COLUMBIA

PLAN AND PROFILE OF PROPOSED
 STATE HIGHWAY

DKT. 34,282
 MARION CO.
 ROADS: 5-83, 5-195 & 5-196
 STREETS IN SELLERS

FED. ROAD DIV. NO.	STATE	COUNTY	ROUTE NO.	F. A. PROJ. NO.	ROUTE NO.	SHEET NO.	TOTAL SHEETS
3	S. C.	MARION	34,282		5-83 5-195 5-196	1	8

SUMMARY OF ESTIMATED QUANTITIES

	5-83	5-195	5-196	
EARTHWORK				
Clearing and Grubbing within Roadway	Nec.	Nec.	Nec.	
Clearing and Grubbing of Borrow and Material Pits	1.0			Acres
Unclass. Excavation	2325	820	175	C.Y.
Overhaul	14,075	6223	1372	C.Y.M
Selected Material for Shoulders	419			C.Y.
BASE COURSE				
Earth Type Base Course (P.1 Material)	1891	889	196	C.Y.
Scarifying, Mixing, Remixing, Shaping and Reshaping	9,116	4,297	0,948	M.S.Y.
SURFACING				
Bituminous Surfacing (Double Treatment) Types 1 thru 6	8730	4128	908	S.Y.
STRUCTURES				
15" R.C. Culvert Pipe	152	36		L.F.
18" R.C. Culvert Pipe	52	180		L.F.
24" R.C. Culvert Pipe	28			L.F.
36" R.C. Culvert Pipe		16		L.F.
15" Relaid Culvert Pipe	12			L.F.
18" Relaid Culvert Pipe	42			L.F.
24" Relaid Culvert Pipe	36			L.F.
INCIDENTALS				
Reset Fence	700			L.F.

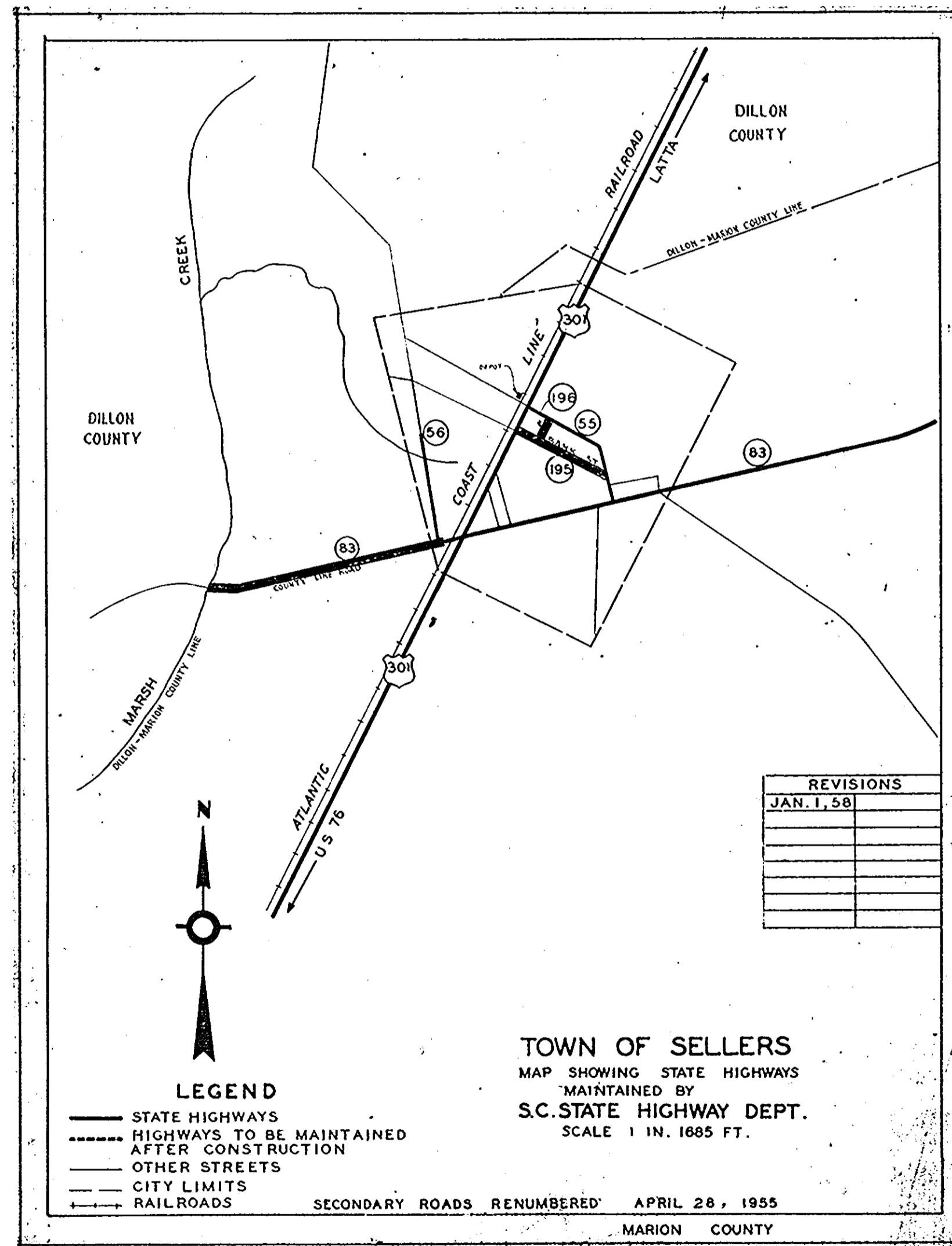

CONVENTIONAL SIGNS

State Line	Trolley Poles	• • • • •
County Line	Power Poles	• • • • •
City or Town Limits	Telephone or Telegraph Poles	• • • • •
Property Line	Marsh	• • • • •
Fence	Trees	• • • • •
Retaining Wall	Brush	• • • • •
Existing Road	Stumps	• • • • •
℄ and R.O.W. Lines of	Buildings	• • • • •
Proposed Road	Bridge	• • • • •
Railroad	Concrete Box Culvert	• • • • •
Levee or Embankment	Pipe Culvert	• • • • •
Guard Rail	Drop Inlet and Culvert	• • • • •
Point of Intersection (P. I.)	Hub on Center Line	• • • • •

LEGEND

PROPOSED PROJECT	—
OTHER ROADS	—

	5-83	5-195	5-196	
Net Length of Roadway	0.659	0.288	0.069	Miles
Net Length of Bridges				Miles
Net Length of Project	0.659	0.288	0.069	Miles
Length of Exceptions				Miles
Gross Length of Project	0.659	0.288	0.069	Miles

Equalities in Stationing

Note: All workmanship and material on this project to conform with South Carolina State Highway Department Standard Specifications for Highway Construction dated Nov. 1, 1955

APPROVED FOR TOWN OF SELLERS
 DATE
 [Signature] MAYOR 3-13-58
 [Signature] 3-13-58
 [Signature] 3-13-58
 [Signature] 3-13-58
 [Signature] CLERK 3-13-58

APPROVED:
 [Signature] 2-26-58
 STATE HIGHWAY ENGINEER DATE

DEPARTMENT OF COMMERCE
 BUREAU OF PUBLIC ROADS
 RECOMMENDED FOR APPROVAL:
 [Signature] [Signature]
 DISTRICT ENGINEER DATE
 APPROVED:
 [Signature] [Signature]
 DIVISION ENGINEER DATE

Fed. Rd. Div. No.	State	County	Dist. No.	Rd. No.	Sheet No.	Total Sheets
3	S.C.	Marion	34.282	5-83	2	8

STATE HIGHWAY DEPT.
COLUMBIA
TYPICAL SECTIONS
FOR
EARTH TYPE BASE COURSE
AND BITUMINOUS SURFACING

SCALE: 1/2" = 1'-0"

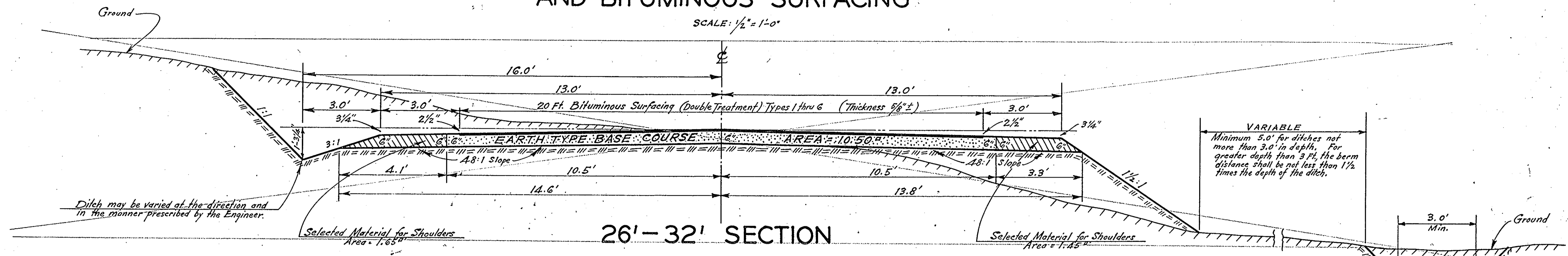

26'-32' SECTION

VARIABLE
Minimum 5.0' for ditches not more than 3.0' in depth. For greater depth than 3 ft, the berm distance shall be not less than 1/2 times the depth of the ditch.

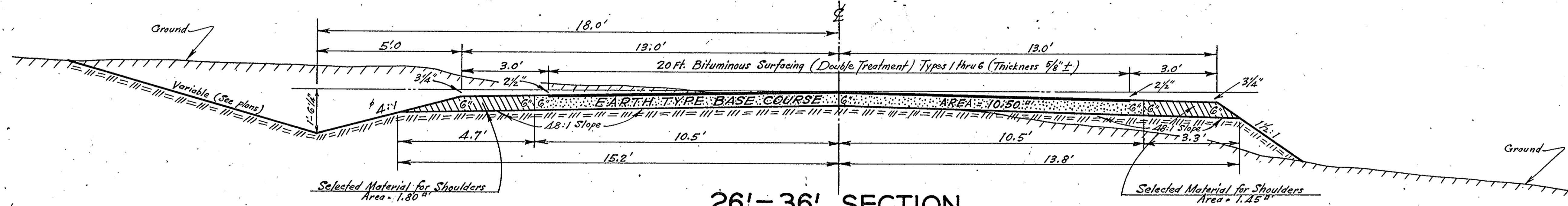
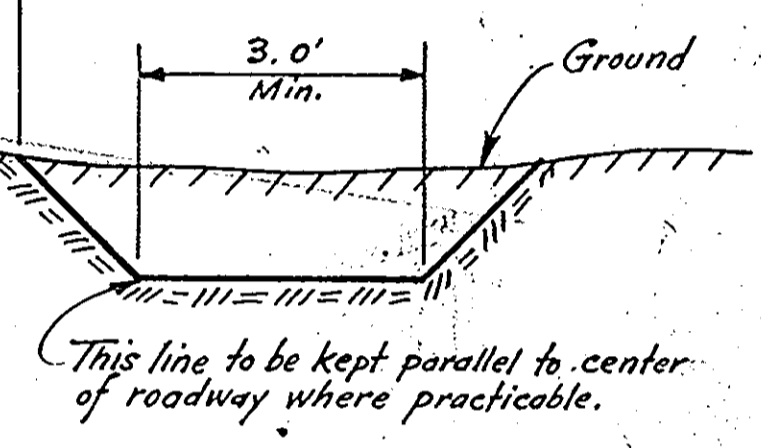

26'-36' SECTION

USE THIS SECTION THRUOUT ON RD. 5-83

Note: This slope may be varied when a deeper ditch is necessary for drainage purposes, using a minimum slope of 12:1 and a maximum slope of 3:1. Where a deeper ditch than provided by a 3:1 is necessary, the ditch shall be placed farther from the centerline continuing the 3:1 slope to provide the necessary depth. See profile for special ditch grades.
Also, this section may be widened by continuing the 4:1 slope (the distance between the centerline and bottom of the ditch not to exceed 24 ft.) where borrow material is necessary on flat grades that are governed by water elevation or where a wide ditch is necessary for drainage purposes.

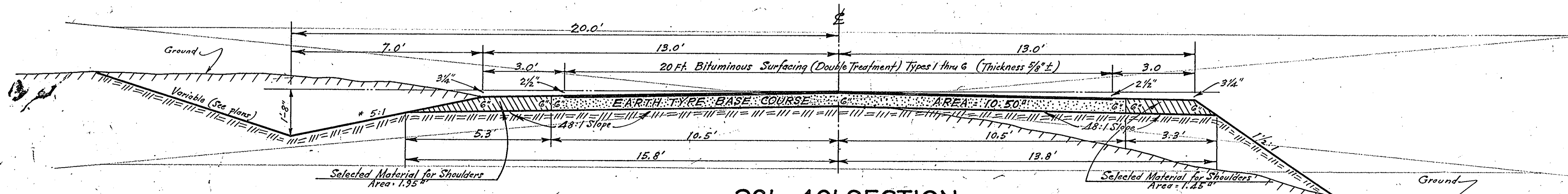

26'-40' SECTION

Note: This slope may be varied when a deeper ditch is necessary for drainage purposes, using a minimum slope of 12:1 and a maximum slope of 4:1. Where a deeper ditch than provided by a 4:1 is necessary, the ditch shall be placed farther from the centerline continuing the 4:1 slope to provide the necessary depth. See profile for special ditch grades.
Also, this section may be widened by continuing the 5:1 slope (the distance between the centerline and bottom of the ditch not to exceed 30 feet) where borrow material is necessary on flat grades that are governed by water elevation or where a wide ditch is necessary for drainage purposes.

Note: Horizontal dimensions are shown in tenths of feet.

FED. ROAD DIV. NO.	STATE	COUNTY	DOCKET NO.	PROJ. NO.	Sheet No.	SHEET NO.	TOTAL SHEETS
3	S.C.	Marion	34,282		5-195 5-196	2-A	8

S.C. HIGHWAY DEPARTMENT
TYPICAL SECTION
of
IMPROVEMENT
 SCALE 1 IN. = 2 1/2 FT.

Note: No work to be performed in this area unless it is necessary to shape or pull ditches to provide proper drainage

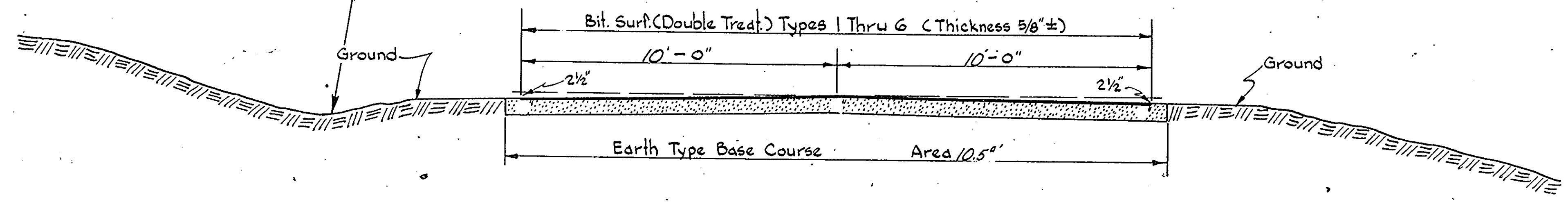

USE THIS SECTION THROUGHOUT ON RDS. 5-195 & 5-196

FED. ROAD DIV. NO.	STATE	COUNTY	DOCKET NO.	PROJECT NO.	ROAD NO.	SHEET NO.	TOTAL SHEETS
3	S.C.	Marion	34,282		5-81 5-195 5-196	5	8

STANDARD TYPE INTERSECTIONS

SCALE: 1" = 25'

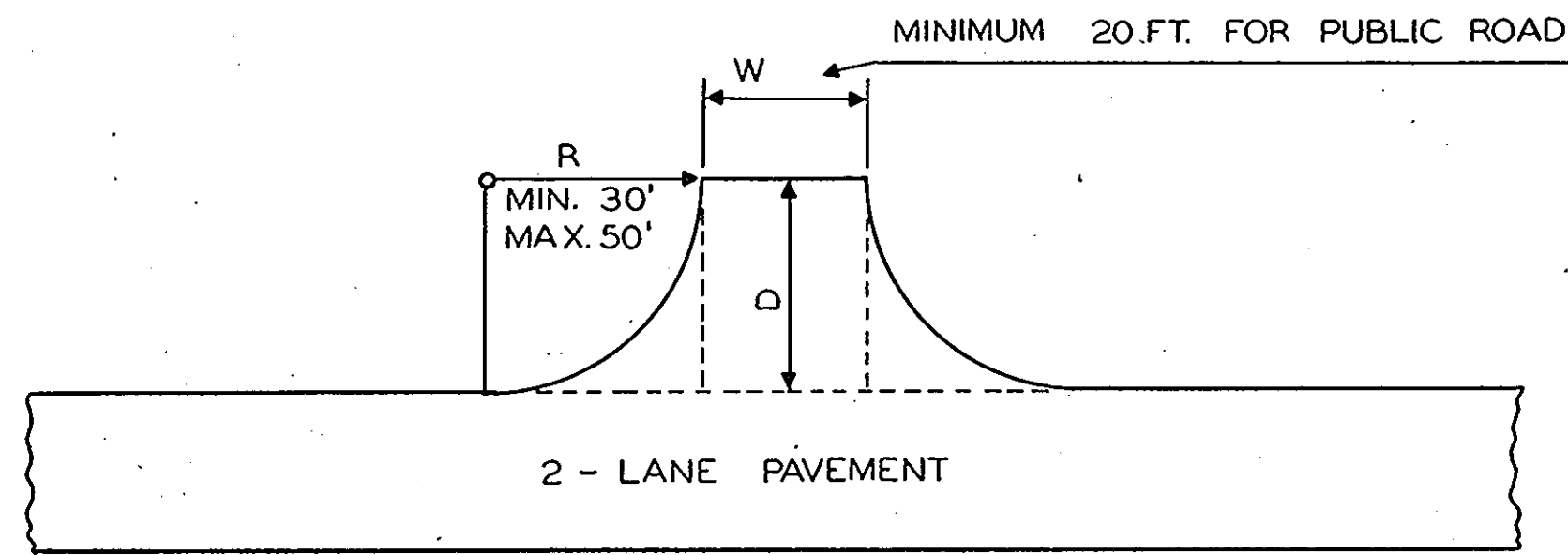

T - TYPE INTERSECTION

FOR ANGLES AT OR NEAR 90°
AREA OF PAVED SPUR = $WD + 0.43 R^2$

FOR PRIVATE DRIVEWAYS TO BE PAVED,
USE THIS TYPE WITH 20' RADIUS AND 10'
WIDTH AT BACK. AREA FOR DRIVEWAY =
41.3 S.Y.

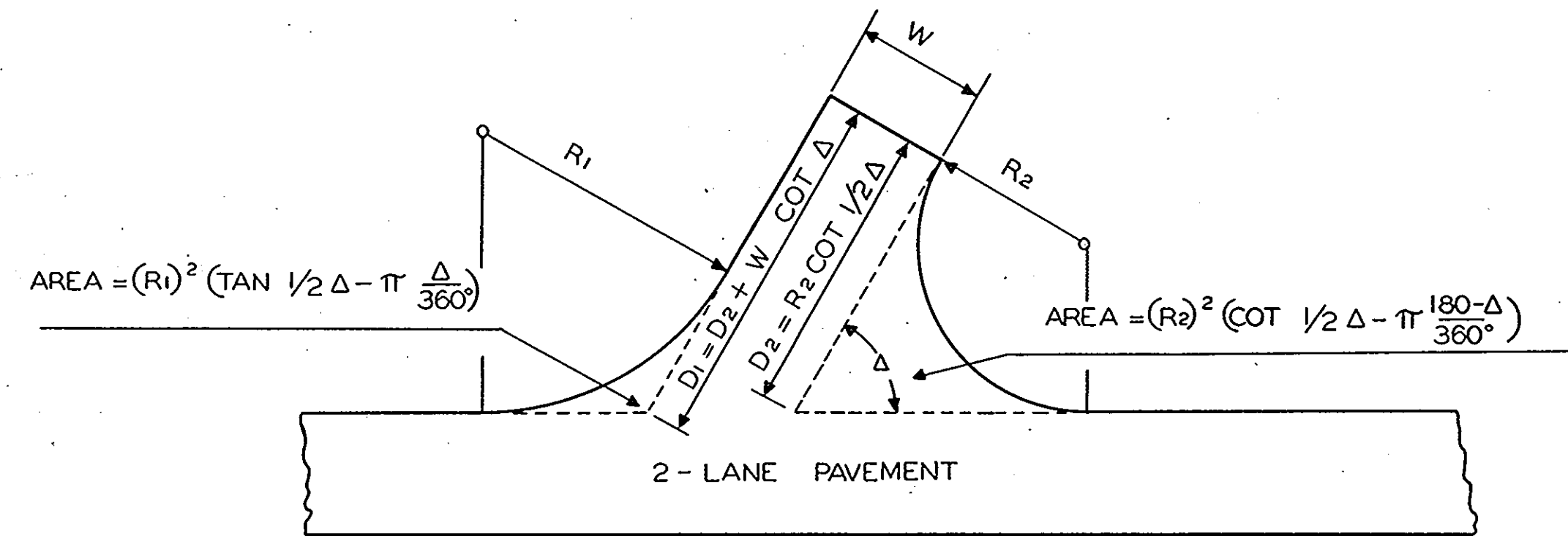

Y - TYPE INTERSECTION

ANGLE Δ	MAXIMUM			MINIMUM		
	R ₁ FEET	R ₂ FEET	AREA * S.Y.	R ₁ FEET	R ₂ FEET	AREA * S.Y.
90°	50	50	241.7	30	30	116.3
75°	80	50	354.3	50	25	145.1
60°	125	35	350.2	75	20	164.1
45°	200	25	355.9	100	15	170.2
# 30°	300	20	398.1	150	10	180.0

* THE AREAS GIVEN ARE FOR THE TOTAL AREA BEYOND THE EDGE OF THE PAVEMENT ON THE MAIN ROAD. WIDTH AT BACK OF INTERSECTION, W = 22 FT.

INTERSECTIONS AT LESS THAN 45° SHOULD BE CONSTRUCTED WITH SEPARATE TURNING LANES WHERE PRACTICAL AS SHOWN BY INTERSECTION TYPE BELOW.

GENERAL NOTES:

INTERSECTIONS FOR SIDE ROADS AND DRIVEWAYS WHERE DIRECTED BY THE ENGINEER, WILL BE PAVED USING ONE OF THE STANDARD TYPES SHOWN, UNLESS OTHERWISE SHOWN ON PLANS.

IN THE CASE OF MINOR PUBLIC ROADS INTERSECTING THE HIGHWAYS AT AN OBLIQUE ANGLE, THE Y-TYPE INTERSECTION SHOULD BE USED WITH THE PAVEMENT SPUR TURNED AT THE PROPER ANGLE TO LINE UP WITH THE CENTER LINE OF THE SIDE ROAD. T-TYPE OR Y-TYPE INTERSECTIONS WITH SEPARATE TURNING LANES SHOULD BE USED AT THE MORE IMPORTANT INTERSECTIONS.

THE T-TYPE INTERSECTION AT 90° SHOULD BE USED AT DRIVEWAYS FOR PRIVATE ENTRANCES.

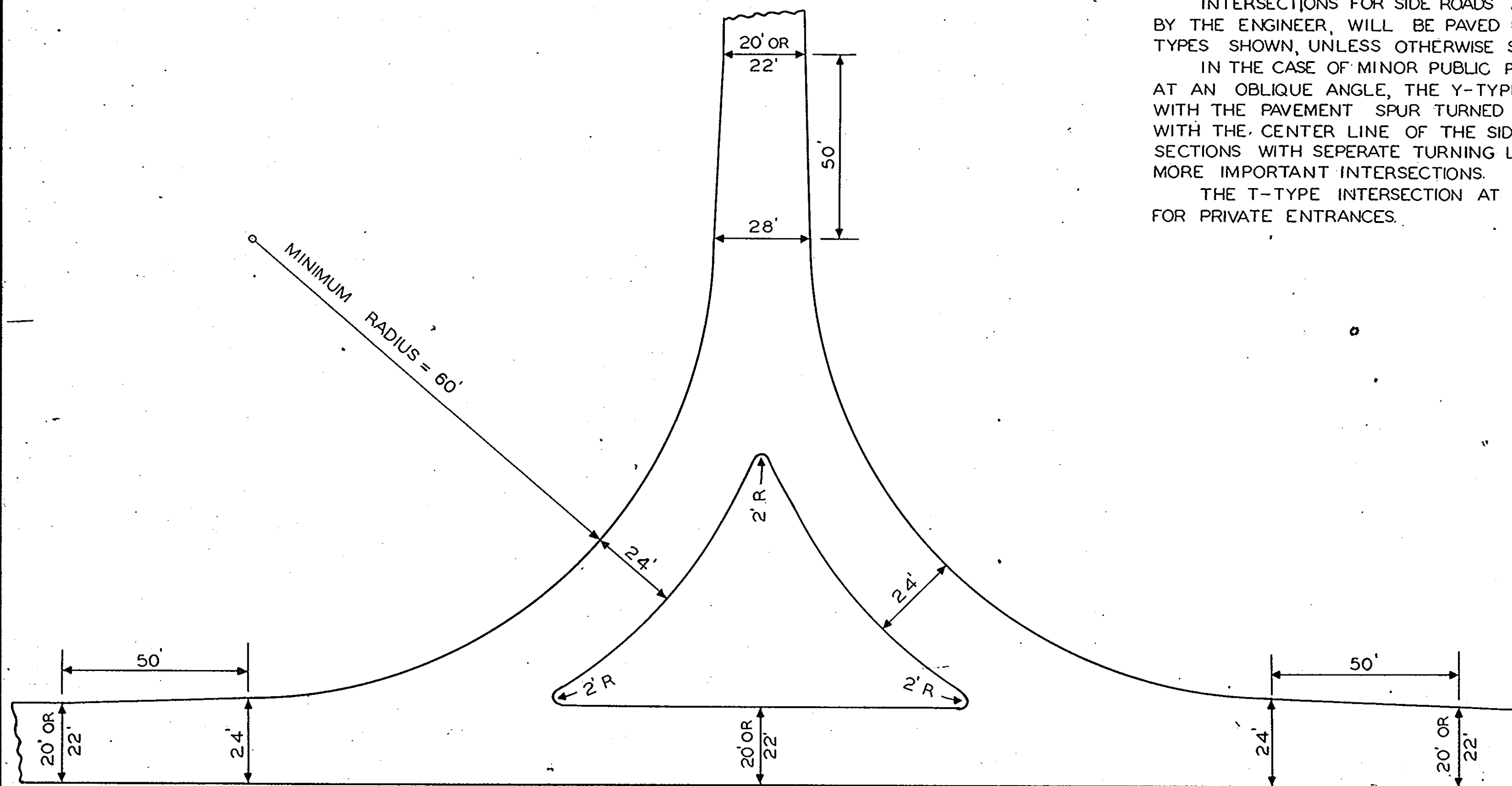

T - TYPE INTERSECTION WITH SEPARATE TURNING LANES

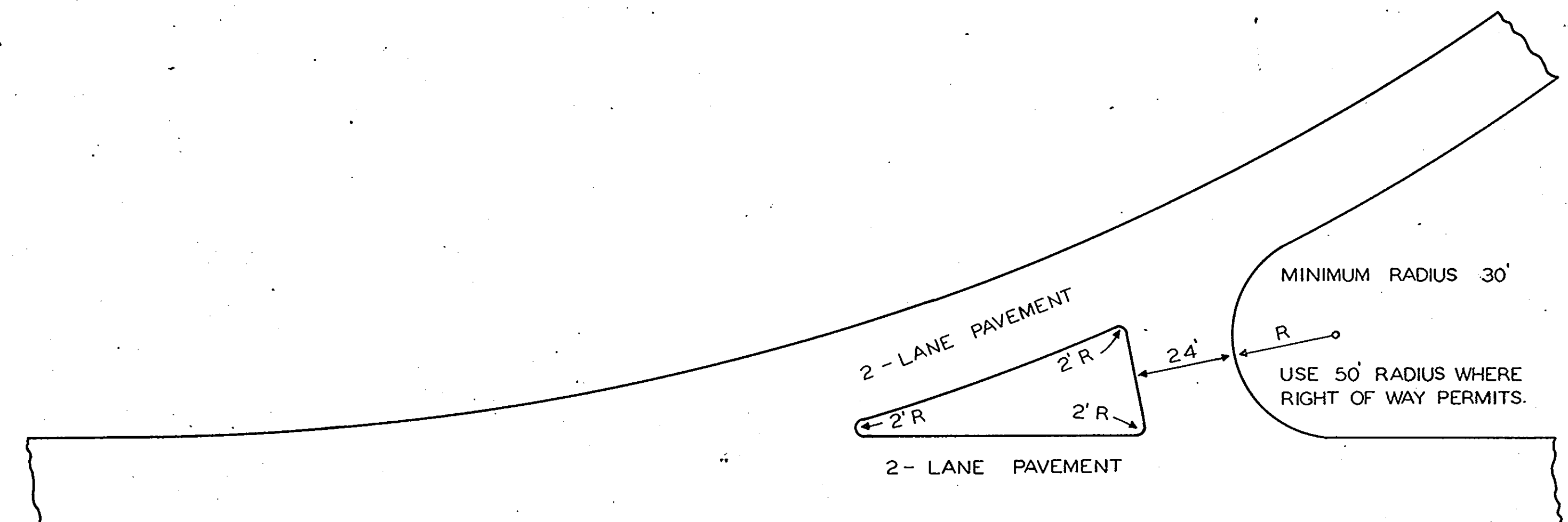

Y - TYPE INTERSECTION WITH SEPARATE TURNING LANE

DESIGNED BY GEO. C. SAWYER 11-17-45
DRAWN BY CARL W. METZ 11-19-45
RETRACED 11-22-57

TYPICAL MARKING FOR CONSTRUCTION AREAS

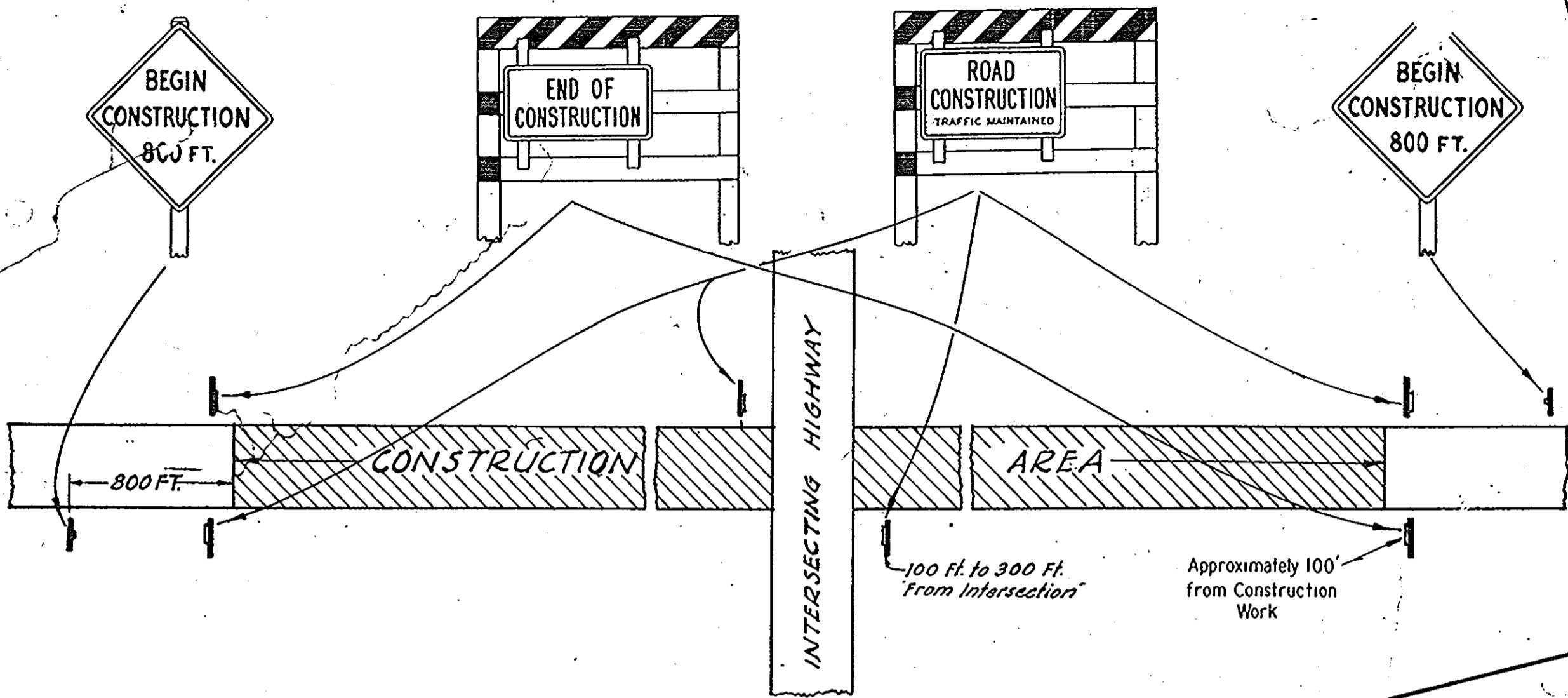

APPLICATION OF STANDARD SIGNS WHEN ROADWAY IS BEING SURFACED

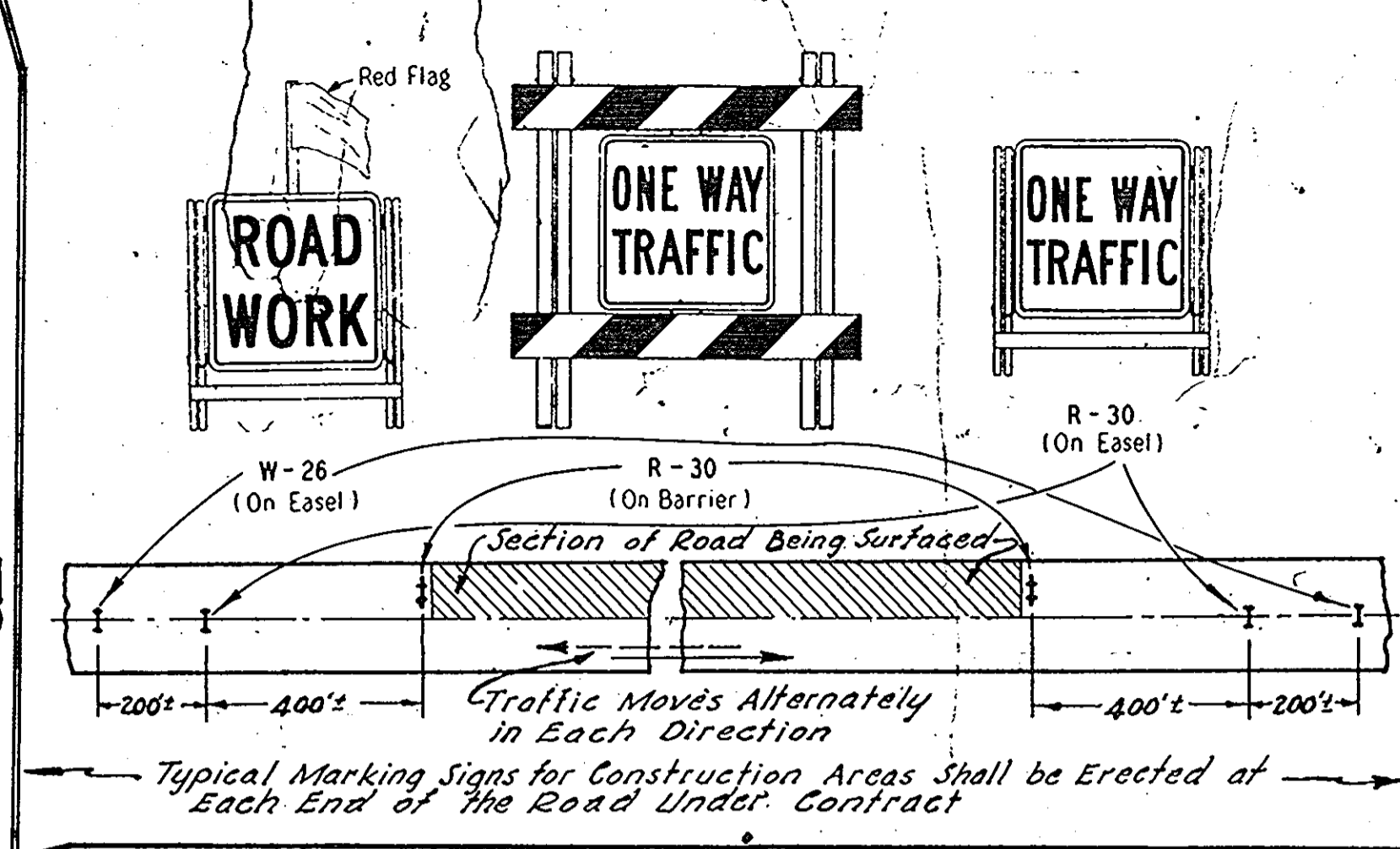

TYPICAL MARKING FOR CONSTRUCTION AREAS

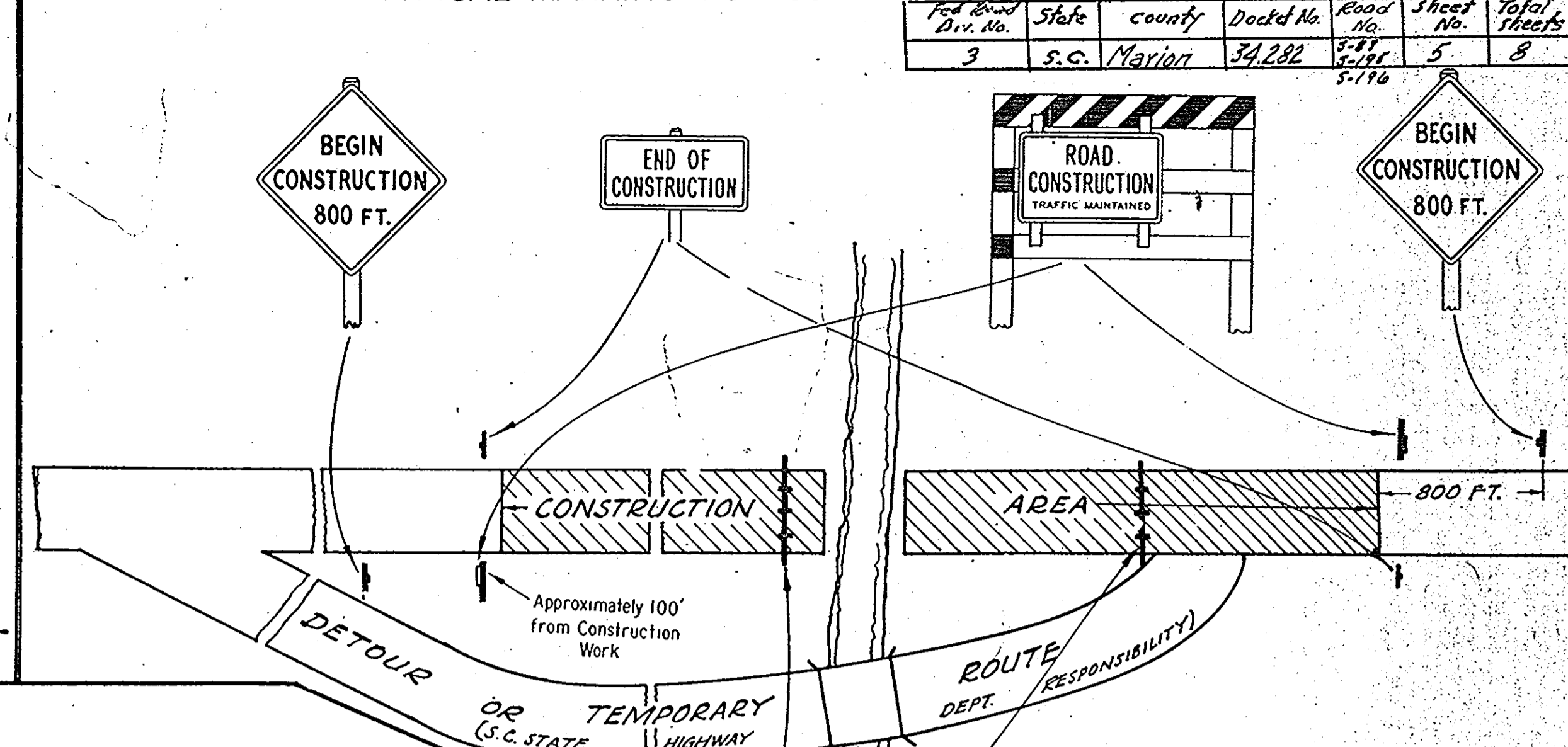

Proj. No.	State	County	Docket No.	Road No.	Sheet No.	Total Sheets
3	S.C.	Marion	34282	5-116	5	8

STANDARD BARRICADES

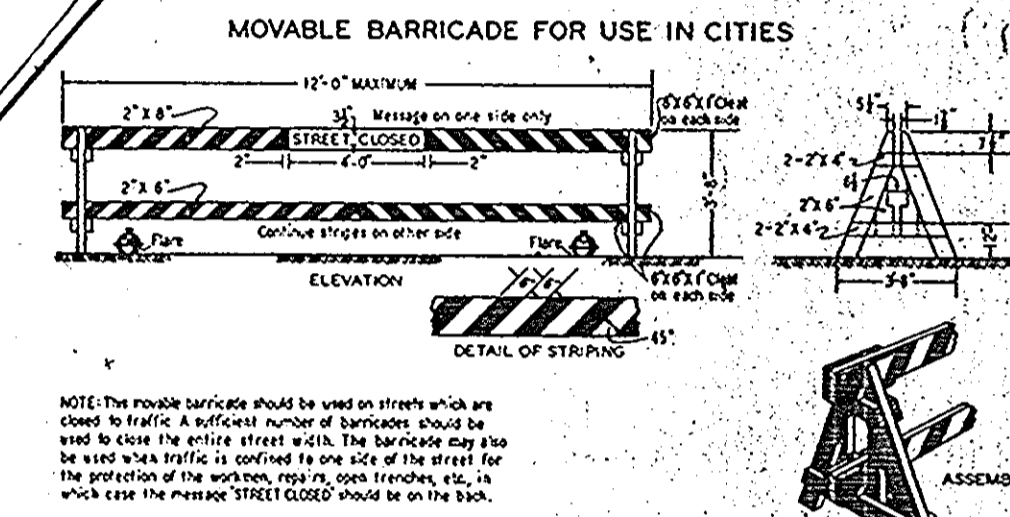
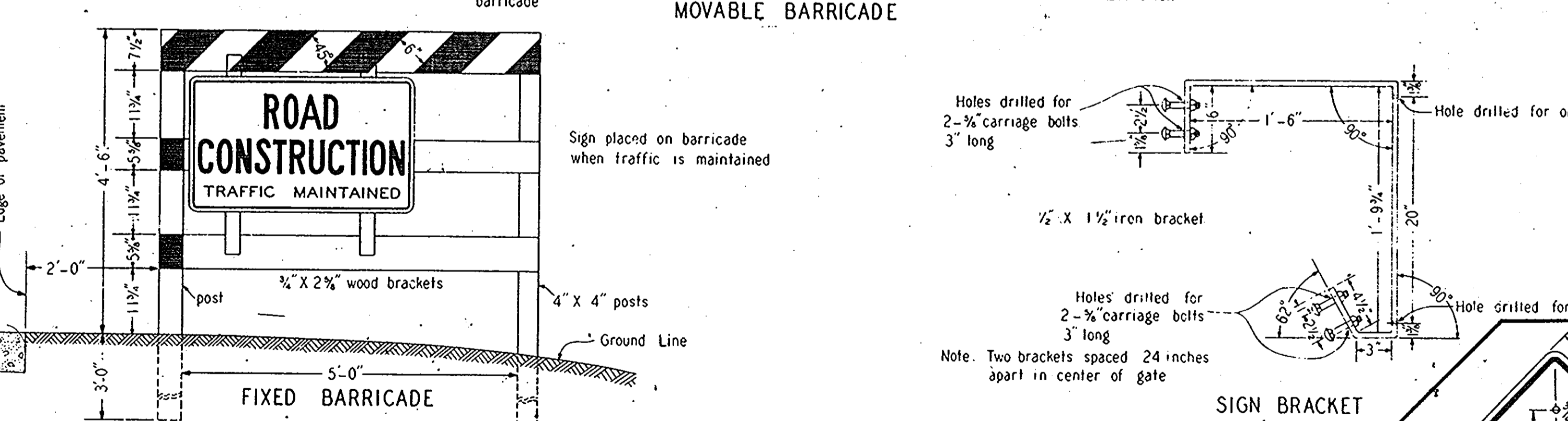
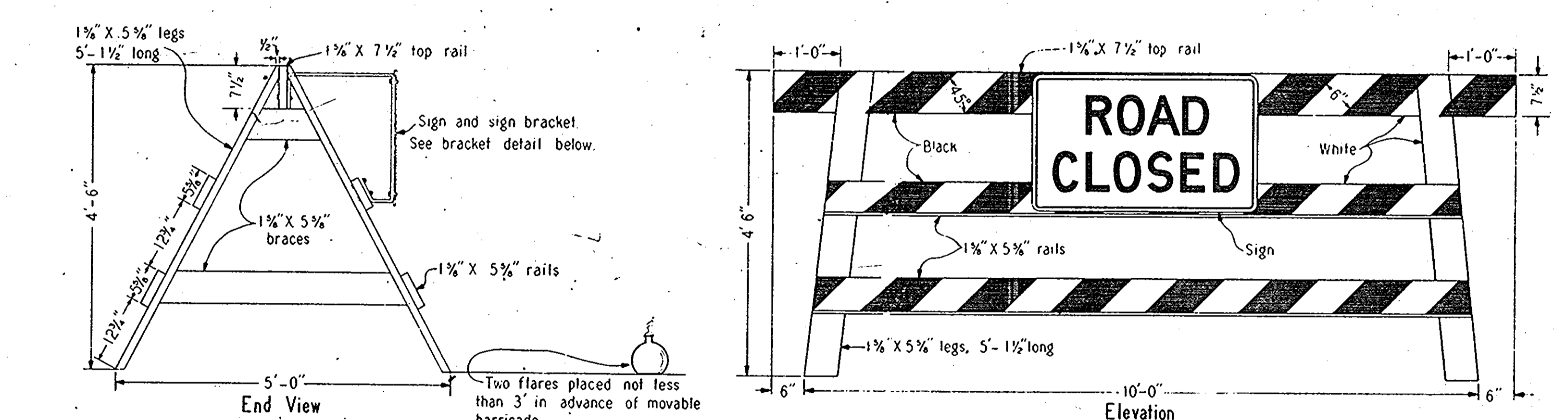
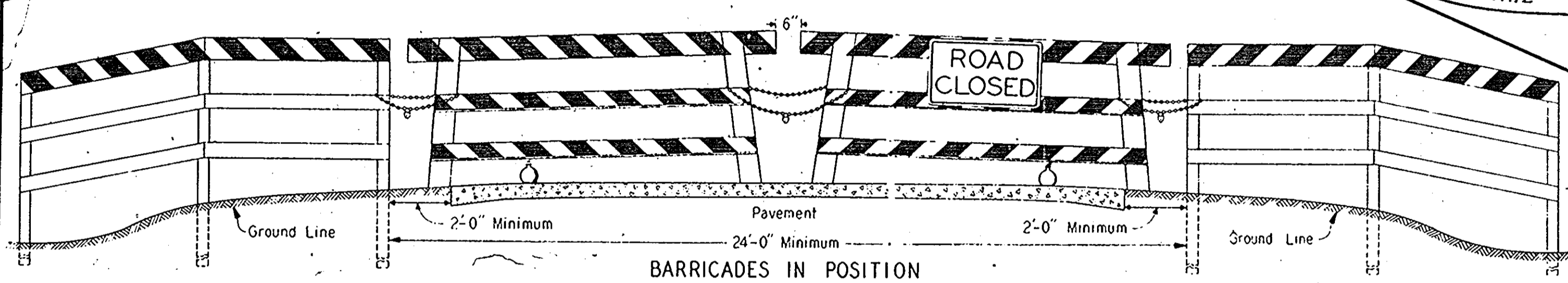

NOTE: The movable barricade should be used on streets which are closed to traffic a sufficient number of barricades should be used to close the entire street width. The barricade may be used when traffic is confined to one side of the street for the protection of the worker, repair, open trenches, etc., in which case the message "STREET CLOSED" should be on the back.

ANY CONDITIONS NOT COVERED BY DETAILS AND SIGNS OF THIS DRAWING SHALL CONFORM TO THE LATEST S. C. STANDARD SPECIFICATIONS AND TO THE LATEST S. C. STANDARD SPECIFICATIONS FOR UNIFORM TRAFFIC CONTROL DEVICES. THE LOCATION OF TYPICAL MARKINGS SHOWN HEREON MAY BE VARIED TO CONFORM TO FIELD CONDITIONS.

THE CONTRACTOR SHALL PROVIDE AND ERECT APPROPRIATE SIGNS AND BARRICADES THE FIRST DAY ANY WORK IS PERFORMED OR AT THE TIME HE MOVES ANY MATERIAL OR EQUIPMENT ON TO THE PROJECT, WHICH EVER IS FIRST. HE SHALL MAINTAIN THESE SIGNS THROUGHOUT THE LIFE OF THE PROJECT UNTIL FINAL ACCEPTANCE OF THE CONTRACT, AT WHICH TIME THEY SHALL BE REMOVED.

WHENEVER SURFACING WORK IS BEING PERFORMED ON THE ROADWAY AND ONE-WAY TRAFFIC IS BEING MAINTAINED THROUGH THE SECTION BEING SURFACED, THE STANDARD SIGNS SHALL BE PLACED AND, ALSO, PLACED AT EACH END OF THE SECTION OF ROAD BEING SURFACED EXCEPT IN CASES WHERE TRAFFIC VIOLATIONS IS LIGHT AND HIGH SPEEDS DO NOT PREVAIL, OR IN CASES WHERE THE SECTION OF ROAD BEING SURFACED IS NOT MORE THAN 100 FEET IN LENGTH AND THE SIGNS ARE CLEARLY VISIBLE FOR A DISTANCE OF 500 FEET.

THE DEPARTMENT WILL ERECT AND MAINTAIN PROPER SIGNS IN ACCORDANCE WITH THE MANUAL FOR UNIFORM CONTROL DEVICES ON ALL DETOURS OR TEMPORARY ROUTES THAT THE CONTRACTOR IS NOT REQUIRED TO MAINTAIN. THE CONTRACTOR WILL BE REQUIRED TO PROVIDE AND MAINTAIN PROPER DETOUR SIGNS AT AND ALONG ALL DETOURS FOR WHICH HE IS RESPONSIBLE.

THE CONTRACTOR WILL BE REQUIRED TO MAINTAIN AND RELOCATE, WHERE NECESSARY, ALL REGULATORY, WARNING AND GUIDE SIGNS IN PLACE, OR THOSE THAT MAY BE ERECTED BY THE DEPARTMENT, WITHIN THE LIMITS OF HIS CONTRACT.

BETWEEN THE HOURS OF SUNSET AND SUNRISE, THE CONTRACTOR WILL BE RESPONSIBLE FOR PROVIDING AND MAINTAINING TWO FLARES AT EACH BARRICADE, "ROAD CLOSED" SIGN, OBSTRUCTION OR AT SUCH OTHER POINTS AS ARE NECESSARY TO PROTECT THE TRAVELING PUBLIC.

ALL SIGNS SHALL BE REFLECTORIZED EXCEPT THOSE TEMPORARY SIGNS THAT ARE USED ONLY DURING NIGHTTIME HOURS. DRAWINGS SHOWING SIZES OF SIGNS, LETTERS AND MATERIALS ARE DETAIL HEREON. ALL SIGNS SHALL HAVE BLACK LETTERS ON A WHITE BACKGROUND EXCEPT THE "ROAD WORK" (W-26), "BEGIN CONSTRUCTION" (C-5), "END OF CONSTRUCTION" (C-8) AND "ROAD CONSTRUCTION" (C-7) SIGNS WHICH SHALL HAVE A YELLOW BACKGROUND.

THE "ROAD CONSTRUCTION - TRAFFIC MAINTAINED" (C-7) SIGN SHALL BE MOUNTED ON A BARRICADE ON EACH SIDE OF THE INTERSECTION FACING TRAFFIC AT ALL INTERSECTION ROAD INTERSECTIONS. ON MAJOR ROUTES BEING CONSTRUCTED, THIS BARRICADE SHALL BE ON BOTH SIDES OF THE ROAD AT THE EXTREME LIMITS OF THE PROJECT BUT THE SIGN MAY BE OMITTED ON THE BARRICADE ON THE LEFT SIDE OF ROAD FACING TRAFFIC. THE "END OF CONSTRUCTION" (C-8) SIGN MAY BE PLACED ON THE BACK OF THIS BARRICADE INSTEAD OF ON A POST.

WHEN A BRIDGE IS UNDER CONSTRUCTION AND TRAFFIC IS MAINTAINED, THE WORD "BRIDGE" SHALL BE SUBSTITUTED FOR "ROAD" ON THE "ROAD CONSTRUCTION - TRAFFIC MAINTAINED" SIGN AND THE SIGN ERECTED IN A LIKE MANNER.

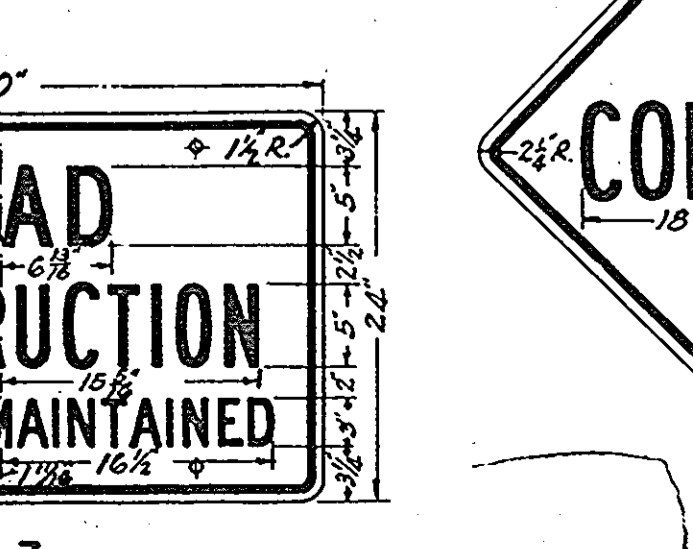
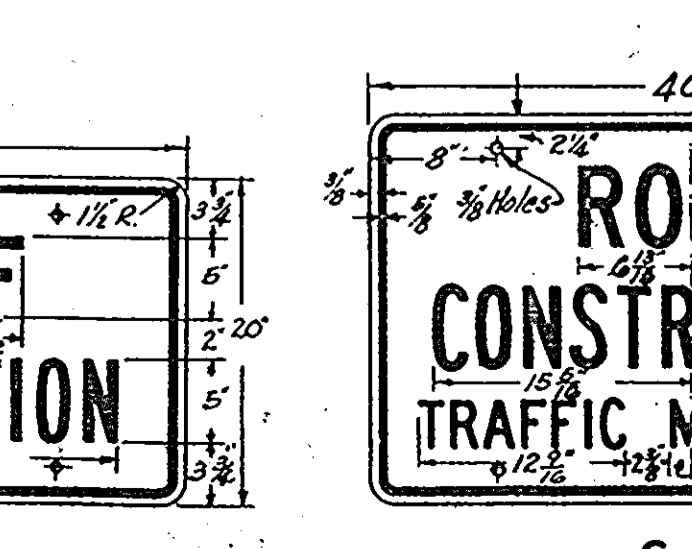
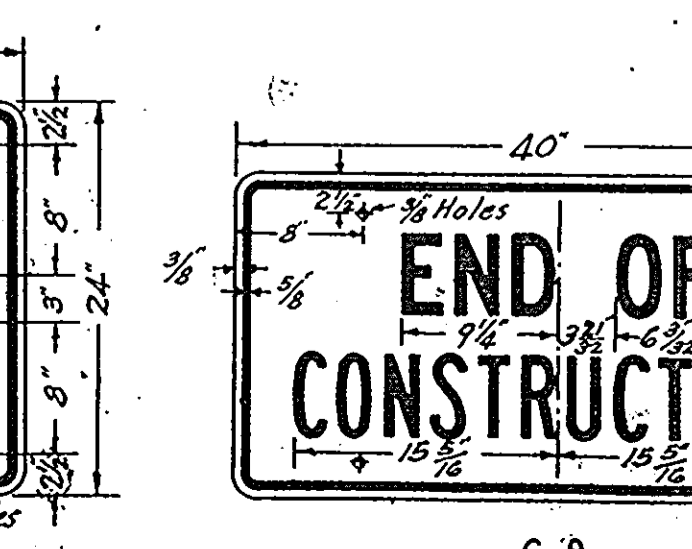
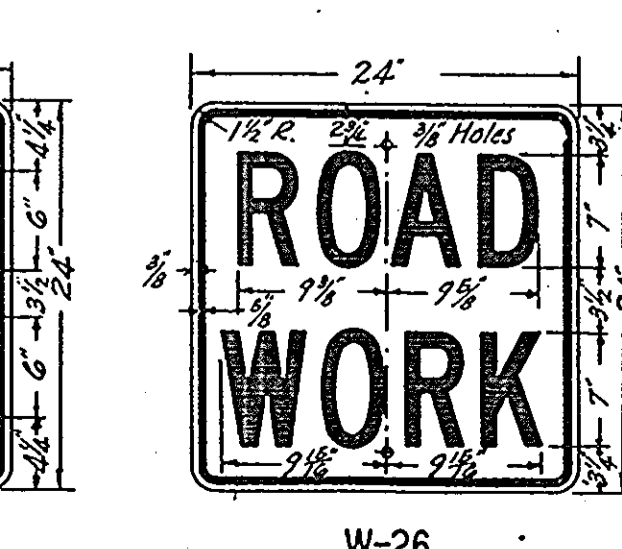
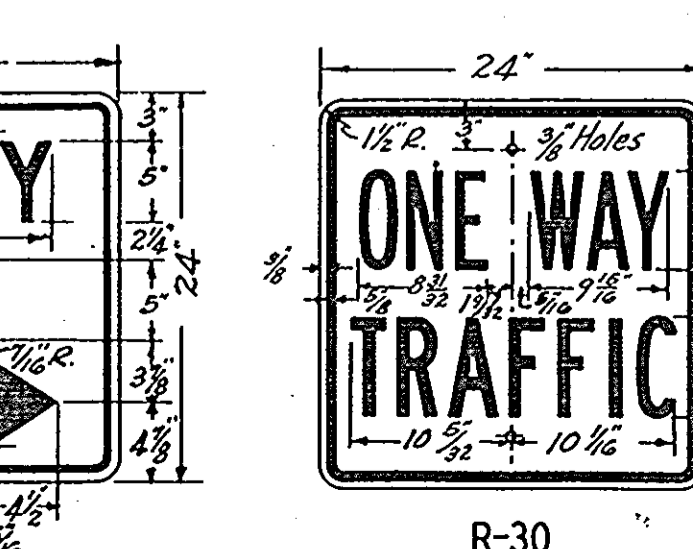
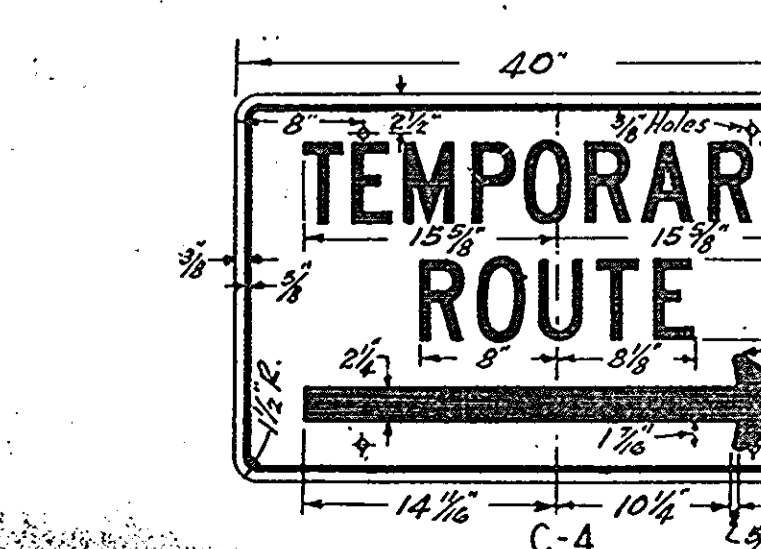
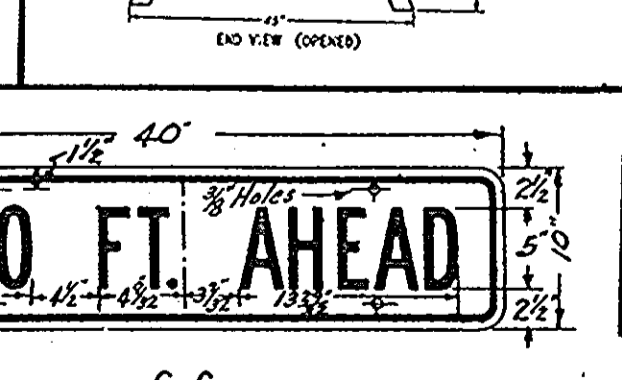
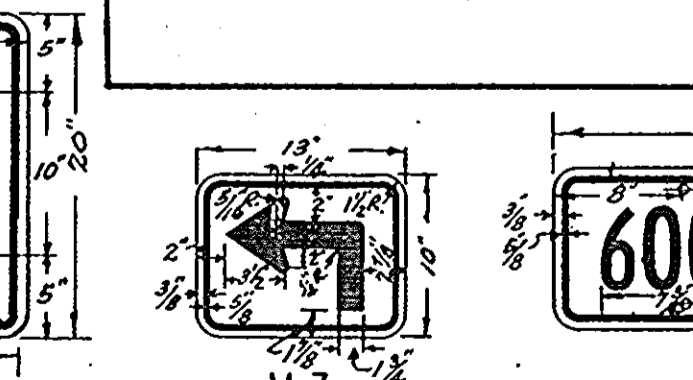
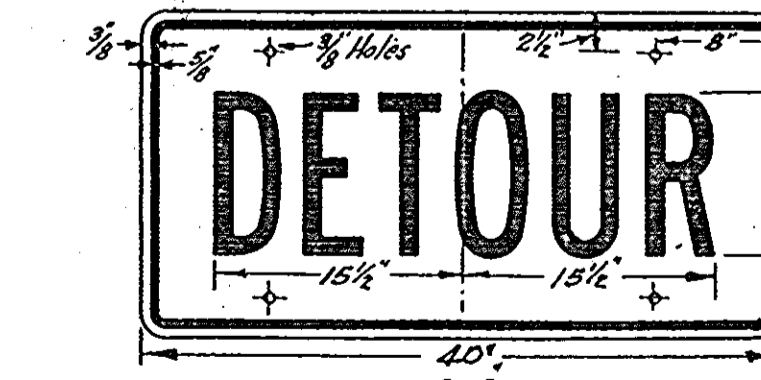
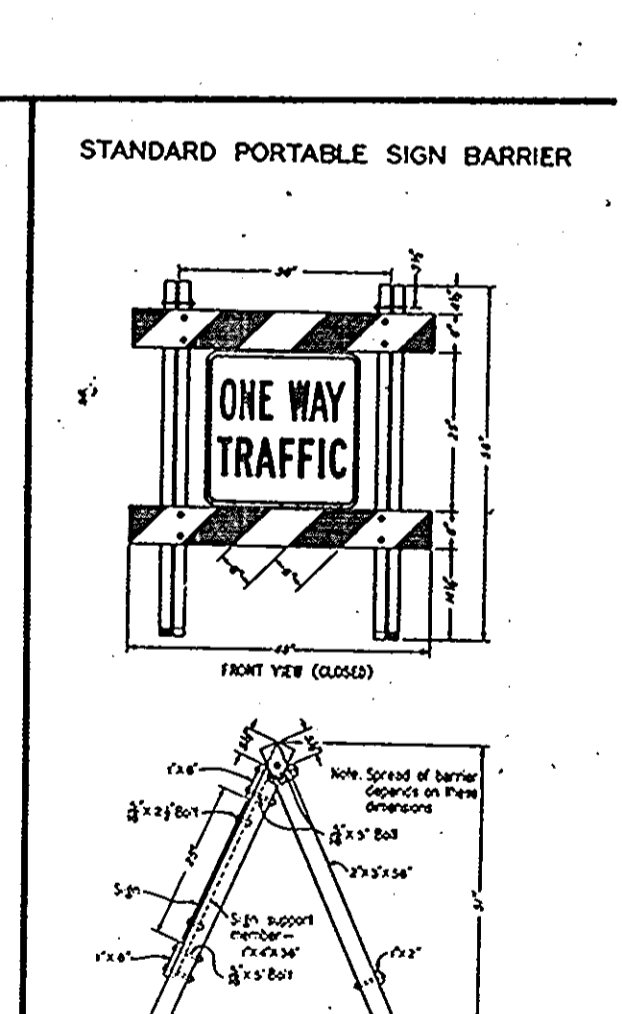
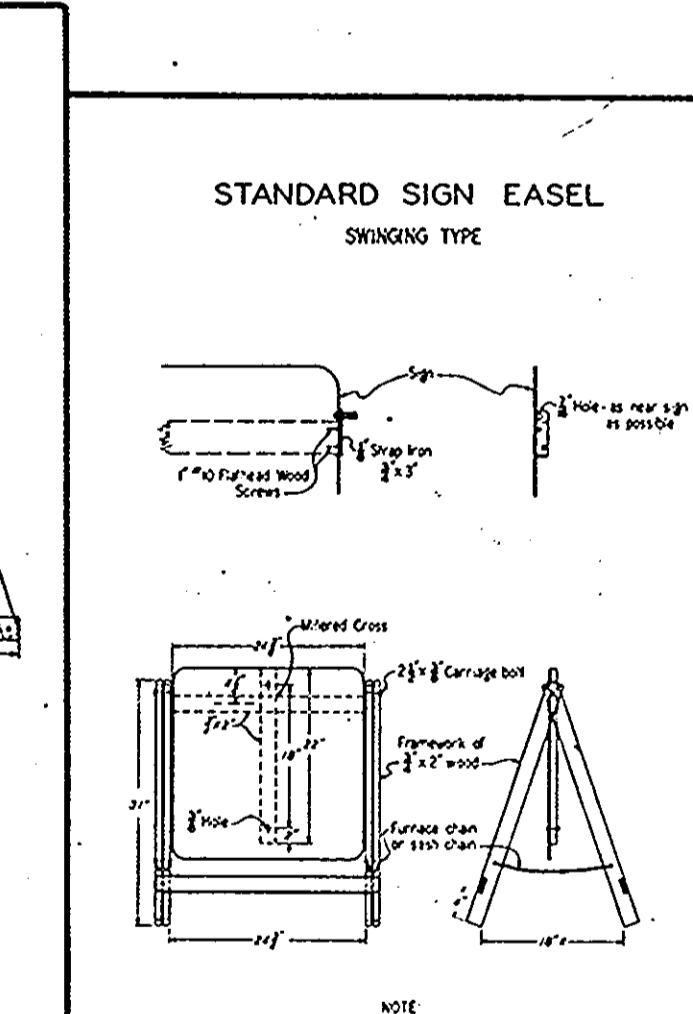
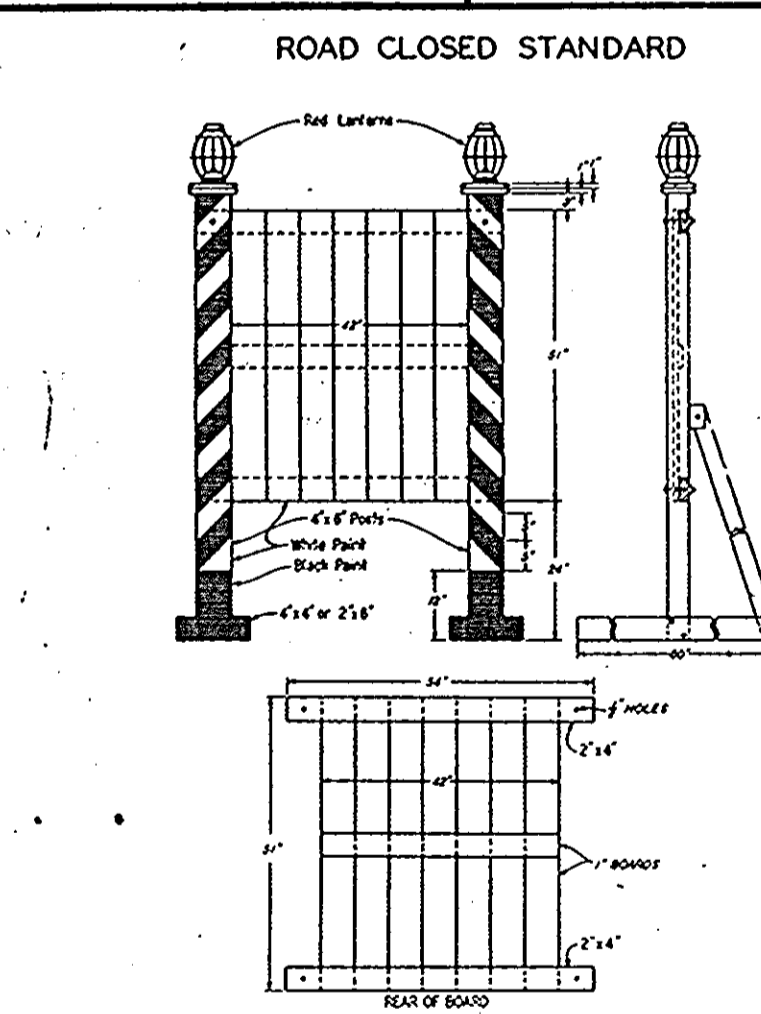
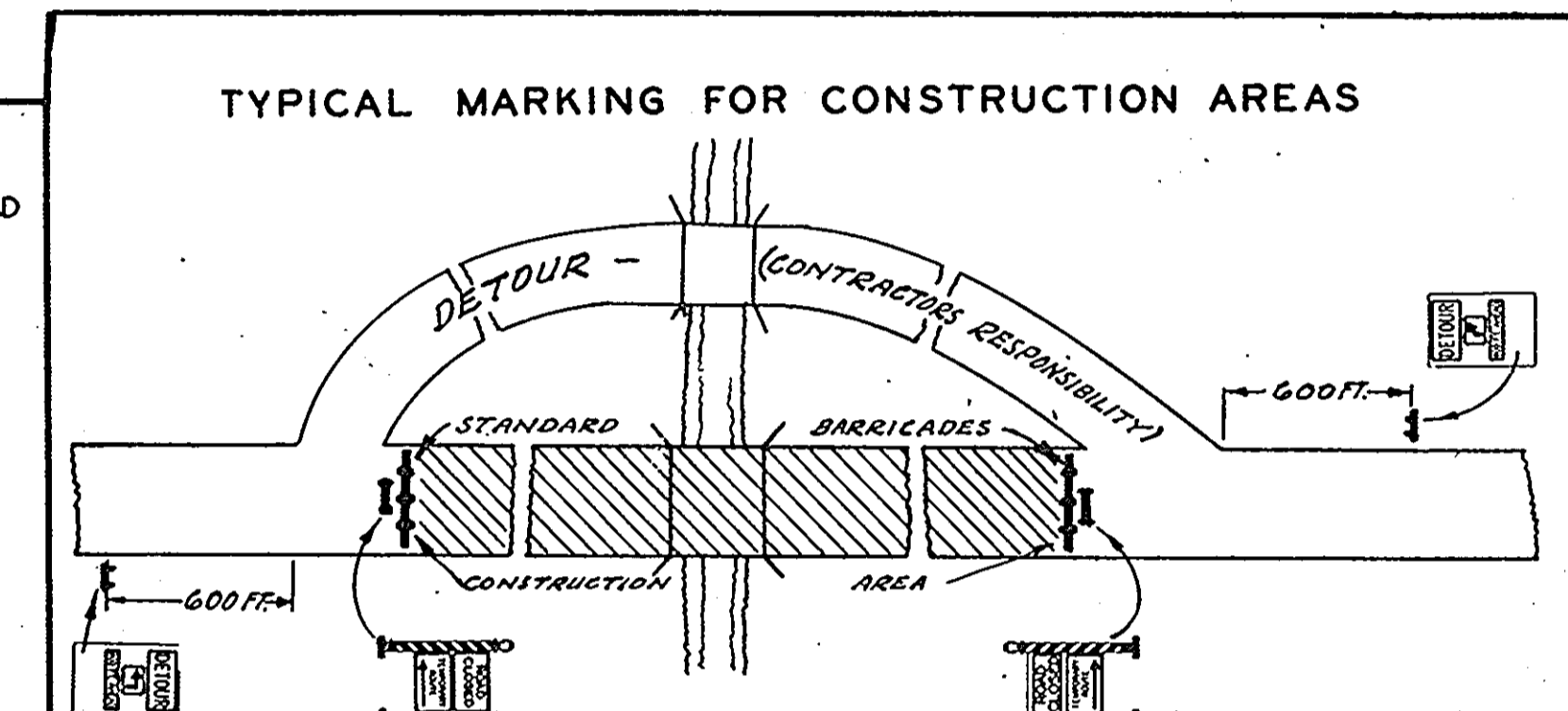
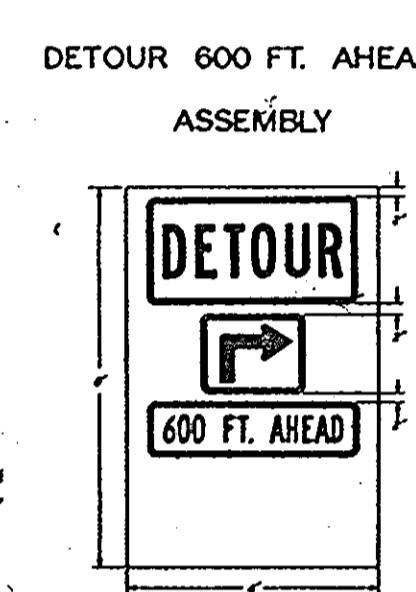

DRAWINGS SHOWING DIMENSIONS OF SIGNS

DETAILS SHOWING STANDARD SIGNS, BARRIERS, LIGHTS, AND BARRICADES TO BE FURNISHED, ERECTED, AND MAINTAINED BY THE CONTRACTOR WHERE APPLICABLE ON ALL ROAD OR BRIDGE CONTRACTS

APPROVED: *S. P. Bowman* STATE HIGHWAY ENGINEER DATE: 12/14/68

FED. ROAD DIST. NO.	STATE	COUNTY	DOCKET NO.	PROJECT NO.	ROAD NO.	SHEET NO.	TOTAL SHEETS
3.	S.C.	MARION	34282		8-3	7	8

PLAN	DATE
SURVEYED	
PLOTTED	
ALIGNMENT CHECKED	
RT. OF WAY CHECKED	
NOTE BOOK NO.	

PROFILE	DATE
SURVEYED	
PLOTTED	
GRADES CHECKED	
STRUCTURE NOTATIONS CHECK	
NOTE BOOK NO.	

Marion Co
Sta. in Sellars

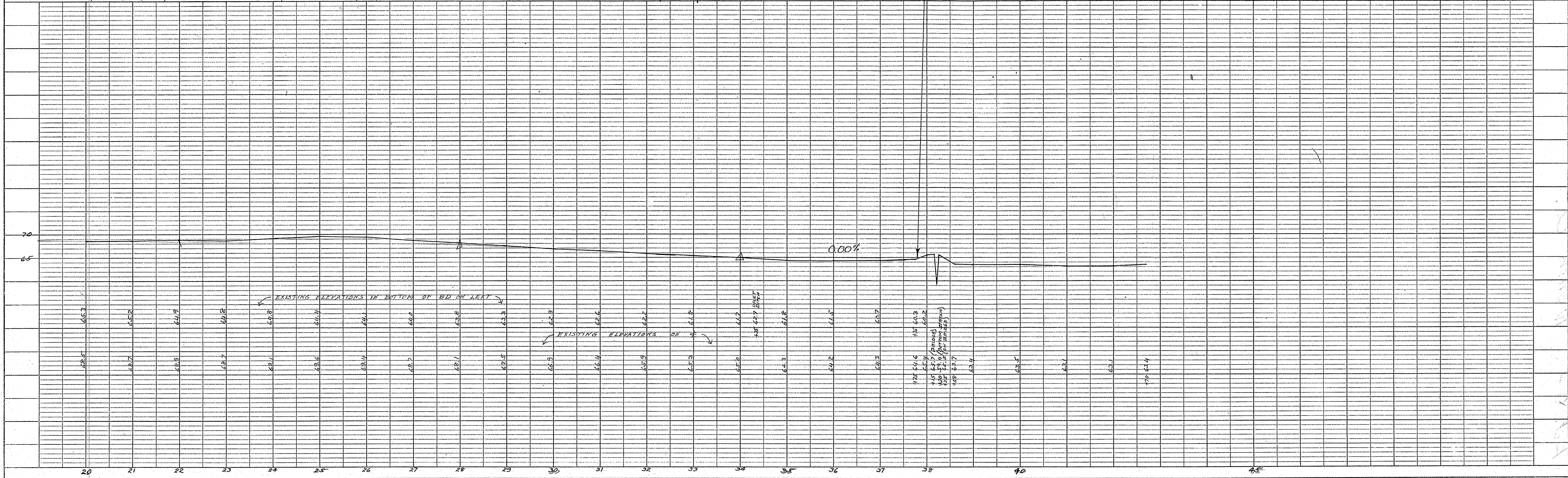
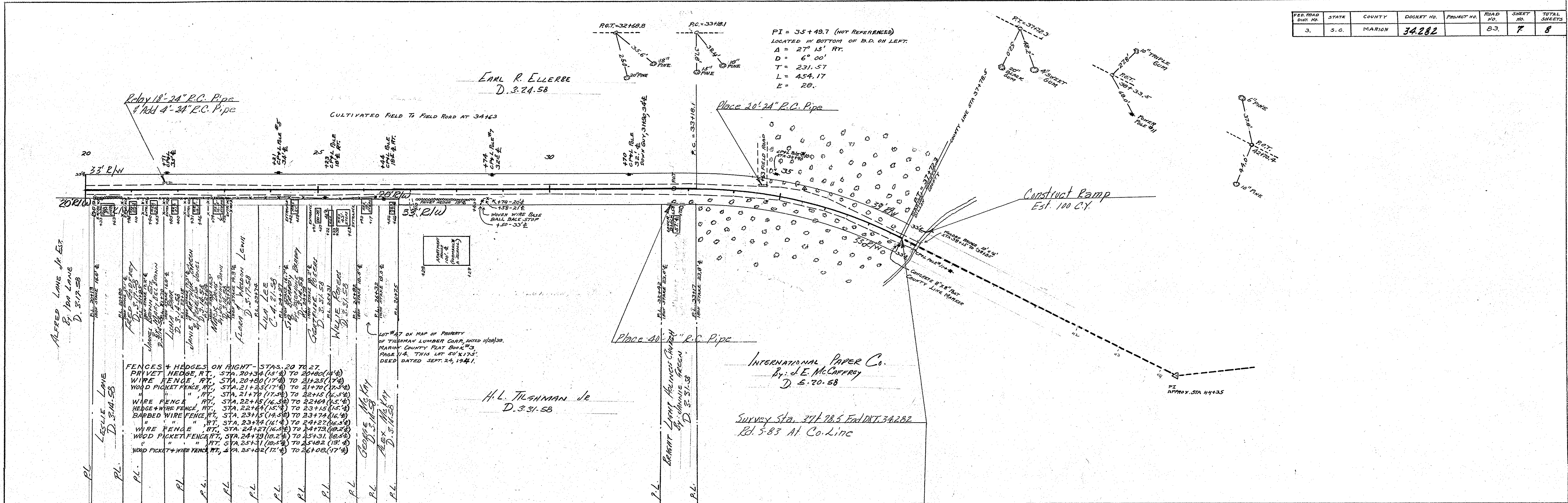

FED. ROAD DIV. NO.	STATE	COUNTY	DOCKET NO.	PROJECT NO.	DATE	SHEET NO.	TOTAL SHEETS
3	S. C.	MARION	34,282		5-195 5-196	8	8

BANK STREET RD. 5-195
RD. 5-196

PLAN	SURVEYED	DATE
	PLOTTED	
NOTE BOOK NO.	ALIGNMENT CHECKED	
	RT. OF WAY CHECKED	

PROFILE	SURVEYED	DATE
	PLOTTED	
NOTE BOOK NO.	GRADES CHECKED	
	STRUCTURE NOTATIONS CHECKED	

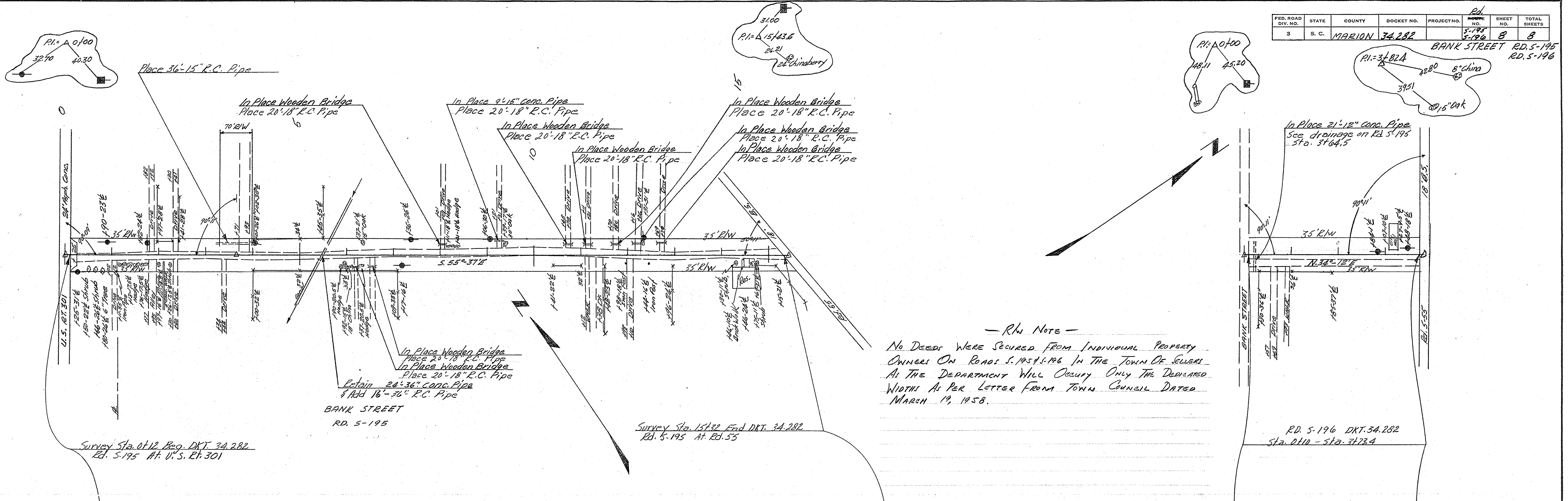

- RW Note -
 No Deeds were secured from individual property owners on roads 5-195 & 5-196 in the town of Sellers. As the Department will occupy only the dedicated width as per letter from town council dated March 19, 1958.

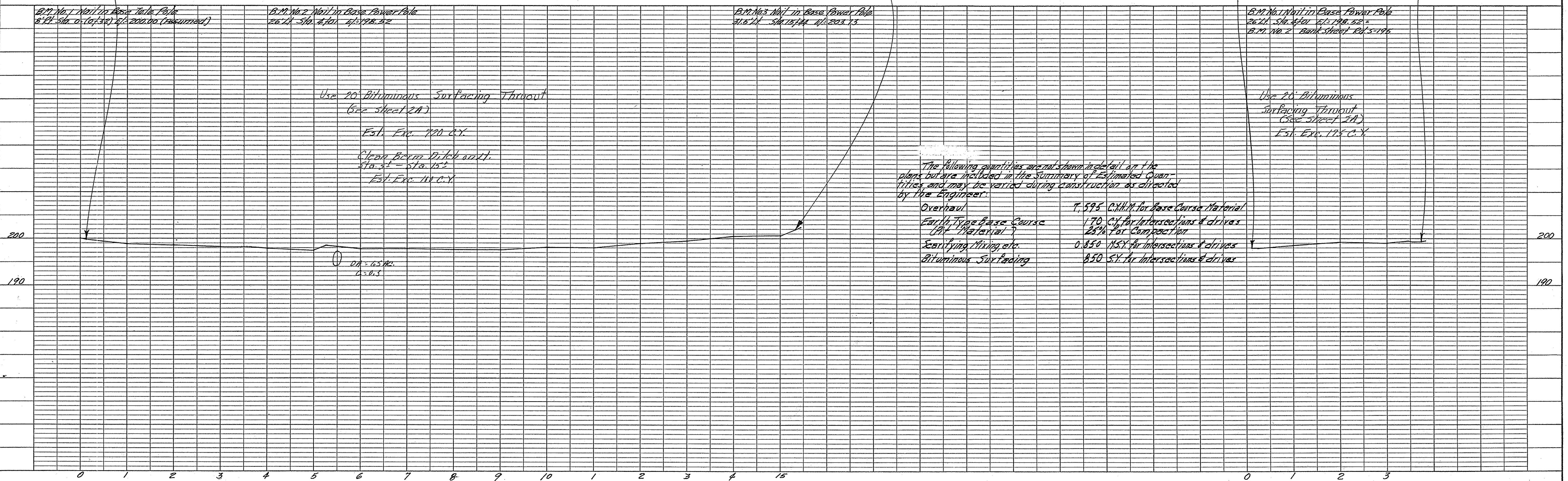

The following quantities are not shown in detail on the plans but are included in the Summary of Estimated Quantities and may be varied during construction as directed by the Engineer:

Overhaul	7,575 C.Y.H.M. for Base Course Material
Earth Type Base Course (All Material)	170 C.Y. for Intersections & drives 25% for Compaction
Earth Type Mixing etc.	0.850 M.S.Y. for Intersections & drives
Bituminous Surfacing	850 S.Y. for Intersections & drives

Marion Co.
 Sts. In Sellers
 Rd. 5-195
 Rd. 5-196