

REFERENCES:

1. CODE OF LAWS OF SOUTH CAROLINA 1976; VOLUME 1A; CHAPTER 3 BOUNDARIES OF EXISTING COUNTIES; SEC. 4-3-120 CHESTER COUNTY AND SEC. 4-3-530 YORK COUNTY.
2. COMMUNICATION PURSUANT TO A RESOLUTION OF THE LEGISLATION OF THE STATE OF SOUTH CAROLINA TO RUN AND MARK THE DIVIDING LINE BETWEEN YORK AND CHESTER COUNTIES DATED NOVEMBER 14, 1797; COMMISSIONERS J.O. BROWN AND ALEXANDER MOORE.
3. THE 1868 TOWNSHIP LAW AND YORK COUNTY, SOUTH CAROLINA, BY ROBERT JERALD L. WEST; BROAD RIVER BASIN HISTORICAL SOCIETY; DATED 1996.
4. PLAT SHOWING THE AREA OF THAT PORTION OF CHESTER COUNTY, SOUTH CAROLINA PROPOSED TO BE ANNEXED TO YORK COUNTY BY H.C. BAILEY, CHAS. HENDRIX AND S.R. BROWN; DATED NOVEMBER 27, 1920.
5. MAP OF SCHOOL DISTRICT #15, YORK COUNTY, SO. CARO.; SURVEY BY H.E. HOOD IN 1915; PLATTED 03-31-1915 BY J.L. STACY.
6. MAP SCHOOL DISTRICT #16, YORK COUNTY, S.C.; SURVEYED NOV. 11-12, 1914; BY J.L. STACY.
7. MAP SCHOOL DISTRICT #13, YORK COUNTY, SOUTH CAROLINA; SURVEYED NOV. 5-6-7, 1914; BY J.L. STACY.
8. MAP OF SCHOOL DISTRICT #14, YORK COUNTY S.C.; SURVEY BY H.H. WHITE 1912; PLAT BY J.L. STACY MAY, 1914.
9. MAP; SCHOOL DISTRICT #5, YORK COUNTY S.C.; SURVEYED BY H.H. WHITE, JULY, 1912; PLAT BY J.L. STACY, MARCH, 1914.
10. MAP OF SCHOOL DISTRICT #46 YORK COUNTY, SOUTH CAROLINA; NORTH AND WEST SIDES RUN BY H.H. WHITE, SOUTH AND EAST NOT RUN; PLATTED JUNE 1915 BY J.L. STACY.
11. MAP OF THE ESTATE OF JNO. O. DARBY; SURVEYED NOV. 22, 23, & 24, 1916; BY T.H. HARDIN; CHESTER CO., SC DEED BOOK 149, PAGE 793.
12. PLAN OF THE CATAWBA AND BROAD RIVERS WITH THEIR WATERS AND THE PROPOSED BOUNDARY LINES BETWEEN NORTH & SOUTH CAROLINA.
13. SURVEY OF THE DISTRICT OF CHESTER BY CHARLES BOYD; DATED OCTOBER 30, 1818.

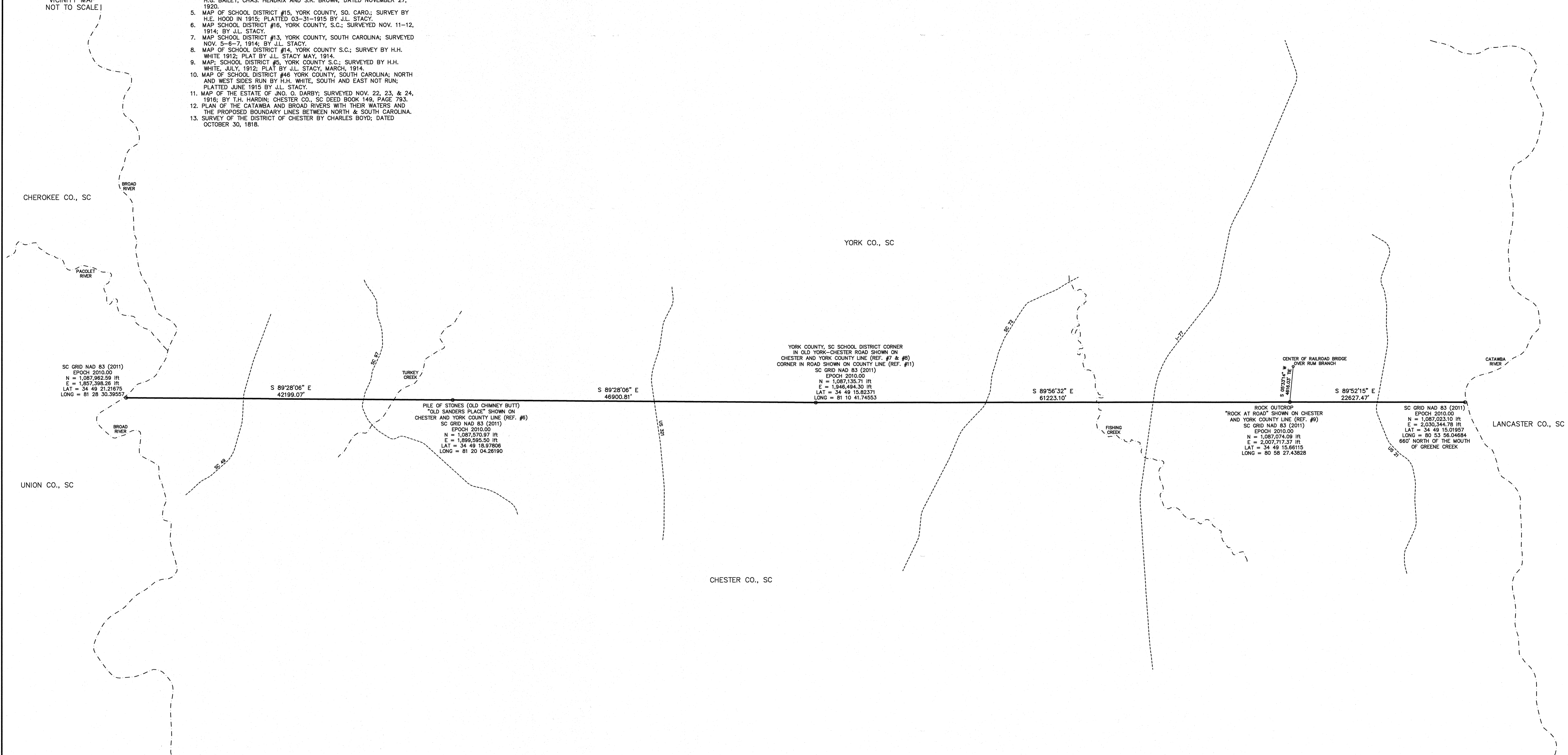
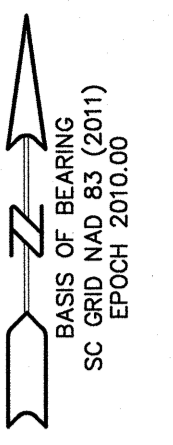

LEGEND

	COUNTY LINE AS SURVEYED
	TIE LINE
	APPROXIMATE ROAD
	APPROXIMATE RIVER

PRELIMINARY PLAT
NOT FOR RECORDATION,
CONVEYANCES OR SALES

Re-Establishment of the Chester County and York County Boundary from the Broad River East to the Catawba River
CHESTER COUNTY, S.C.
YORK COUNTY, S.C.

SURVEY FOR:
 SOUTH CAROLINA GEODETIC SURVEY
 5 GEOLOGY ROAD
 COLUMBIA, SC 29212

DATE: 12-27-2017
 SCALE: 1" = 6000'
 JOB NO.: 170246.000
 ACAD FILE: Scgrid2011.dwg

COMPUTED BY: RAP
 DRAWN BY: RAP
 CHECKED BY: FAR

SCALE IN FEET
 0 6000 12000 18000

CESI
 Civil - Geotechnical - Surveying
 45 SPRING STREET SW CONCORD (704) 786-5404
 CONCORD, NC 28025 FAX (704) 786-7454
 S.C. CERTIFICATE OF AUTHORIZATION NO. C00591

© CSI 2017