

FED. ROAD DIV. NO.	STATE	COUNTY	DOCKET NO.	PROJECT NO.	ROUTE NO.	SHEET NO.	TOTAL SHEETS
3	S. C.	WILLIAMSBURG	45.241		726	1	57

INDEX OF SHEETS

Sheet No. 1 Title Sheet
 " " 1-A Moving Items
 " " 2 Typical Sections
 " " 3 Standard Type Intersections
 " " 4 Superelevation Standard
 " " 5-18 Plan and Profile - Sta. 0+13.0 to Sta. 396+00.0
 " " 19 Triple 8'x6'x28' R. C. Box Culvert - Sta. 118+50.0
 " " 19-A Details of Timber Cut-off Walls.
 " " 20-56 Cross Sections - Sta. 0+13.0 to Sta. 396+00.0
 " " 57 Foundation details for Box Culvert.

**SOUTH CAROLINA
 STATE HIGHWAY DEPARTMENT
 COLUMBIA**

**PLAN AND PROFILE OF PROPOSED
 STATE HIGHWAY**

DOCKET NO. 45.241

ROUTE 726 ROAD 39

WILLIAMSBURG COUNTY

FROM RT. 175 TO FLORENCE COUNTY LINE

SCALES: PLAN AND PROFILE 1 INCH=100 FEET HORIZONTAL: 1 INCH=10 FEET VERTICAL

SUMMARY OF ESTIMATED QUANTITIES

DESCRIPTION	QUANTITY	UNIT
EARTH WORK		
Clearing and Grubbing within Roadway	All Necessary	L.S.
Clearing and Grubbing of Borrow and Material Pits	4	Acres
Common Excavation	44,838	C.Y.
Overhaul	145,000	C.Y./M.
Selected Material for Shoulders	3,824	C.Y.
BASE COURSE		
Earth Type Base Course (Pit Material)	20,047	C.Y.
Scarifying, Mixing, Shaping and Reshaping	35,583	W.S.Y.
Additional Scarifying, Mixing, Reshaping, Shaping and Reshaping	32,000	W.S.Y.
SURFACING		
Bituminous Surfacing (Inverted Penetration with Seal)	91,184	S.Y.
STRUCTURES		
Class "A" Concrete	68.88	C.Y.
Reinforcing Steel	11,365	Lbs.
Untreated Timber Cut-off Walls	82	L.F.
18 in. R. C. Pipe	180	L.F.
24 in. R. C. Pipe	37	L.F.
30 in. R. C. Pipe	80	L.F.
36 in. R. C. Pipe	52	L.F.
42 in. R. C. Pipe	104	L.F.
15 in. Relaid Pipe	78	L.F.
18 in. Relaid Pipe	163	L.F.
24 in. Relaid Pipe	28	L.F.
36 in. Relaid Pipe	42	L.F.
INCIDENTALS		
Rip Rap	45	Tons

See Sheet No. 1-A for Moving Items and Fences

EQUALITY-TIE ONLY:-
 STA. 0+00.0 DOCKET NO. 45.241=
 STA. 845+29.4 N. R. H. PROJ. NO. 326

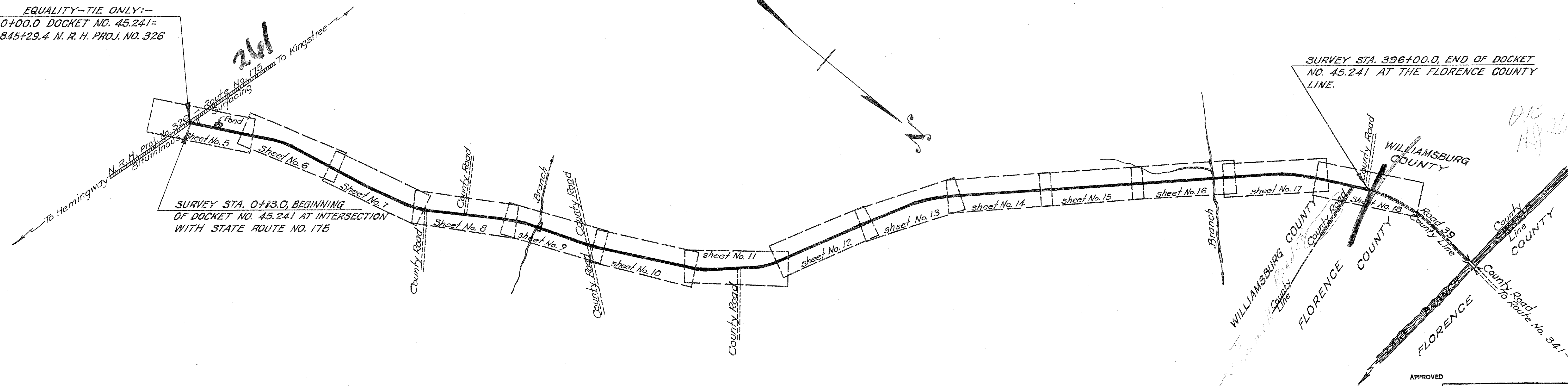

CONVENTIONAL SIGNS

State Line	Trolley Poles	•••••
County Line	Power Poles	•••••
City or Town Limits	Telephone or Telegraph Poles	•••••
Property Line	Marsh	•••••
Fence	Trees	•••••
Retaining Wall	Brush	•••••
Existing Road	Stumps	•••••
℄ and R.O.W. Lines of	Buildings	•••••
Proposed Road	Bridge	•••••
Railroad	Concrete Box Culvert	•••••
Levee or Embankment	Pipe Culvert	•••••
Guard Rail	Drop Inlet and Culvert	•••••
Point of Intersection (P. I.)	Hub on Center Line	•••••

LEGEND

PROPOSED PROJECT	—————
OTHER ROADS	-----

LAYOUT
 Scale: 1 inch = 1600 feet

Net Length of Roadway	=	7.493	Miles
Net Length of Bridges	=	0.005	Miles
Net Length of Project	=	7.498	Miles
Length of Exceptions	=	0.000	Miles
Gross Length of Project	=	7.498	Miles

Equalities in Stationing
 175+04.9 = 174+99.0

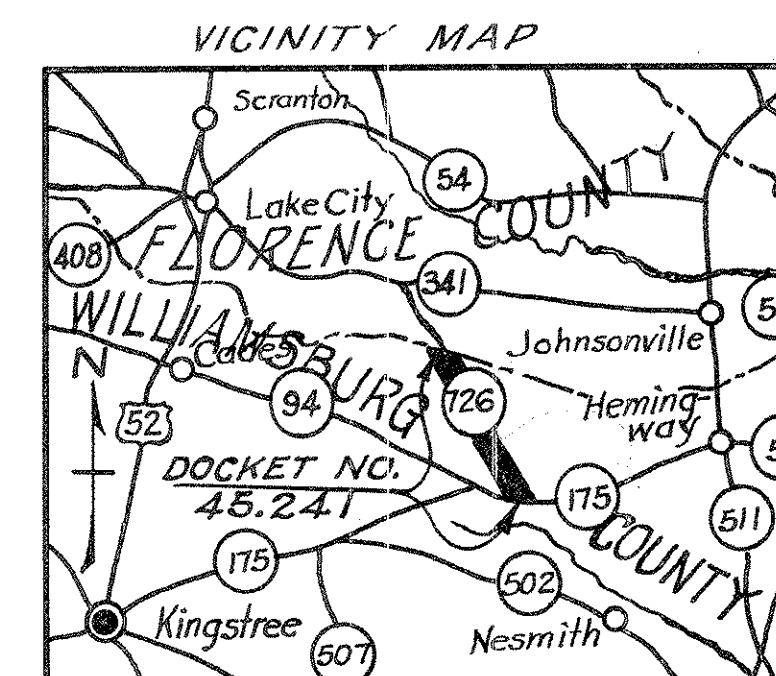

Note: All workmanship and material on this project to conform with South Carolina State Highway Department Standard Specifications for Highway Construction dated March 15th 1939, as approved by the Administrator, Federal Works Agency.

APPROVED
 C. R. McMillan
 STATE HIGHWAY ENGINEER
 DATE: 12-28-46

RECOMMENDED FOR APPROVAL
 DISTRICT ENGINEER
 PUBLIC ROADS ADMINISTRATION
 FEDERAL WORKS AGENCY

APPROVED
 DIVISION ENGINEER
 PUBLIC ROADS ADMINISTRATION
 FEDERAL WORKS AGENCY

Fed. Road Dist. No.	State	County	Docket No.	P.A. No.	Sheet No.	Total Sheets
3	S.C.	Wmnsburg	45,241	726	18	57

DATE: 11-2-47
 DRAWN BY: J. J. THOMPSON
 CHECKED BY: J. J. THOMPSON
 SCALE: AS SHOWN

DATE: 11-2-47
 DRAWN BY: J. J. THOMPSON
 CHECKED BY: J. J. THOMPSON
 SCALE: AS SHOWN

