

- NOTES:
1. TRAVERSES ADJUSTED BY THE LEAST SQUARES ADJUSTMENT METHOD.
  2. ALL DISTANCES ARE HORIZONTAL GRID DISTANCES.
  3. SC GRID NAD 83 (2011) EPOCH 2010.00 BASIS OF BEARING DERIVED FROM SCGS NETWORK RTK (HORIZONTAL POSITIONAL ACCURACY = 0.07') USING GEOD MODEL GEOID12B. UNITS ARE INTERNATIONAL FEET.

- REFERENCES:
1. MAP SHOWING THE "BOUNDARY LINE BETWEEN THE PROVINCE OF SOUTH CAROLINA AND THE CHEROKEE INDIAN COUNTRY" DATED MAY 8, 1766.
  2. CODE OF LAWS OF SOUTH CAROLINA 1976; VOLUME 1A; 4-3-10 AND 4-3-40.
  3. "GENERAL DESCRIPTIVE MAP OF ANDERSON COUNTY, S.C." BY S.M. PEGG; DATED 1877.
  4. ALL DEEDS AND MAPS REFERENCED IN THE MONUMENT DESCRIPTIONS SHOWN ON THIS MAP.

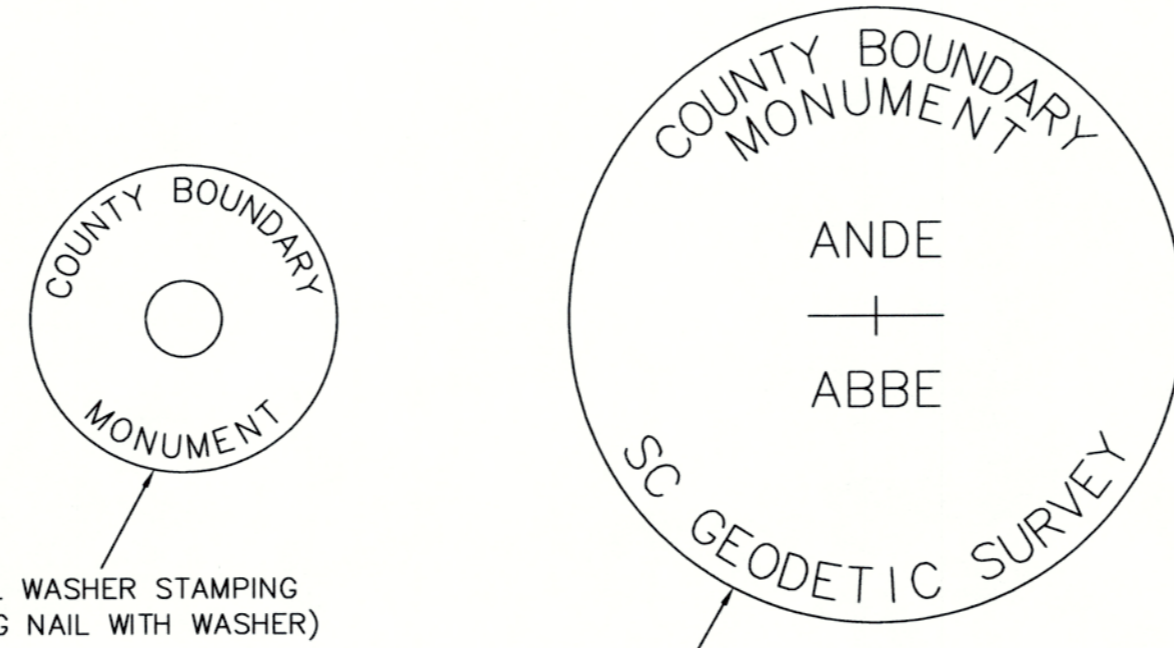

TYPICAL WASHER STAMPING (SET #8 REBAR WITH WASHER)

TYPICAL DISK STAMPING (SET #8 REBAR WITH DISK)

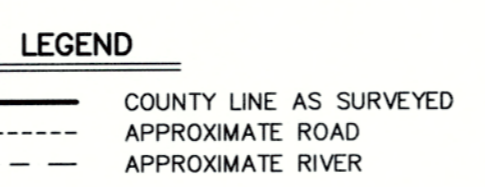
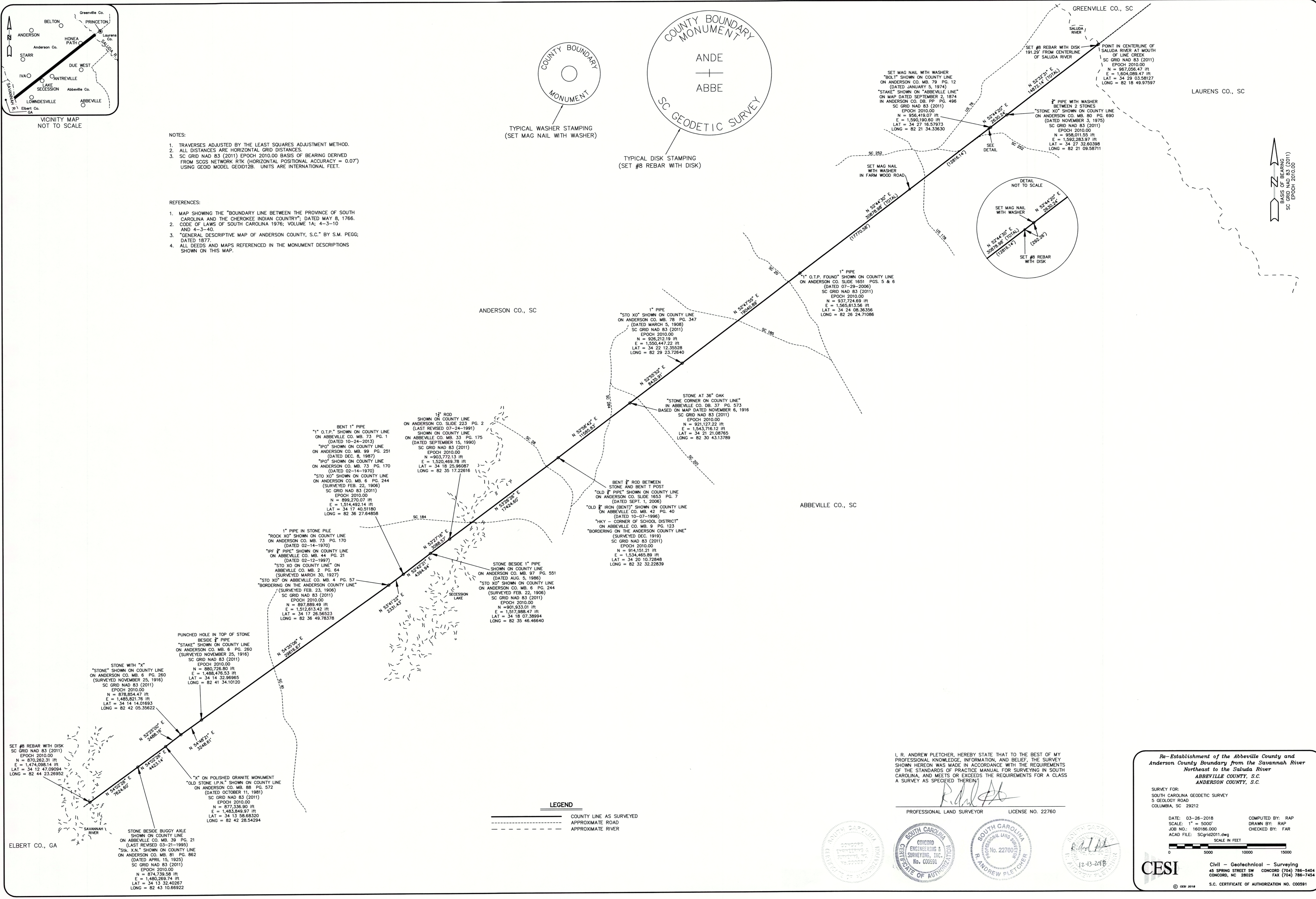

I, R. ANDREW FLETCHER, HEREBY STATE THAT TO THE BEST OF MY PROFESSIONAL KNOWLEDGE, INFORMATION, AND BELIEF, THE SURVEY SHOWN HEREON WAS MADE IN ACCORDANCE WITH THE REQUIREMENTS OF THE STANDARDS OF PRACTICE MANUAL FOR SURVEYING IN SOUTH CAROLINA, AND MEETS OR EXCEEDS THE REQUIREMENTS FOR A CLASS A SURVEY AS SPECIFIED THEREIN.

PROFESSIONAL LAND SURVEYOR LICENSE NO. 22760



Re-Establishment of the Abbeville County and Anderson County Boundary from the Savanah River Northeast to the Saluda River  
**ABBEVILLE COUNTY, S.C.**  
**ANDERSON COUNTY, S.C.**

SURVEY FOR:  
 SOUTH CAROLINA GEODETIC SURVEY  
 5 GEOLOGY ROAD  
 COLUMBIA, SC 29212

DATE: 03-26-2018  
 SCALE: 1" = 5000'  
 JOB NO.: 160186.000  
 ACAD FILE: SCGrid2011.dwg

COMPUTED BY: RAP  
 DRAWN BY: FAR  
 CHECKED BY: FAR

CESI Civil - Geotechnical - Surveying  
 45 SPRING STREET SW CONCORD (704) 786-5444  
 CONCORD, NC 28025 FAX (704) 786-7424  
 S.C. CERTIFICATE OF AUTHORIZATION NO. C00591