

COUNTY LINE MONUMENT SUMMARY TABLE – NAD 83 (2011 Adjustment)

Monument	Northing (Ft.)	Easting (Ft.)	Description	Latitude (North)	Longitude (West)
	460717.00	2035623.09	IPF 5RBR-PROP CORNER	33.099539	-80.883665
	461100.19	2034661.76	IPF 5RBR-PROP CORNER	33.100596	-80.886803
'D'-9'	460841.74	2016070.52	COUNTY MONUMENT DISK	33.099926	-80.947518
'E'	463010.04	2019468.98	COMPUTED POINT	33.105881	-80.936415
'F'	446461.60	2028806.93	CMF 4X4	33.060375	-80.905967
'G'	446745.59	2030736.53	IPF 0.5 OT	33.061150	-80.899668
'H'	446772.17	2031207.56	IPF 0.5 OT	33.061222	-80.898130
'I'	446841.412	2031693.45	COUNTY MONUMENT DISK	33.061411	-80.896544
'J'	458653.48	2037641.76	COUNTY MONUMENT DISK	33.093861	-80.877081
'K'	459612.20	2036997.90	COUNTY MONUMENT DISK	33.096498	-80.879180
'L'	460328.91	2036414.73	COUNTY MONUMENT DISK	33.098470	-80.881081
'M'	461053.43	2034936.82	COUNTY MONUMENT DISK	33.100466	-80.885905
'N'	461166.42	2034272.23	COUNTY MONUMENT DISK	33.100779	-80.888075
'O'	462290.93	2033940.17	COUNTY MONUMENT DISK	33.103871	-80.889156
'P'	463588.94	2034038.45	IPF 1.5 FT	33.107438	-80.888830
'Q'	465358.93	2034295.36	IPF 1 OT	33.112303	-80.887985
'R'	465385.21	2034205.17	COUNTY MONUMENT DISK	33.112375	-80.888279
'S'	467942.42	2033472.93	IPF RBR W/ YELLOW CAP	33.119406	-80.890662
'T'	468248.07	2033439.83	IPF RBR W/YELLOWCAP	33.120246	-80.890769
'T-1'	468494.20	2033292.13	COUNTY MONUMENT DISK	33.120923	-80.891251
'U'	471636.27	2032989.61	COUNTY MONUMENT DISK	33.129561	-80.892228
'U-1'	472878.22	2034936.36	COUNTY MONUMENT DISK	33.132989	-80.885864
'U-2'	479476.72	2045278.61	COUNTY MONUMENT DISK	33.151070	-80.852045
'U-3'	482058.80	2049325.82	COUNTY MONUMENT DISK	33.158151	-80.838808
'U-4'	487176.67	2057347.36	COUNTY MONUMENT DISK	33.172181	-80.812564
'U-5'	488896.38	2059729.32	COUNTY MONUMENT DISK	33.176346	-80.804769
'V'	489173.20	2060476.75	COMPUTED POINT	33.177653	-80.802323

NOTES

1. FOR ALL RELEVANT NOTES TO THIS PLAT, SEE Sht. 1 of 2.
2. FOR LEGEND, SEE Sht. 1 of 2.

LINE TABLE

LINE	BEARING	DISTANCE
L1	N04°19'47"E	1,301.72'
L2	N08°15'32"E	1,788.54'
L3	N73°18'05"W	93.94'
L4	N15°59'14"W	2,659.36'
L5	N06°10'48"W	307.44'
L6	N30°58'02"W	287.05'
L7	N05°29'59"W	3,156.59'

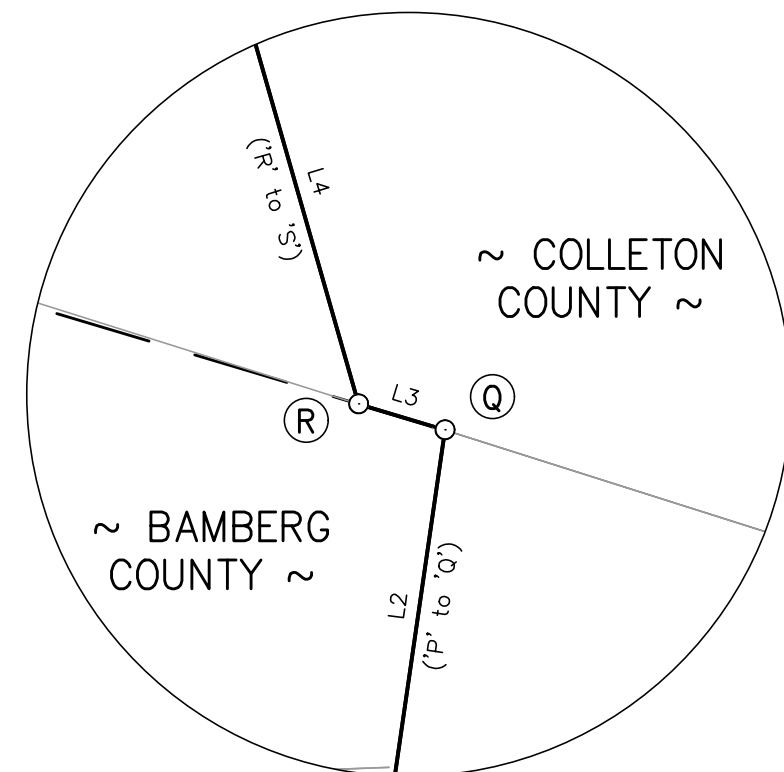

INSET 'B'
(1"=200')

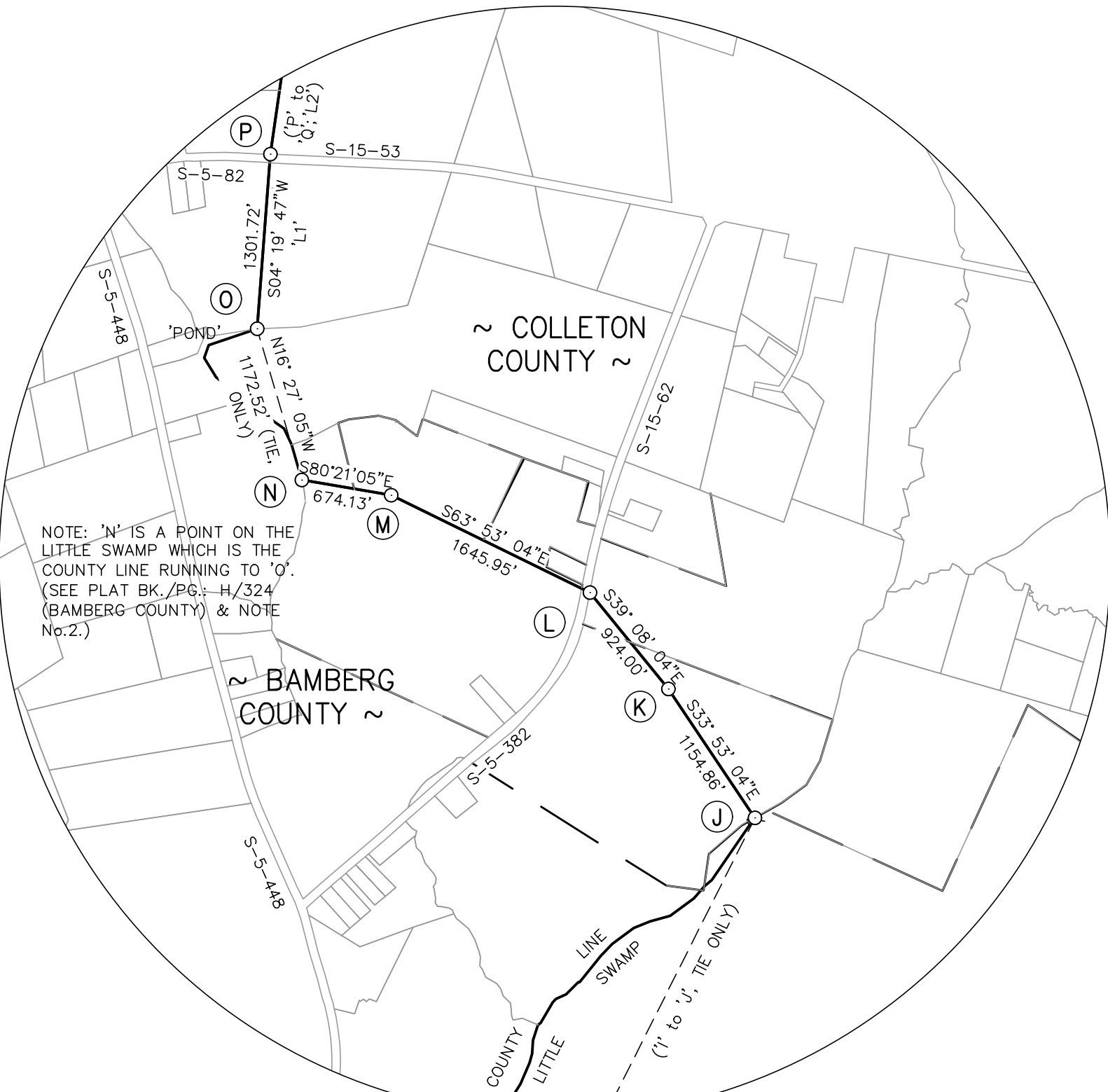

INSET 'A'
(1"=1,000')

Preliminary Draft

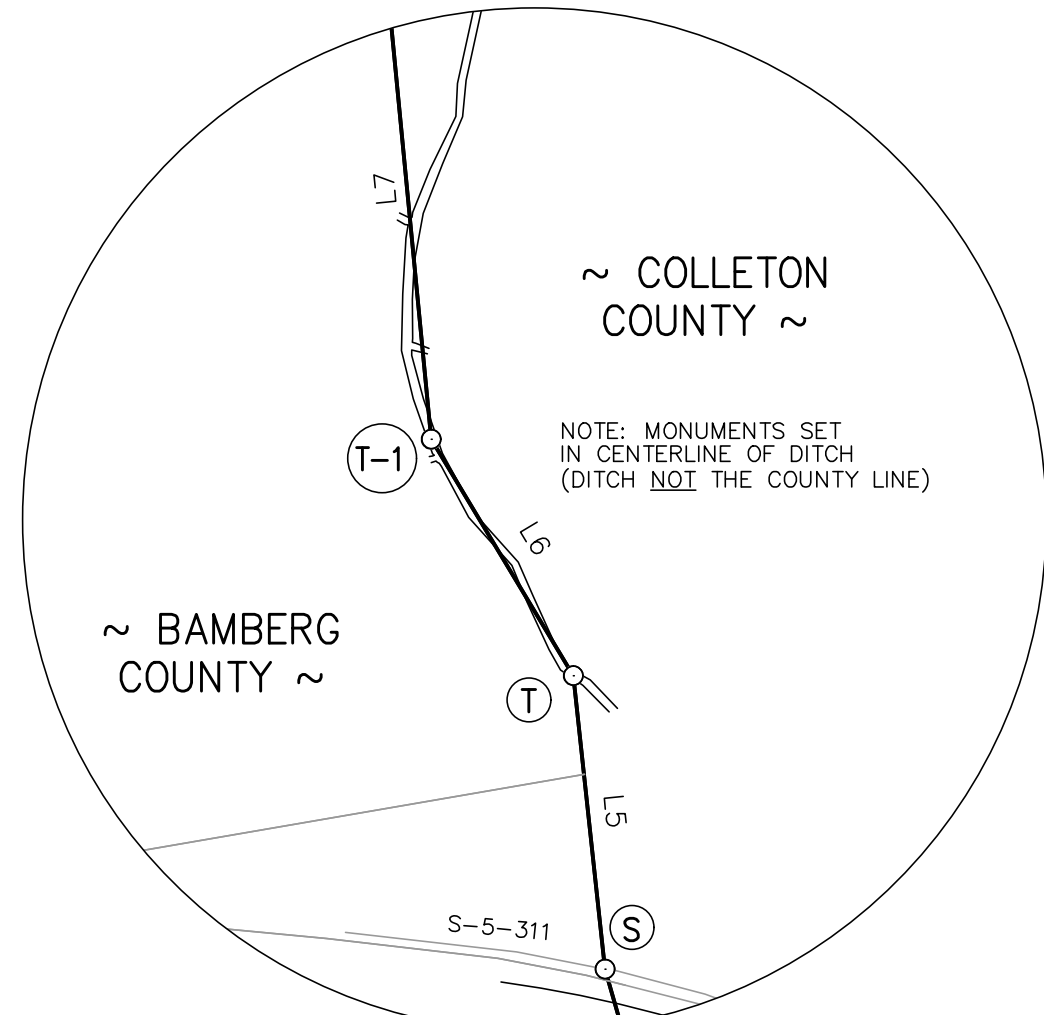

INSET 'C'
(1"=200')

I HEREBY STATE THAT TO THE BEST OF MY PROFESSIONAL KNOWLEDGE, INFORMATION, AND BELIEF, THE SURVEY SHOWN HEREON WAS MADE IN ACCORDANCE WITH THE REQUIREMENTS OF THE "STANDARDS OF PRACTICE MANUAL FOR SURVEYING IN SOUTH CAROLINA," AND MEETS OR EXCEEDS THE REQUIREMENTS FOR A CLASS "A" SURVEY AS SPECIFIED THEREIN.

NOT VALID UNLESS SIGNED IN RED INK

CORNERSTONE SURVEYING & ENGINEERING, INC.
C.O.A.

REVIEW ONLY
STAMP

EMBOSSSED SEAL

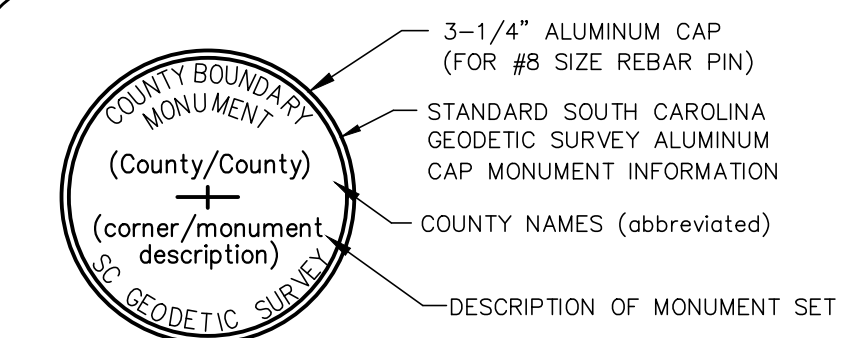
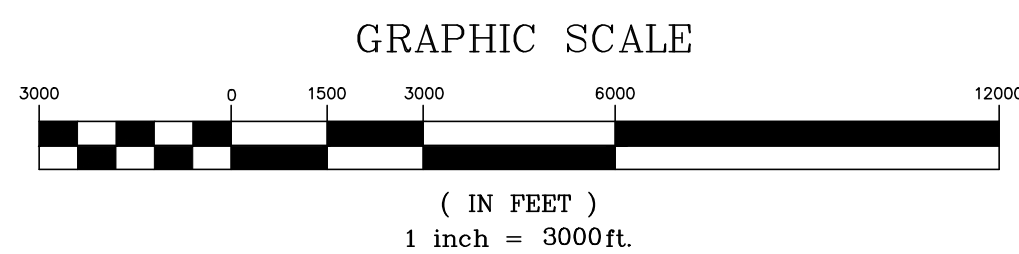

SURVEY MARKER CAP DETAIL
(N.T.S.)

This is not a valid, true copy of this document unless bearing on the embossed seal of the surveyor or engineer.
Copyright © 2025, CORNERSTONE SURVEYING & ENGINEERING, INC. All rights reserved. Reproduction or use of this document, in whole or in part, without permission is prohibited.
Print No. _____
Date: _____

CORNERSTONE SURVEYING & ENGINEERING, INC.
1240 Bacon's Bridge Rd. • Summerville • South Carolina • 29485 • Phone: 843-871-9706

A PLAT OF A PORTION OF THE BAMBERG-COLETON COUNTY LINE
BEGINNING AT THE INTERSECTION OF THE "SALKAHATCHIE RIVER" (i.e., the "Big Salkahatchie River") AND THE SOUTHERN END OF THE BAMBERG-COLETON COUNTY LINE, WHICH IS A PORTION OF THE "OLD DISTRICT LINE" AS ESTABLISHED EARLY IN THE HISTORY OF SOUTH CAROLINA, BEING SPECIFICALLY DEFINED AS "THE OLD DISTRICT LINE" RUNNING FROM "MATTHEWS BLUFF" ON THE SAVANNAH RIVER TO "NELSON'S FERRY" ON THE OLD SANTEE RIVER, WHICH IS ALSO BOUND BY THE "OLD DISTRICT LINE" AND BOUND BY THE AGREEMENTS SIGNED BY THE BAMBORG-COLETON COUNTY LINE BOUNDARY ALONG THE "OLD DISTRICT LINE" TOWARDS THE INTERSECTION OF THE BAMBERG-COLETON COUNTY LINE WITH THE EDISTO RIVER, INCORPORATING INTO THE INTERSECTION OF THE BAMBERG-COLETON COUNTY LINE BOUNDARY THE EASTERN ANNEXATION AREA NORTH OF AND INCLUDING PART OF THE "LITTLE EDISTO RIVER" SAID COUNTIES LYING TO THE SOUTHWEST OF DORCHESTER COUNTY AND ORANBERG COUNTY WHICH ARE ALSO BISECTED BY THE "OLD DISTRICT LINE," AND HAVING THE COMMON CORNER AT THIS INTERSECTION WITH THE NORTH END OF THE LINE BETWEEN BAMBERG COUNTY AND COLLETON COUNTY, SOUTH CAROLINA

Date of Survey: 5/1/2025

Drawn: AWK
Design: AWK
Checked: KAW
Approved: RDB & KAW
CAD File: 24020 COLL-BAMB.dwg
F.B. & Pg. N/A
P.B. & Pg. N/A
Pl. Board Appl. # N/A

Date	Revision No.

Proj. No.: 24020
Sheet 2 of 2