

PLAT

PREPARED FOR

J. B. WEEKS & DALE DICKERSON

LOCATED AT

WEST OF DENMARK ON S.C. HWY. # 70
BAMBERG COUNTY
SOUTH CAROLINA

0008-00-00-022

PB 15-182 # 6

SCALE: 1" = 500'

DATE: 12-28-78

PREPARED BY

J. J. FOY, R.L.S. NO. 3778
BARNWELL, S. C.

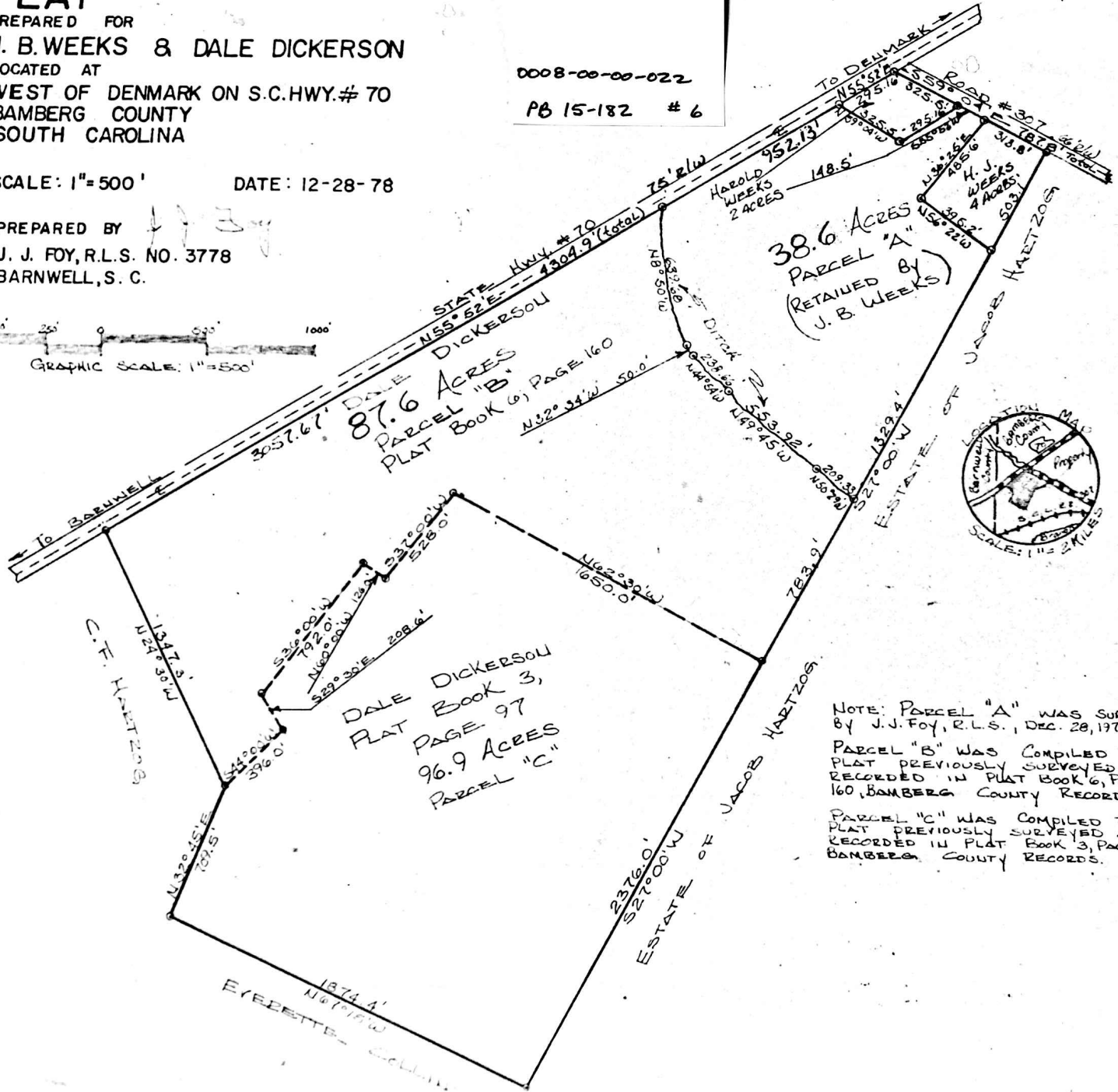
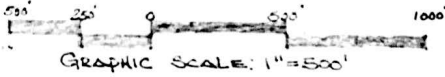

NOTE: PARCEL "A" WAS SURVEYED
BY J. J. FOY, R.L.S., DEC. 28, 1978.

PARCEL "B" WAS COMPILED FROM
PLAT PREVIOUSLY SURVEYED AND
RECORDED IN PLAT BOOK 6, PAGE
160, BAMBERG COUNTY RECORDS.

PARCEL "C" WAS COMPILED FROM
PLAT PREVIOUSLY SURVEYED AND
RECORDED IN PLAT BOOK 3, PAGE 97,
BAMBERG COUNTY RECORDS.

Recorded January 23, 1979 at 4:30 PM