

- LEGEND:**
- CMF - CONCRETE FOUND
  - CMS - CONCRETE SET
  - RBS - 3/4" REBAR SET
  - RSB - REBAR FOUND
  - RF - IRON PIPE FOUND
  - TP - TELEPHONE PULSTAL
  - OH - OVERHEAD POWER
  - N/S - NOT TO SCALE
  - R/W - RIGHT OF WAY
  - TM - TAX MAP
  - PS - PLAT BOOK
  - DB - DEED BOOK
  - POB - POINT OF BEGINNING
  - SPOT ELEVATION
  - CONTROLLING POINT
  - CP - POWER POLE

**PLAT OF WETLAND RESERVE EASEMENT  
NO. 66-4639-4-022 ON LANDS OF  
JERRY CONE PREPARED FOR  
USDA-NATURAL RESOURCE CONSERVATION SERVICE**

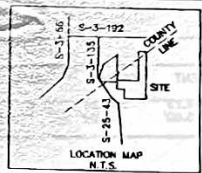

**LEGAL DESCRIPTION:**  
ALL THAT CERTAIN PIECE, PARCEL OR TRACT OF LAND LYING AND BEING IN HAMPTON AND ALLENDALE COUNTIES, STATE OF SOUTH CAROLINA, BEING ALONG ROAD S-25-43 AND S-3-135 AND BEING MORE FULLY DESCRIBED AS FOLLOWS:  
BEGINNING AT A REBAR SET ALONG ROAD S-25-43 BEING AT LATITUDE 33°07'47" AND LONGITUDE 81°07'20"; THENCE S44°34'20"E FOR A DISTANCE OF 19.41' TO A POINT; THENCE AROUND A CURVE WITH A LENGTH OF 478.33', A RADIUS OF 1948.40' AND A CHORD OF N17°34'47"W 477.13' ALONG ROAD S-25-43 TO A POINT;  
THENCE N04°22'18"E FOR A DISTANCE OF 16.69' TO A POINT;  
THENCE N00°16'41"W FOR A DISTANCE OF 271.69' TO A POINT;  
THENCE N34°32'15"E FOR A DISTANCE OF 764.38' TO A POINT;  
THENCE S44°34'20"E FOR A DISTANCE OF 18.99' TO A POINT;  
THENCE N80°10'11"E FOR A DISTANCE OF 19.41' TO A POINT;  
THENCE S31°36'07"E FOR A DISTANCE OF 25.64' TO A POINT;  
THENCE S27°06'57"E FOR A DISTANCE OF 33.29' TO A POINT;  
THENCE S89°29'54"E FOR A DISTANCE OF 30.09' TO A POINT;  
THENCE S82°16'28"E FOR A DISTANCE OF 34.01' TO A POINT;  
THENCE S77°02'27"W FOR A DISTANCE OF 87.22' TO A POINT;  
THENCE S53°26'50"E FOR A DISTANCE OF 87.22' TO A POINT;  
THENCE S61°49'37"E FOR A DISTANCE OF 48.73' TO A POINT;  
THENCE S24°50'56"E FOR A DISTANCE OF 38.71' TO A POINT;  
THENCE S82°16'28"E FOR A DISTANCE OF 34.08' TO A POINT;  
THENCE N71°25'01"E FOR A DISTANCE OF 50.01' TO A POINT;  
THENCE S80°09'54"E FOR A DISTANCE OF 36.43' TO A POINT;  
THENCE N71°35'25"E FOR A DISTANCE OF 87.88' TO A POINT;  
THENCE S80°10'11"E FOR A DISTANCE OF 83.08' TO A POINT;  
THENCE S62°38'05"E FOR A DISTANCE OF 86.42' TO A POINT;  
THENCE N89°29'54"E FOR A DISTANCE OF 84.65' TO A POINT;  
THENCE S19°53'08"E FOR A DISTANCE OF 77.88' TO A POINT;  
THENCE S89°22'28"E FOR A DISTANCE OF 96.85' TO A POINT;  
THENCE S52°28'20"E FOR A DISTANCE OF 127.82' TO A POINT;  
THENCE S58°30'47"E FOR A DISTANCE OF 172.54' TO A POINT;  
THENCE N45°07'02"W FOR A DISTANCE OF 58.02' TO A POINT;  
THENCE N47°23'36"E FOR A DISTANCE OF 35.17' TO A POINT;  
THENCE N62°06'59"E FOR A DISTANCE OF 70.78' TO A POINT;  
THENCE N79°35'02"E FOR A DISTANCE OF 31.66' TO A POINT;  
THENCE S58°24'34"E FOR A DISTANCE OF 82.77' TO A POINT;  
THENCE N81°27'33"E FOR A DISTANCE OF 91.77' TO A POINT;  
THENCE S69°31'44"E FOR A DISTANCE OF 83.71' TO A POINT;  
THENCE S45°03'55"E FOR A DISTANCE OF 76.09' TO A POINT;  
THENCE N89°29'54"E FOR A DISTANCE OF 12.00' TO A POINT;  
THENCE S03°08'01"E FOR A DISTANCE OF 19.05' TO A 6"X6" CONCRETE MONUMENT FOUND;  
THENCE S03°08'01"E FOR A DISTANCE OF 1049.30' TO A POINT;  
THENCE S03°08'01"E FOR A DISTANCE OF 306.34' TO A REBAR SET;  
THENCE N89°09'38"W FOR A DISTANCE OF 1781.15' TO A POINT, SAID POINT BEING THE POINT OF BEGINNING.  
SAID PARCEL MEASURES AND CONTAINS 64.99 ACRES MORE OR LESS AND IS THE SAME PARCEL A AS SHOWN HEREON.

**LEGAL DESCRIPTION:**  
PARCEL B  
ALL THAT CERTAIN PIECE, PARCEL OR TRACT OF LAND LYING AND BEING IN HAMPTON AND ALLENDALE COUNTIES, STATE OF SOUTH CAROLINA, BEING MORE FULLY DESCRIBED AS FOLLOWS:  
BEGINNING AT A REBAR SET BEING SOUTH OF THE ALLENDALE COUNTY LINE ALONG ROAD S-25-43;  
THENCE N84°21'22"E ALONG A 25.00' ACCESS EASEMENT THROUGH THE LANDS OF NOW OR FORMERLY HERRINGTON FOR A DISTANCE OF 1704.80' TO A POINT ON LINE;  
THENCE N04°46'09"W FOR A DISTANCE OF 673.06' TO AN AXLE FOUND;  
THENCE S88°57'05"E FOR A DISTANCE OF 1181.47' TO A 1" IRON PIPE FOUND;  
THENCE N03°06'11"W FOR A DISTANCE OF 156.59' TO A 3/4" IRON PIPE FOUND;  
THENCE N03°06'11"W FOR A DISTANCE OF 16.21' TO A POINT;  
THENCE N78°02'32"W FOR A DISTANCE OF 31.01' TO A POINT;  
THENCE S75°07'08"E FOR A DISTANCE OF 51.48' TO A POINT;  
THENCE N05°46'52"W FOR A DISTANCE OF 69.82' TO A POINT;  
THENCE N84°29'28"E FOR A DISTANCE OF 156.24' TO A POINT;  
THENCE S30°33'54"E FOR A DISTANCE OF 55.60' TO A POINT;  
THENCE N82°37'48"E FOR A DISTANCE OF 4.98' TO A POINT;  
THENCE N81°27'15"E FOR A DISTANCE OF 78.87' TO A POINT;  
THENCE N02°33'41"E FOR A DISTANCE OF 28.59' TO A POINT;  
THENCE N78°09'38"E FOR A DISTANCE OF 78.87' TO A POINT;  
THENCE N83°00'40"E FOR A DISTANCE OF 85.56' TO A POINT;  
THENCE S03°07'13"E FOR A DISTANCE OF 1703.80' TO A 5"X5" CONCRETE MONUMENT FOUND;  
THENCE S03°07'13"E FOR A DISTANCE OF 878.99' TO A POINT;  
THENCE N81°05'40"W FOR A DISTANCE OF 202.63' TO A 3/4" IRON PIPE FOUND;  
THENCE N88°35'40"W FOR A DISTANCE OF 177.57' TO A 4"X4" CONCRETE MONUMENT FOUND;  
THENCE S84°21'22"W ALONG A 25.00' ACCESS EASEMENT FOR A DISTANCE OF 1704.80' TO A 3/4" IRON PIPE FOUND BEING ALONG ROAD S-25-43;  
THENCE N05°36'38"W ALONG ROAD S-25-43 FOR A DISTANCE OF 25.00' TO A REBAR SET; SAID POINT BEING THE POINT OF BEGINNING.  
SAID PARCEL MEASURES AND CONTAINS 51.34 ACRES MORE OR LESS AND IS THE SAME PARCEL B AS SHOWN HEREON.

LINE	LENGTH	BEARING
L1	16.66	S44°34'20"E
L2	18.41	N04°22'18"E
L3	25.64	S31°36'07"E
L4	33.29	S27°06'57"E
L5	30.09	S89°29'54"E
L6	34.01	S82°16'28"E
L7	87.22	S77°02'27"W
L8	48.73	S61°49'37"E
L9	38.71	S24°50'56"E
L10	34.08	S82°16'28"E
L11	50.01	N71°25'01"E
L12	36.43	S80°09'54"E
L13	87.88	S80°10'11"E
L14	83.08	S62°38'05"E
L15	84.65	N89°29'54"E
L16	77.88	N71°35'25"E
L17	83.08	S80°10'11"E
L18	86.42	S62°38'05"E
L19	84.65	N89°29'54"E
L20	127.82	S52°28'20"E
L21	172.54	S58°30'47"E
L22	58.02	N45°07'02"W
L23	35.17	N47°23'36"E
L24	70.78	N62°06'59"E
L25	31.66	N79°35'02"E
L26	62.77	N81°27'33"E
L27	91.77	N69°31'44"E
L28	83.71	S45°03'55"E
L29	76.09	N89°29'54"E
L30	12.00	S03°08'01"E
L31	76.08	N89°09'38"W
L32	12.83	N89°29'54"E
L33	16.05	S03°08'01"E
L34	30.91	N63°08'11"W
L35	30.91	N79°35'02"E
L36	91.48	S75°07'08"E
L37	68.82	N02°33'41"E
L38	156.24	N05°46'52"W
L39	81.88	S30°33'54"E
L40	55.60	N82°37'48"E
L41	4.98	N81°27'15"E
L42	78.87	N02°33'41"E
L43	76.07	N78°09'38"E
L44	85.56	N83°00'40"E
L45	112.82	S03°07'13"E

POINT	LATITUDE	LONGITUDE	DESCRIPTION
1000	33°07'47"	-81°07'20"	POINT
1001	33°07'28"	-81°07'23"	POINT
1002	33°07'28"	-81°07'23"	POINT
1003	33°07'32"	-81°07'23"	POINT
1004	33°07'32"	-81°07'23"	POINT
1005	33°07'32"	-81°07'23"	POINT
1006	33°07'41"	-81°07'23"	POINT
1007	33°07'41"	-81°07'23"	POINT
1008	33°07'41"	-81°07'23"	POINT
1009	33°07'41"	-81°07'23"	POINT
1010	33°07'41"	-81°07'23"	POINT
1011	33°07'41"	-81°07'23"	POINT
1012	33°07'41"	-81°07'23"	POINT
1013	33°07'41"	-81°07'23"	POINT
1014	33°07'41"	-81°07'23"	POINT
1015	33°07'41"	-81°07'23"	POINT
1016	33°07'41"	-81°07'23"	POINT
1017	33°07'41"	-81°07'23"	POINT
1018	33°07'41"	-81°07'23"	POINT
1019	33°07'41"	-81°07'23"	POINT
1020	33°07'41"	-81°07'23"	POINT
1021	33°07'41"	-81°07'23"	POINT
1022	33°07'41"	-81°07'23"	POINT
1023	33°07'41"	-81°07'23"	POINT
1024	33°07'41"	-81°07'23"	POINT
1025	33°07'41"	-81°07'23"	POINT
1026	33°07'41"	-81°07'23"	POINT
1027	33°07'41"	-81°07'23"	POINT
1028	33°07'41"	-81°07'23"	POINT
1029	33°07'41"	-81°07'23"	POINT
1030	33°07'41"	-81°07'23"	POINT
1031	33°07'41"	-81°07'23"	POINT
1032	33°07'41"	-81°07'23"	POINT
1033	33°07'41"	-81°07'23"	POINT
1034	33°07'41"	-81°07'23"	POINT
1035	33°07'41"	-81°07'23"	POINT
1036	33°07'41"	-81°07'23"	POINT
1037	33°07'41"	-81°07'23"	POINT
1038	33°07'41"	-81°07'23"	POINT
1039	33°07'41"	-81°07'23"	POINT
1040	33°07'41"	-81°07'23"	POINT
1041	33°07'41"	-81°07'23"	POINT
1042	33°07'41"	-81°07'23"	POINT
1043	33°07'41"	-81°07'23"	POINT
1044	33°07'41"	-81°07'23"	POINT
1045	33°07'41"	-81°07'23"	POINT
1046	33°07'41"	-81°07'23"	POINT
1047	33°07'41"	-81°07'23"	POINT
1048	33°07'41"	-81°07'23"	POINT
1049	33°07'41"	-81°07'23"	POINT
1050	33°07'41"	-81°07'23"	POINT
1051	33°07'41"	-81°07'23"	POINT
1052	33°07'41"	-81°07'23"	POINT
1053	33°07'41"	-81°07'23"	POINT
1054	33°07'41"	-81°07'23"	POINT
1055	33°07'41"	-81°07'23"	POINT
1056	33°07'41"	-81°07'23"	POINT
1057	33°07'41"	-81°07'23"	POINT
1058	33°07'41"	-81°07'23"	POINT

I HEREBY STATE TO THE BEST OF MY KNOWLEDGE, INFORMATION & BELIEF, THE SURVEY SHOWN HEREON WAS MADE IN ACCORDANCE WITH THE REQUIREMENTS OF THE MINIMUM STANDARDS MANUAL FOR THE PRACTICE OF LAND SURVEYING IN SOUTH CAROLINA, AND MEETS OR EXCEEDS THE REQUIREMENTS FOR A CLASS A SURVEY AS SPECIFIED THEREIN. ALSO THERE ARE NO USUABLE ENCROACHMENTS OR PROJECTIONS OTHER THAN SHOWN.

THOMAS G. STANTON, JR., PLS # 10290



- HAMPTON COUNTY REFERENCE:**
1. PLAT BOOK 14 PAGE 39
  2. PLAT BOOK 19 PAGE 459
  3. PLAT BOOK 12 PAGE 195
  4. PLAT BOOK 10 PAGE 106
  5. PLAT BOOK 15 PAGE 34
  6. PLAT BOOK 15 PAGE 123
  7. PLAT BOOK 8 PAGE 89
  8. PLAT CAS A-68-101

- ALLENDALE COUNTY REFERENCE:**
1. PLAT BOOK 14 PAGE 39
  2. DEED BOOK 59 PAGE 569
  3. PLAT BOOK 7 PAGE 179
  4. PLAT BOOK 1 PAGE 112
  5. PLAT BOOK 10 PAGE 5
  6. PLAT BOOK 10 PAGE 106
  7. PLAT BOOK 19 PAGE 175

State of South Carolina, County of Allendale  
I hereby certify that the instrument was indexed and recorded this 2<sup>nd</sup> day of Feb. 2006 at 3:31 P.M. in Plat Book 21 Page 189

Mary Ann Carlson  
County Clerk

JOB # 04226W  
DATE: JANUARY 4, 2005

**TGS LAND SURVEYING**  
701 SECOND AVENUE  
P.O. BOX 2023  
RIDGECREEK, S.C. 29129