

1-180
NC STATE Engineering
~~GREEN~~
~~POWER LINE~~
~~WOOD SAW~~

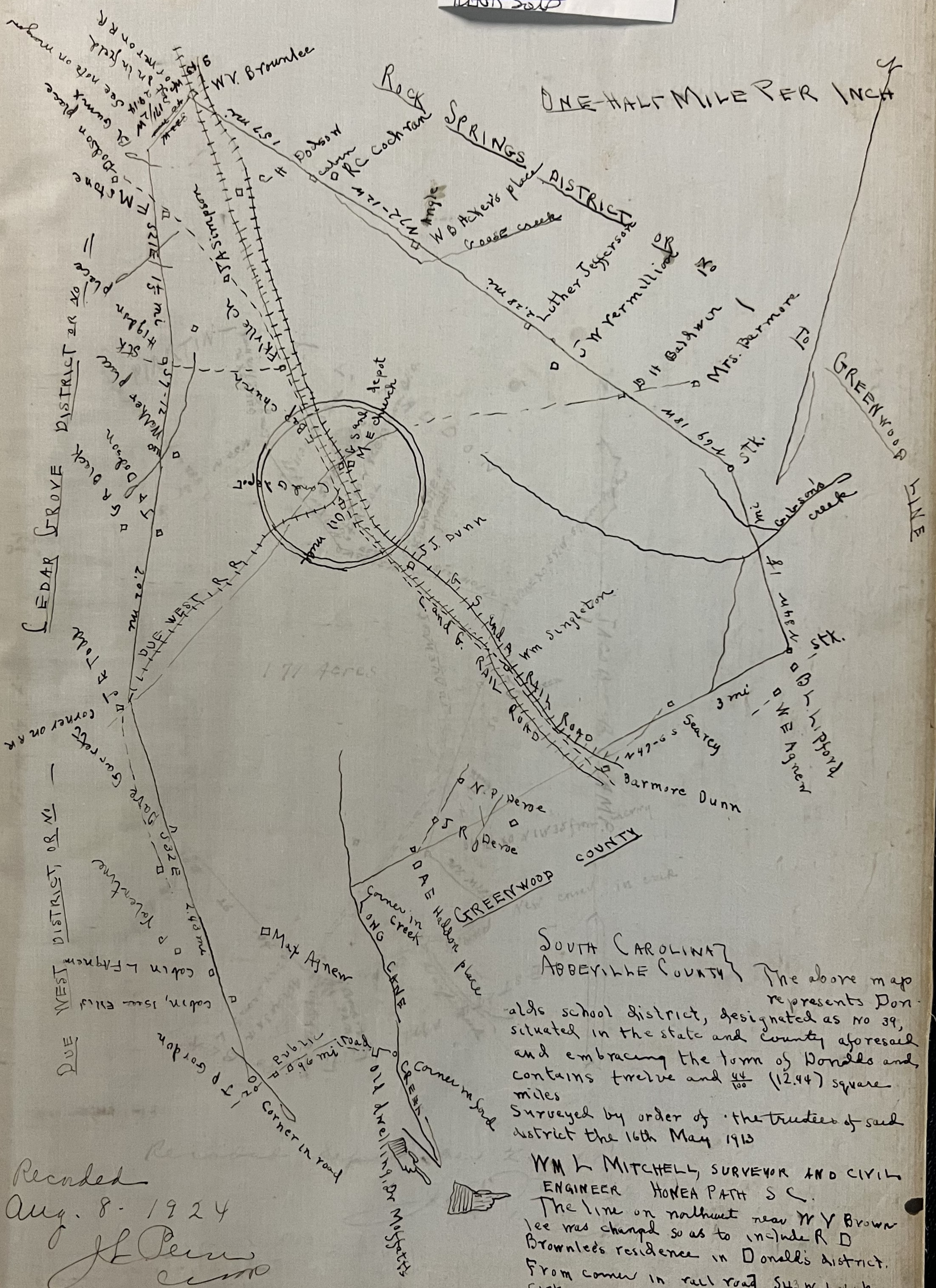

SOUTH CAROLINA
 ABBEVILLE COUNTY

The above map represents Don-alds school district, designated as No 39, situated in the state and county aforesaid and embracing the town of Donalds and contains twelve and $\frac{44}{100}$ (12.44) square miles
 Surveyed by order of the trustees of said district the 16th May 1913

WM L MITCHELL, SURVEYOR AND CIVIL ENGINEER HONEA PATH S C.
 The line on northwest near W.V. Brumlee was changed so as to include R D Brownlee's residence in Donalds district. From corner in rail road 543 W 600 chs. S 17 1/2 W 2914 chs. Back Gum to NE of branch Wm L Mitchell, Reg Surveyor Aug 7-1924

Recorded
 Aug. 8 - 1924
 J. L. [Signature]