

Mrs A.P. Goette

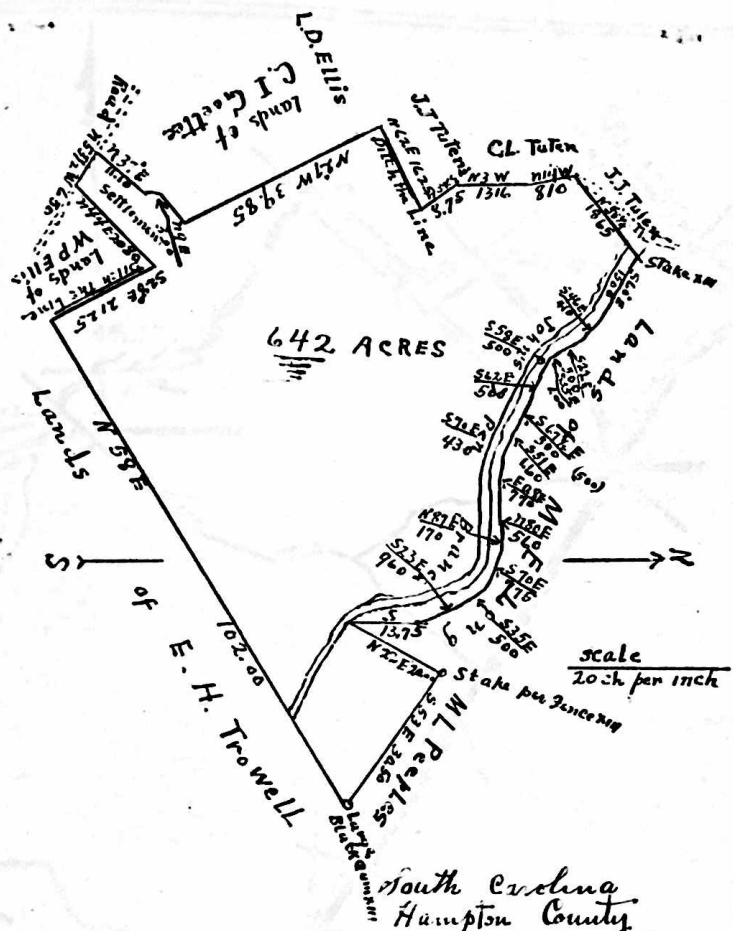

2-094



South Excluding
 Hampton County
 The above Plat represents
 Six Hundred and Forty Two (642)
 acres of Land The property of
 Mrs A.P. Goette
 Surveyed this 14th day of January 1924
 Albert S. Ramsay
 Surveyor

Recorded Jan 22. 1924
 E.M. Ruppel
 W. H. H. to Hugh H. Thomas cecp